



Distributor of Molex Connector Corporation: Excellent Integrated System Limited
Datasheet of 0357254610 - Connector Quick Connect Receptacle 14-18 AWG 0.250"
(6.35mm) Crimp

Contact us: sales@integrated-circuit.com Website: www.integrated-circuit.com

Excellent Integrated System Limited

Stocking Distributor

Click to view price, real time Inventory, Delivery & Lifecycle Information:

[Molex Connector Corporation](#)
[0357254610](#)

For any questions, you can email us directly:
sales@integrated-circuit.com

Contact us: sales@integrated-circuit.com Website: www.integrated-circuit.com

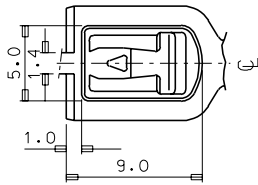
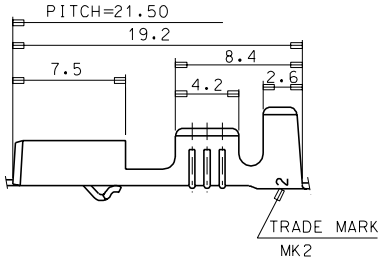
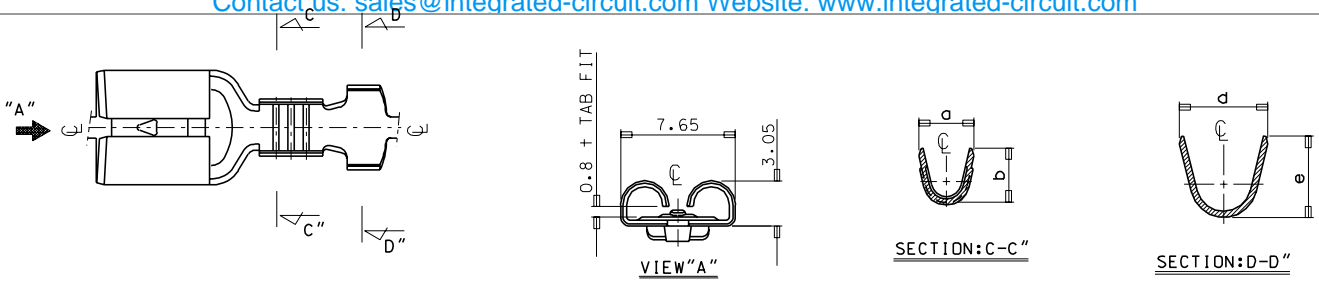

ENG.NO.	a	b	d	e	WIRE RANGE	INS.DIA.	O'TY/REEL
35725-4510	2.7	3.0	4.6	4.4	AWG #22-#18	1.5-3.0	5,000
35725-4610	3.7	3.6	5.8	5.8	AWG #18-#14	2.2-3.6	5,000
35725-4710	5.9	5.2	7.5	6.2	AWG #14-#10	2.8-5.0	4,000

NOTES

- MATERIAL: BRASS 0.40 THICKNESS
- FINISH: PRE-TIN PLATING
- MATING TAB THICKNESS: 0.8
- RECOMMENDED LENGTH OF WIRE STRIP IS 5.5-6.0

DO NOT SCALE DRAWING DIMENSION IN METRIC

REVISION RECORD		ECN	DR	CHK	DATE	DIE FEED	APPL FEED	WBDW	IBDW	APP'D BY	SCALE	WIRE RANGE	GENERAL TOLERANCES	MOLEX MOLEX-KOREA CO.,LTD.	
B	REVISED	94-066			94.12.8							AWG:	DIM. ±0.30	REVISE ONLY ON CAD SYSTEM	
A	NEW RELEASED	94-003			94.5.13							MM²:	ANGLE :	TITLE: .250 SAFE LOCK RECEPTACLE 1 of 1	
LTR		REVISION RECORD	ECN	DR	CHK	DATE	DIE FEED	APPL FEED	WBDW	IBDW	APP'D BY	SCALE	INSULATION RANGE	ENG.NO.	REV B
						21.5	21.5				W. Y. YANG	4:1		SD35725-4510/4610/4710	

8

7

6

5

4

3

2

MK-9