

Flush-type connector - SACC-DSI-M12MSS-4CON-M16/0,5PE - 1424132

Please be informed that the data shown in this PDF Document is generated from our Online Catalog. Please find the complete data in the user's documentation. Our General Terms of Use for Downloads are valid (<http://download.phoenixcontact.com>)



Sensor/actuator flush-type plug, 4-pos., rear/screw mounting with M16 thread, with 0.5 m PP litz wire, 4 x 1.5 mm²



Key commercial data

Packing unit	1 1
Weight per Piece (excluding packing)	60.0 GRM
Custom tariff number	85366990
Country of origin	Germany

Technical data

Dimensions

Length of cable	0.5 m
-----------------	-------

Ambient conditions

Degree of protection	IP67
----------------------	------

General

Rated current at 40°C	12 A
Rated voltage	630 V
Number of positions	4
Contact resistance	≤ 3 mΩ
Insulation resistance	≥ 100 MΩ
Coding	S power
Standards/regulations	M12 connector
Signal type/category	Universal
Status display	No
Surge voltage category	III
Pollution degree	3

Flush-type connector - SACC-DSI-M12MSS-4CON-M16/0,5PE - 1424132

Technical data

General

Connection method	Individual wires
Torque	(M12 connector)
Mounting type	Rear mounting M16 x 1.5 With flat nut

Material

Contact material	CuZn
Contact surface material	Au
Contact carrier material	PA6
Material, knurls	CuZn alloy, nickel-plated
Sealing material	FKM

Cable

Cable type	PP litz wire
Conductor cross section	1.5 mm ²
AWG signal line	16
Wire colors	Black numbered, black numbered, black numbered, green-yellow
Conductor material	Bare Cu litz wires

Classifications

eCl@ss

eCl@ss 4.0	27140815
eCl@ss 4.1	27140815
eCl@ss 5.0	27143423
eCl@ss 5.1	27143423
eCl@ss 6.0	27143423
eCl@ss 7.0	27449001
eCl@ss 8.0	27449001

ETIM

ETIM 3.0	EC002061
ETIM 4.0	EC002062
ETIM 5.0	EC002062

UNSPSC

UNSPSC 6.01	31251501
UNSPSC 7.0901	31251501
UNSPSC 11	31251501
UNSPSC 12.01	31251501

Flush-type connector - SACC-DSI-M12MSS-4CON-M16/0,5PE - 1424132

Classifications

UNSPSC

UNSPSC 13.2	31251501
-------------	----------

Drawings

Schematic diagram



Connector pin assignment of M12 plug, 4-pos., S-coded, view of pin side

Dimensioned drawing

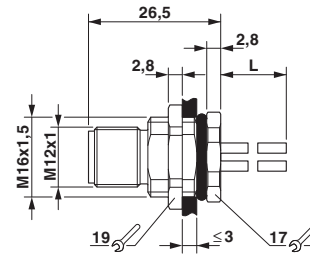

M12 flush-type plug

Circuit diagram

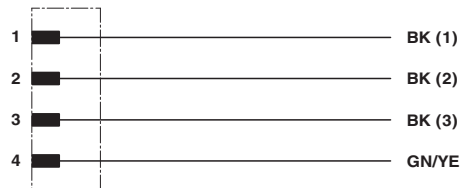

Contact assignment of the M12 socket