

## **Excellent Integrated System Limited**

Stocking Distributor

Click to view price, real time Inventory, Delivery & Lifecycle Information:

[Hammond Manufacturing](#)  
[1457J1601](#)

For any questions, you can email us directly:

[sales@integrated-circuit.com](mailto:sales@integrated-circuit.com)

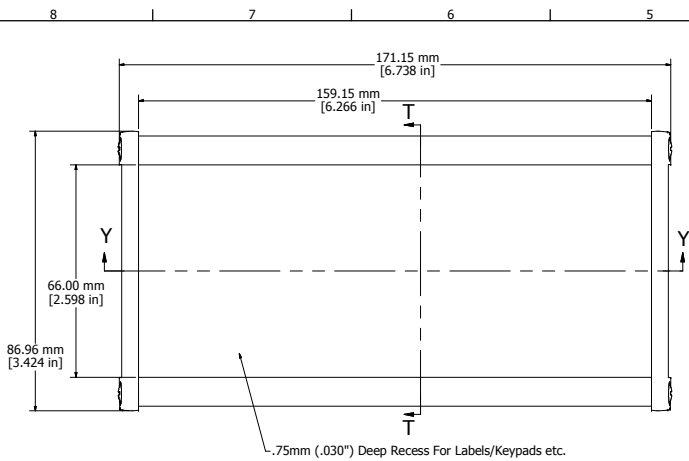

ASSEMBLY - VIEW FROM TOP

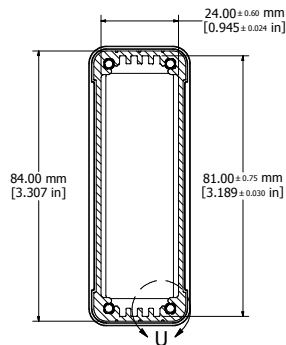

SECTION T-T

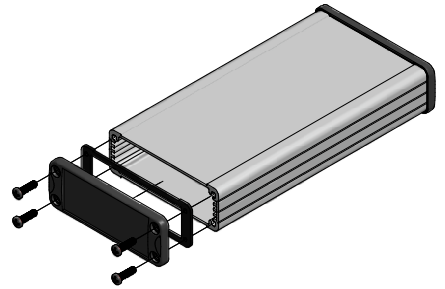

**PROTECTION TO IP 65**

Enclosures can be Factory Modified (Milling, Drilling, Printing etc.)  
Contact Factory [mjm@hammondmfg.com](mailto:mjm@hammondmfg.com) for quotes  
Solid models of this enclosure available in STEP or IGES.

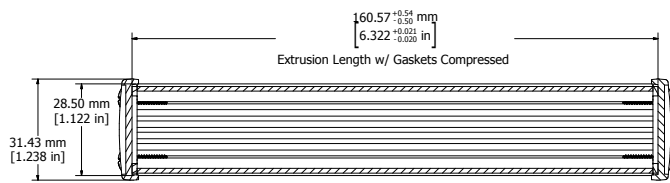

SECTION Y-Y

Fits 160mm (6.299") X 80mm (3.149") PCB

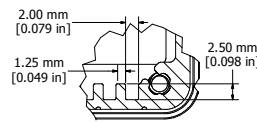

DETAIL U

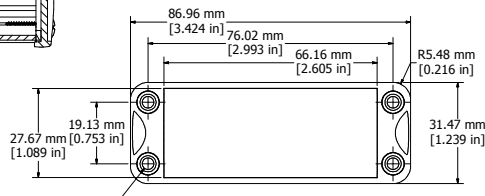

END PANEL - VIEW FROM OUTSIDE

NOTE	
Purchased assembly includes box, end panels, #6 Taptight screws w/ O-rings, self adhesive rubber feet, and gaskets	
Box made from Extruded Aluminum 6063.	
End panels made from ADC-12 Diecast Aluminum with a black powder paint finish.	
WATERPROOF 1457J1601	
PART NUMBERS	
Clear anodized box with black powder painted end panels	1457J1601
Black powder painted box and end panels	1457J1601BK
EMI/RFI SHIELDED (IP 54)	
Clear anodized box with black powder painted end panels	1457J1601E
Black powder painted box and end panels	1457J1601EBK
ACCESSORIES	
See website for accessories.	

**HAMMOND MANUFACTURING™**  
**1457J1601**  
www.hammondmfg.com