

Excellent Integrated System Limited

Stocking Distributor

Click to view price, real time Inventory, Delivery & Lifecycle Information:

[Panduit](#)
[ICF5EI-E](#)

For any questions, you can email us directly:
sales@integrated-circuit.com

THIS COPY IS PROVIDED ON A RESTRICTED BASIS AND IS NOT TO BE USED IN ANY WAY DETRIMENTAL TO THE INTERESTS OF PANDUIT CORP.

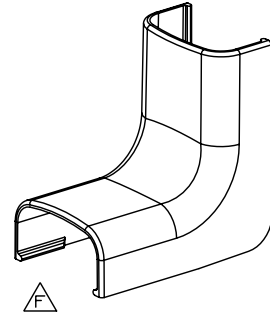
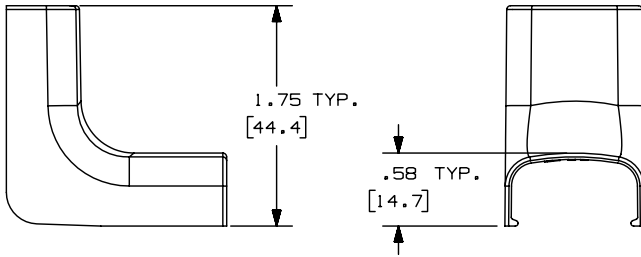
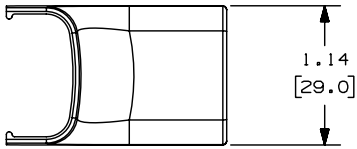

B	PANDUIT P/N	WEIGHT
C	ICF5	0.97 LB/100 PCS. (440g/100 PCS.)

NOTES:

1. SEE CURRENT CATALOG FOR ADDITIONAL PART NUMBER SUFFIXES TO INDICATE COLOR AND OR PACKAGE QUANTITY.
2. DIMENSIONS IN PARENTHESIS ARE IN METRIC.

CAD FILENAME/LAYERS D34474BD_DC_ICF5_01.prt

6	7-3-02	JHN/RMH	F.	REVISED MATERIAL IN DRAWING TITLE BLOCK.	16864	RGRG	RGRG			PANDUIT CORP. TINLEY PARK, ILLINOIS INSIDE CORNER FITTING (ICF5) CUSTOMER DRAWING UNLESS OTHERWISE SPECIFIED, DIMENSIONAL TOLERANCES ARE: (.X) ± (.XXX) ± (.XX) ± (.03(.8) ANGLES ±	UNLESS OTHERWISE SPECIFIED, ALL DIMENSIONS ARE GIVEN IN INCHES, THIRD ANGLE PROJECTION.
5	8-28-00	MSO	HIW	E. REVISED AND REDRAWN ON CAD.	16864	HIW	HIW				
4	10-3-91	DW	CF	D. REVISED NOTE AND REMOVED COLOR FROM DRAWING.	16864		CF				
3	2-28-91	DW	CF	C. REVISED COLORS: OMIT BG, LI, LG. ADDED INT. WHITE AND INT. GRAY.	16864		WJB				
2	12-2-87	LDB	WJB	B. ADDED PART NUMBERS ICF5E1 AND ICF5L1.	16864		WJB				
1	5-14-82	KJS	JK	A. POLYSTYRENE WAS ABS.			JAK				
R	9-14-81	KJS	HP	DRAWING RELEASED			HP		DRAWN BY KJS DATE 9-2-81 CHK'D JK	MAT'L: ABS F SCALE FULL DRAWING NO. SS-16864 DWG SIZE A	
REV	DATE	BY	CHK	DESCRIPTION	ECN	-	R	CUST	SUP		