

Excellent Integrated System Limited

Stocking Distributor

Click to view price, real time Inventory, Delivery & Lifecycle Information:

[Panduit](#)
[JB1DAW-A](#)

For any questions, you can email us directly:
sales@integrated-circuit.com

THIS COPY IS PROVIDED ON A RESTRICTED BASIS AND IS NOT TO BE USED IN ANY WAY DETRIMENTAL TO THE INTERESTS OF PANDUIT CORP.
 NO WARRANTY, EXPRESSED OR IMPLIED, IS MADE BY PANDUIT WITH RESPECT TO ADHESIVE BOND PERFORMANCE. AMONG OTHER THINGS, THE CONDITIONS UNDER WHICH THESE MOUNTS MAY BE APPLIED AND/OR THE SURFACE TO WHICH THEY MAY BE APPLIED ARE BEYOND PANDUIT CONTROL.

LD STYLE BREAKOUTS ON EACH OF THE FOUR SIDE WALLS

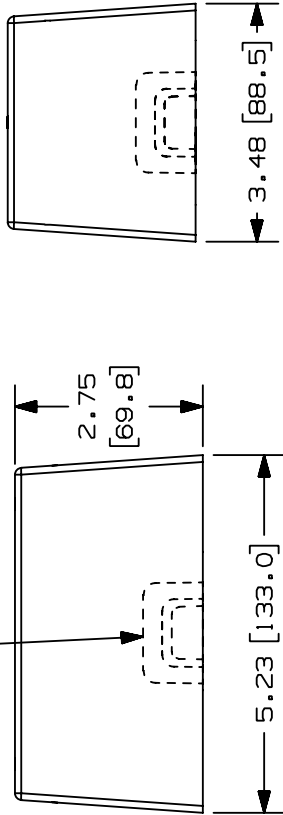

BREAKOUT FOR 3/4" CONDUIT CENTER RECTANGLE BREAKOUT FOR WALL BOX

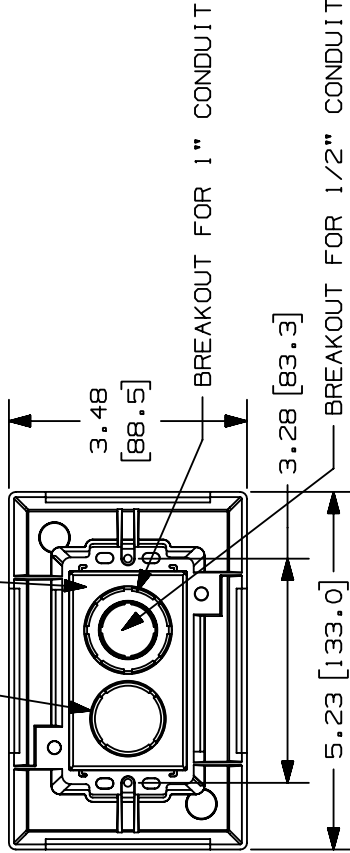

PANDUIT P/N	WEIGHT
JB1D-A	2.5 LB/10 PCS. (1141.6 G/10 PCS.)



- NOTES:
- SEE CURRENT CATALOG FOR ADDITIONAL PART SUFFIXES TO INDICATE COLOR AND OR PACKAGE QUANTITY.
 - ADHESIVE PRESSURE SENSITIVE FOAM .040 (1.0) THICK WITH PROTECTIVE LINER IS PROVIDED FOR EASE OF MOUNTING.
 - DIMENSIONS IN PARENTHESIS ARE IN METRIC.

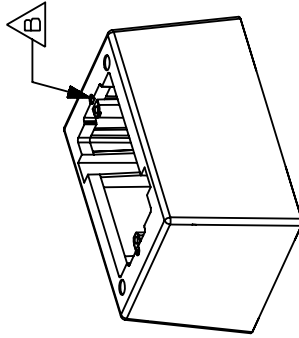

WAS D35541DB_JB1D_C_00.PRT
 D35541DP_DC_JB1D_00.PRT

CAD FILENAME/LAYERS

PANDUIT
 TINLEY PARK, ILLINOIS
 ONE PIECE JUNCTION BOX (JB1D-A)
 (DEEP)
 CUSTOMER DRAWING

UNLESS OTHERWISE SPECIFIED, DIMENSIONAL TOLERANCES ARE:
 (.X) ± .010 (.3)
 (.XX) ± .03 (.8) ANGLES ±

UNLESS OTHERWISE SPECIFIED, ALL DIMENSIONS ARE GIVEN IN INCHES, THIRD ANGLE PROJECTION.

SCALE	NONE
DRAWING NO.	35541-54
DWG SIZE	A

UNLESS OTHERWISE SPECIFIED, DIMENSIONAL TOLERANCES ARE: (.X) ± .010 (.3) (.XX) ± .03 (.8) ANGLES ±	MAT'L:	POLYSTYRENE
DRAWN BY	PM	
DATE	10-15-96	
CHK'D	CEF	
ECN	R	SUP

1	03-11-99	DW	H1W	35541-54	H1W	H1W
R	10-15-96	PM	CEF	35541-54	CEF	CEF
REV	DATE	BY	CHK	DESCRIPTION		

C: MAT'L WAS ABS/POLYCARBONATE, D: CORRECTED BREAKOUTS, A: REV'D PRODUCT WEIGHT, B: REV'D FEATURE WHERE NOTED.

RELEASED TO PRODUCTION