

Excellent Integrated System Limited

Stocking Distributor

Click to view price, real time Inventory, Delivery & Lifecycle Information:

[Molex Connector Corporation](#)
[0853009002](#)

For any questions, you can email us directly:

sales@integrated-circuit.com

7 6 5 4 3 2 1

NOTES:

1. MATERIAL : PBT 30% GF, RAL 7032
2. TERMINAL : BRASS
FINISH : SELECTIVE GOLD (Au) 2 MICRONS
NICKEL 2.5 MICRONS OVERALL
3. *S* DENOTES SPC DIMENSIONS

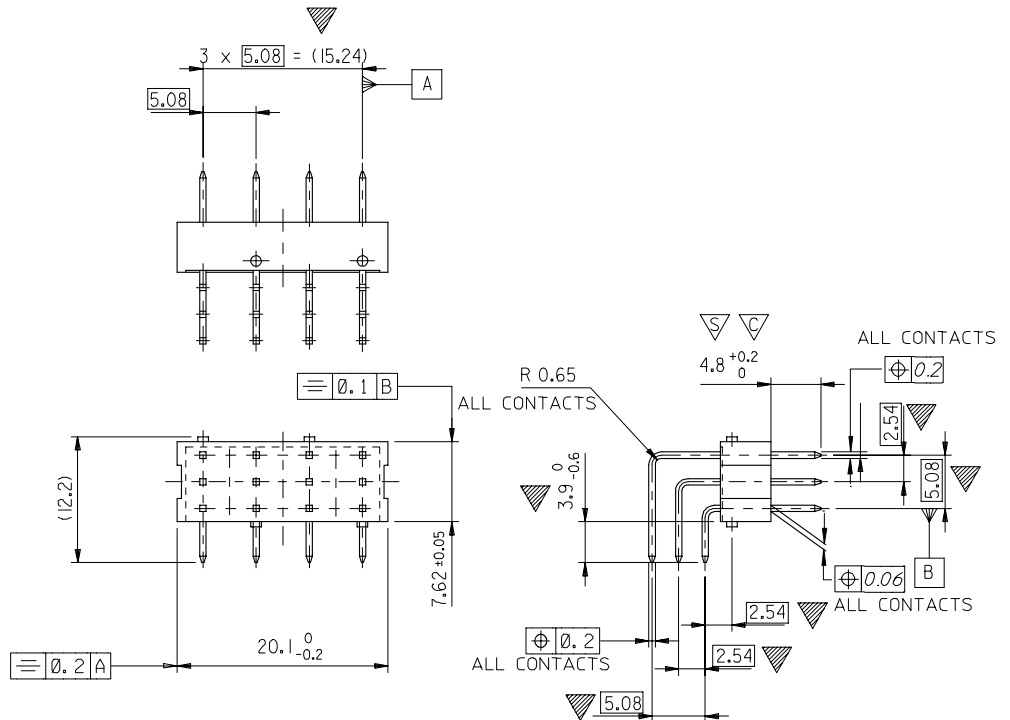

EC NO: I2005-0114 DRWNS: VAKUMA 2004/08/23 CHKD: SSUDHIR 2004/08/27 APPR: SSUDHIR 2004/08/27	QUALITY SYMBOLS ▽=7 ▽=1 ▽=1	GENERAL TOLERANCES (UNLESS SPECIFIED)		DIMENSION STYLE		SCALE	DESIGN UNITS	THIRD ANGLE PROJECTION		
			mm	INCH	MM ONLY		1:1	METRIC		
		4 PLACES	± ---	± ---	DRAWN BY	DATE	TITLE			
		3 PLACES	± ---	± ---	SHIVA	2004/07/15	ASSEMBLY DRAW. MALE CONN. (RPV 304 002)			
	2 PLACES	± 0.1	± ---	CHECKED BY	DATE	MOLEX INCORPORATED MOLEX				
	1 PLACE	± 0.2	± ---	PRASAD	2004/07/15					
	ANGULAR ± 2 °		APPROVED BY		DATE	DOCUMENT NO.		SHEET NO.		
	DRAFT WHERE APPLICABLE MUST REMAIN WITHIN DIMENSIONS		DATHA		2004/07/15	SD-85300-9002		1 OF 2		
			MATERIAL NO.		SEE SHEET 2					
			SIZE		THIS DRAWING CONTAINS INFORMATION THAT IS PROPRIETARY TO MOLEX INCORPORATED AND SHOULD NOT BE USED WITHOUT WRITTEN PERMISSION					

6 5 4 3 2 1

7 6 5 4 3 2 1

View on mating side

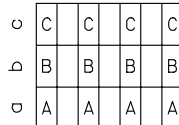

← 3 2 1 4 5 6 7

- A = 4 standard contacts L=3,9
 - B = 4 standard contacts L=3,9
 - C = 4 standard contacts L=3,9
-
- S = 12 total number of contacts

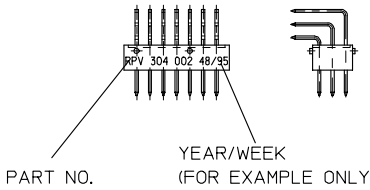

Marking	Customer special
Performance level	Customer special
Flux proof	no
Fixing clip	no
Dimensions	SD-85300-9002 SHT1

C	special	c1,3,5,7
B	special	b1,3,5,7,
A	special	a1,3,5,7
Contact symbol	Perform. level	Contact position number

EC NO: I2005-0114 DRWNS: VAKUMA 2004/08/23 CHKD: SSUDHIR 2004/08/27 APPR: SSUDHIR 2004/08/27 REV:	QUALITY SYMBOLS	GENERAL TOLERANCES (UNLESS SPECIFIED)	DIMENSION STYLE MM ONLY	SCALE ---	DESIGN UNITS METRIC	THIRD ANGLE PROJECTION
	▽=0	4 PLACES ± --- ± ---	mm INCH	DRAWN BY SHIVA DATE 2004/07/15	TITLE 21 POS.MALE CONNECTOR (RPV 304 002) CONTACTS ARRANGEMENT	
	▽=0	3 PLACES ± --- ± ---		CHECKED BY PRASAD DATE 2004/07/15	MOLEX INCORPORATED	
		2 PLACES ± --- ± ---		APPROVED BY DATHA DATE 2004/07/15	MATERIAL NO. 85300-9002	DOCUMENT NO. SD-85300-9002
	1 PLACE ± --- ± ---	ANGULAR ± ---°	DRAFT WHERE APPLICABLE MUST REMAIN WITHIN DIMENSIONS			
THIS DRAWING CONTAINS INFORMATION THAT IS PROPRIETARY TO MOLEX INCORPORATED AND SHOULD NOT BE USED WITHOUT WRITTEN PERMISSION						

6 5 4 3 2 1