

Excellent Integrated System Limited

Stocking Distributor

Click to view price, real time Inventory, Delivery & Lifecycle Information:

[Molex Connector Corporation](#)
[1041210600](#)

For any questions, you can email us directly:

sales@integrated-circuit.com

10 9 8 7 6 5 4 3 2 1

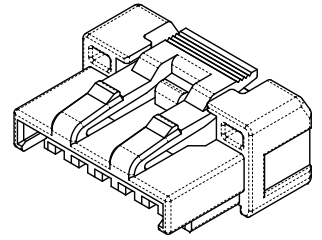
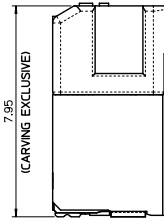
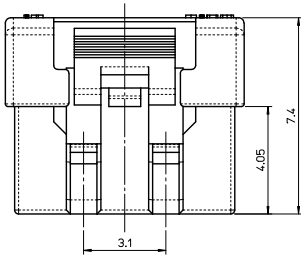

MATED WITH HEADER ASS'Y (REFERENCE)

ISOMETRIC VIEW

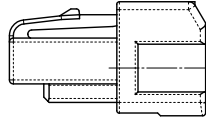
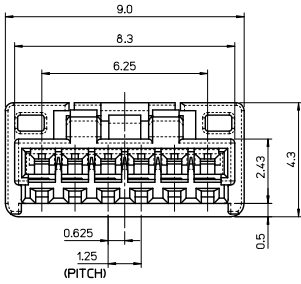

CARVING (TRADE MARK)

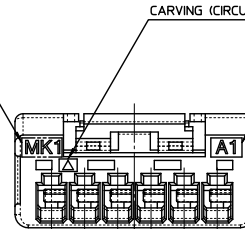

CARVING (CIRCUIT NO.1)

CARVING (CAVITY NO.)

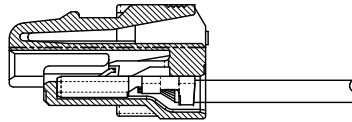

TERMINAL ASSEMBLY (REFERENCE)

NOTE

- MATED WITH : 104122-0617
- MATERIAL : THERMOPLASTIC, HOLOGEN FREE
UL94V-0, COLOR OF NATURAL
- APPLICABLE TERMINAL : 104521-6001

<TABLE>

ORDER NO.		104121-0600	
COLOR		NATURAL	
SCALE 7:1	DESIGN UNITS METRIC	THIRD ANGLE PROJECTION	
1.25 W/B CONN. ST. 6P HOUSING			
		MOLEX INCORPORATED	
MATERIAL NO.		DOCUMENT NO.	SHEET NO.
SEE TABLE		SD-104121-001	1 OF 1

RELEASED EC NO: KOR2011-0122 DRAWN:SKCHO CHKD: APPR:YUNSIKKIM	2011/04/25	2010/10/28	2011/04/29
	DESCRIPTION		
	A		
	REV		

QUALITY SYMBOLS	▽=0	▽=0
	GENERAL TOLERANCES (UNLESS SPECIFIED)	
	4 PLACES ± ---	± ---
	3 PLACES ± ---	± ---
2 PLACES ± 0.15	± ---	
1 PLACE ± 0.25	± ---	
ANGULAR ± 3°		
DRAFT WHERE APPLICABLE MUST REMAIN WITHIN DIMENSIONS		

DIMENSION STYLE MM ONLY	
DRAWN BY	DATE
HTSONG	2010/10/28
CHECKED BY	DATE
SHCHU	2010/10/28
APPROVED BY	DATE
YUNSIKKIM	2011/04/29
MATERIAL NO.	
SEE TABLE	
SIZE	
A3	

THIS DRAWING CONTAINS INFORMATION THAT IS PROPRIETARY TO MOLEX INCORPORATED AND SHOULD NOT BE USED WITHOUT WRITTEN PERMISSION

9 8 7 6 5 4 3 2 1