

## Excellent Integrated System Limited

Stocking Distributor

Click to view price, real time Inventory, Delivery & Lifecycle Information:

[Panduit](#)

[LCC8-14BF-L](#)

For any questions, you can email us directly:

[sales@integrated-circuit.com](mailto:sales@integrated-circuit.com)

THIS COPY IS PROVIDED ON A RESTRICTED BASIS AND IS NOT TO BE USED IN ANY WAY DETRIMENTAL TO THE INTERESTS OF PANDUIT CORP.

|  |  |
|--|--|
| Material                                       | High Conductivity Seamless Copper Tube   |
| Plating  | Electro-Tin  |
| Wire Size                                      | 8 AWG  |
| Wire Type                                      | Stranded Copper; Class B: Compact, Compressed or Concentric, Class C: Concentric   |
| Wire Strip Length                              | 3/4 in.  |
| Stud Size                                      | 1/4 in.  |
| UL Listed Wire Connector                       | Yes, for applications up to 35kv. Consult cable manufacturer for voltage stress relief instructions with applications greater than 2000 volts. |
| UL Temperature Rating                          | 90 ° C   |
| C.S.A Certified Wire Connector                 | Yes  |
| Panduit Color Code on Barrel                   | RED  |
| Panduit Die Index No. on Barrel                | P21  |
| Alternate Industry Die Index No. ( ) on Barrel | N/A  |

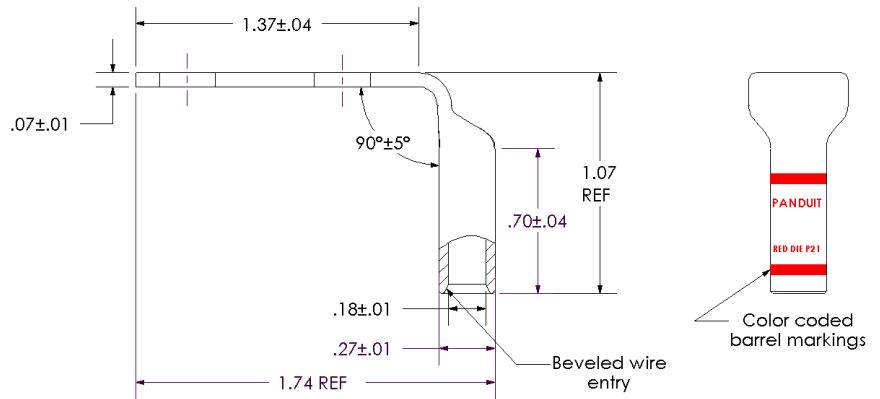
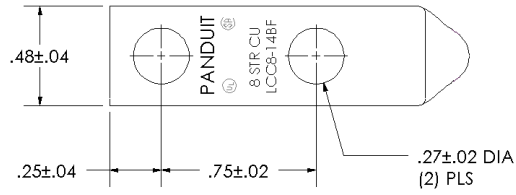

|     |      |     |     |  |                |
|-----|------|-----|-----|--|----------------|
|     |      |     |     | <b>PANDUIT CORP. TINLEY PARK, ILLINOIS</b>           |                |
|     |      |     |     | LCC8-14BF-L  |                |
|     |      |     |     | Copper Lug - Two-Hole, Long Barrel, 90° Angle Tongue |                |
| 00  | 9/02 | SAB | DRL | RELEASED   | 10335          |
| REV | DATE | BY  | CHK | DESCRIPTION  | ECN            |
|     |      |     |     |  | SCALE N/A      |
|     |      |     |     | DRAWING NO / CAD FILE                                | LCC8-14BF-CUST |