

Excellent Integrated System Limited

Stocking Distributor

Click to view price, real time Inventory, Delivery & Lifecycle Information:

[Panduit](#)

[FHDEC2X2BL](#)

For any questions, you can email us directly:

sales@integrated-circuit.com

THIS COPY IS PROVIDED ON A RESTRICTED BASIS AND IS NOT TO BE USED IN ANY WAY DETRIMENTAL TO THE INTERESTS OF PANDUIT CORP.

PANDUIT PART NUMBER	WEIGHT
FHDEC2X2	0.03 LB/EACH (15g/EACH)



NOTES:

1. SEE CURRENT CATALOG FOR ADDITIONAL PART SUFFIXES TO INDICATE COLOR AND/OR PACKAGE QUANTITY.
2. DIMENSIONS IN PARENTHESES ARE IN METRIC.

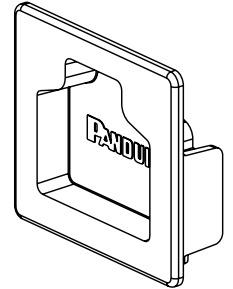
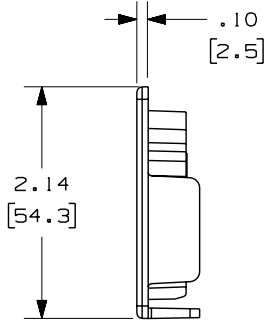
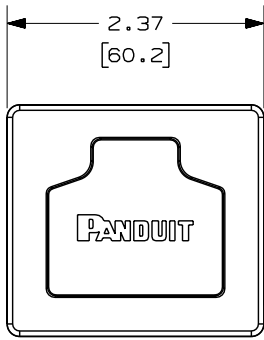
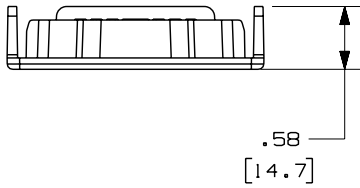

ENG. REF.: D38390BB_DC_FHDEC2X2_01.prt

CAD FILENAME/LAYERS		A FHDEC2X2.pdf	
PANDUIT		CORP TINLEY PARK, ILLINOIS	
PANDUIT TYPES H AND HS 2x2 WIRING DUCT AND FIBERRUNNER 2x2 END CAP (FHDEC2X2)			
B CUSTOMER DRAWING			
UNLESS OTHERWISE SPECIFIED, DIMENSIONAL TOLERANCES ARE:		UNLESS OTHERWISE SPECIFIED, ALL DIMENSIONS ARE GIVEN IN INCHES, THIRD ANGLE PROJECTION.	
(.)X) ± .03 (.8)		(.)XXX) ± .03 (.8)	
ANGLES ±		ANGLES ±	
REV	DATE	BY	CHK
-	-----	---	--
C. REVISED PART WEIGHT			
1	6-21-06	DTP	RN
B. REVISED DRAWING TITLE		A. REVISED CAD FILE NAME	
38390-02	RN	RN	
R	2-21-02	JHNU	DJWA
RELEASED TO PRODUCTION		38390-02	
HIW	HIW		
REV	DATE	BY	CHK
DESCRIPTION	ECN	R	CUST
SUP	GMBH		
DRAWN BY		MATERIAL	
JHNU		ABS	
DATE		SCALE	
2-21-02		NONE	
CHK'D		DRAWING NO.	
DJWA		38390-02	
		DWG	
		A	
		SIZE	
		A	