

## Excellent Integrated System Limited

Stocking Distributor

Click to view price, real time Inventory, Delivery & Lifecycle Information:

[Panduit](#)  
[FR6ACB58](#)

For any questions, you can email us directly:  
[sales@integrated-circuit.com](mailto:sales@integrated-circuit.com)

THIS COPY IS PROVIDED ON A RESTRICTED BASIS AND IS NOT TO BE USED IN ANY WAY DETRIMENTAL TO THE INTERESTS OF PANDUIT CORP.

△

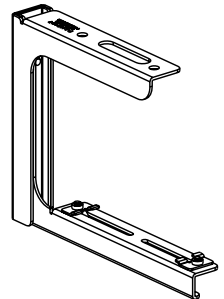
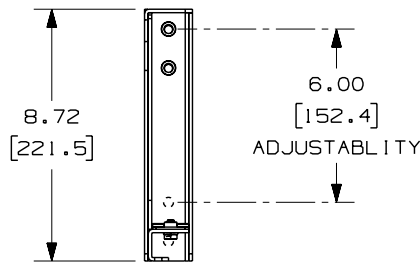
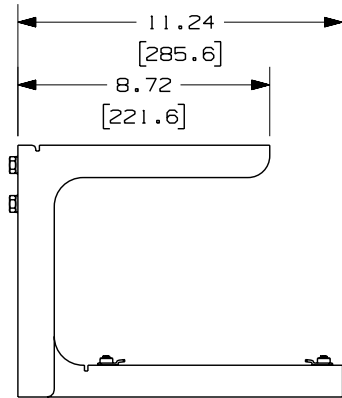
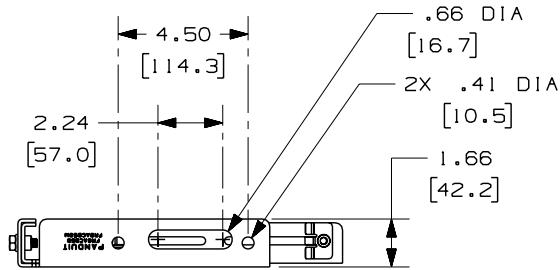

| PANDUIT PART NUMBER   | WEIGHT                       |
|-----------------------|------------------------------|
| FR6ACB58<br>FR6ACB58M | 3.54 LB/EACH<br>(1606g/EACH) |

△

△ NOTES:

1. SEE CURRENT CATALOG FOR ADDITIONAL PART SUFFIXES TO INDICATE PACKAGE QUANTITY.
2. THE FIBERRUNNER 4x4 AND 6x4 QUIKLOCK ADJUSTABLE "C" BRACKET IS USED TO SUPPORT THE FIBERRUNNER 4x4 AND 6x4 CABLE ROUTING SYSTEMS FROM A SECTION OF NEW 5/8" (M16) THREADED ROD (NOT INCLUDED) OR CAN BE DIRECTLY MOUNTED TO THE CEILING.
3. THE FIBERRUNNER 4x4 AND 6x4 QUIKLOCK ADJUSTABLE "C" BRACKET INCLUDES:  
ONE (1) BRACKET ASSEMBLY,  
TWO (2) 5/8-11 HEAVY HEX NUTS (FR6ACB58 ONLY),  
TWO (2) M16x2 HEX NUTS (FR6ACB58M ONLY),  
TWO (2) 5/8 HELICAL SPRING LOCKWASHERS
4. FINISH COLOR: BLACK (EXCEPT HARDWARE)
5. DIMENSIONS IN PARENTHESES ARE IN METRIC.

ENG. REF.: D38022BY\_DC\_FR6ACB58\_01.prt

CAD FILENAME/LAYERS △ FR6ACB58.pdf

**PANDUIT** CORP TINLEY PARK, ILLINOIS  
FIBERRUNNER 4x4 AND 6x4 QUIKLOCK  
ADJUSTABLE "C" BRACKET - 5/8" (M16)  
THREADED ROD (FR6ACB58, FR6ACB58M)  
CUSTOMER DRAWING

UNLESS OTHERWISE SPECIFIED, DIMENSIONAL TOLERANCES ARE:  
(.X) ± (.XXX) ±  
(.XX) ± (.03 (.8) ANGLES ±

UNLESS OTHERWISE SPECIFIED, ALL DIMENSIONS ARE GIVEN IN INCHES, THIRD ANGLE PROJECTION.

| REV | DATE   | BY  | CHK | DESCRIPTION  | ECN      | R  | CUST | SUP | GMBH |
|-----|--------|-----|-----|--|----------|----|------|-----|------|
| -   | -----  | --- | --  | E. REVISED GENERAL NOTES.                            | -----    | -- | --   |     |      |
| -   | -----  | --- | --  | D. REVISED PART WEIGHT.<br>C. REVISED DRAWING TITLE. | -----    | -- | --   |     |      |
| 1   | 1-3-07 | MSO | RN  | B. REVISED CAD FILENAME.<br>A. REVISED AND REDRAWN.  | 38022-30 | RN | RN   |     |      |

|                  |                 |                  |
|------------------|-----------------|------------------|
| DRAWN BY<br>JHNU | MAT'L:<br>STEEL | SCALE<br>NONE    |
| DATE<br>5-24-01  |                 | DWG<br>38022-30  |
| CHK'D<br>HIW     |                 | DWG<br>A<br>SIZE |