

Excellent Integrated System Limited

Stocking Distributor

Click to view price, real time Inventory, Delivery & Lifecycle Information:

[Panduit](#)

[FROVRA6X4BL](#)

For any questions, you can email us directly:

sales@integrated-circuit.com

THIS COPY IS PROVIDED ON A RESTRICTED BASIS AND IS NOT TO BE USED IN ANY WAY DETRIMENTAL TO THE INTERESTS OF PANDUIT CORP.



PANDUIT PART NUMBER	WEIGHT
FROVRA6X4	0.84 LB/EACH (382g/EACH)



NOTES:

- SEE CURRENT CATALOG FOR ADDITIONAL PART SUFFIXES TO INDICATE COLOR AND/OR PACKAGE QUANTITY.
- THE FIBERRUNNER 6x4 OUTSIDE VERTICAL RIGHT ANGLE FITTING IS DESIGNED WITH A MINIMUM 2" (50.8) BEND RADIUS TO PROTECT FIBER OPTIC CABLES.
- DIMENSIONS IN PARENTHESES ARE IN METRIC.

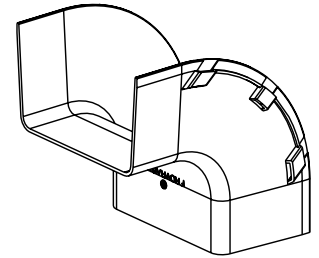
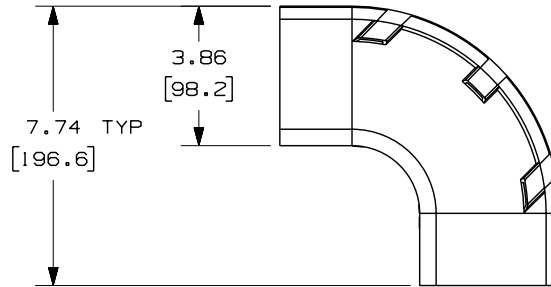
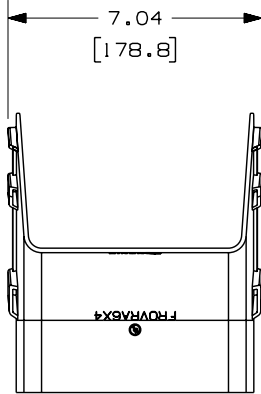

ENG. REF.: D37185EO_DC_FROVRA6X4_02.prt

CAD FILENAME/LAYERS: FROVRA6X4.pdf

												TINLEY PARK, ILLINOIS	
										FIBERRUNNER 6x4 OUTSIDE VERTICAL RIGHT ANGLE FITTING (FROVRA6X4) CUSTOMER DRAWING			
										UNLESS OTHERWISE SPECIFIED, DIMENSIONAL TOLERANCES ARE: (.X) ± .03 (.8) (.XXX) ± .03 (.8) (.XX) ± .03 (.8) ANGLES ±		UNLESS OTHERWISE SPECIFIED, ALL DIMENSIONS ARE GIVEN IN INCHES, THIRD ANGLE PROJECTION.	
-	-----	---	---	K. REVISED PART WEIGHT J. REVISED GENERAL NOTES				-----	--	--	DRAWN BY: REWE DATE: 4-28-00 CHK'D: HIW	MAT'L: ABS	SCALE: NONE
3	7-10-06	DTP	RN	I. REVISED CAD FILENAME H. REVISED AND REDRAWN				37185-61	RN	RN			DRAWING NO.: 37185-61 DWG SIZE: A
REV	DATE	BY	CHK	DESCRIPTION				ECN	R	CUST	SUP	GMBH	