

Excellent Integrated System Limited

Stocking Distributor

Click to view price, real time Inventory, Delivery & Lifecycle Information:

[Panduit](#)
[FRRF126LBL](#)

For any questions, you can email us directly:
sales@integrated-circuit.com

THIS COPY IS PROVIDED ON A RESTRICTED BASIS AND IS NOT TO BE USED IN ANY WAY DETRIMENTAL TO THE INTERESTS OF PANDUIT CORP.

A

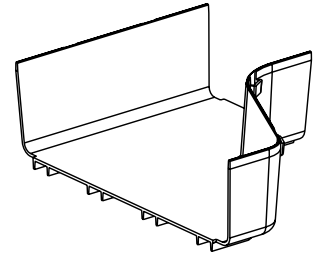
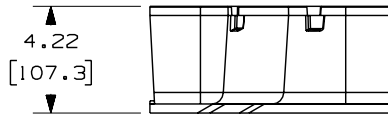
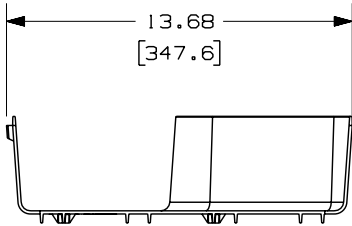
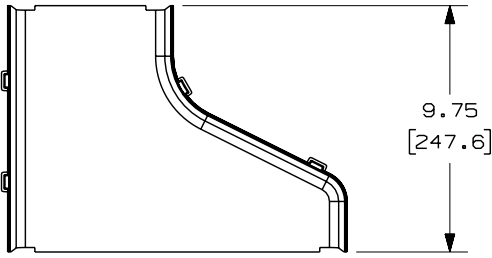

PANDUIT PART NUMBER	WEIGHT
FRRF126L	1.01 LB/EACH (460g/EACH)

E

NOTES:

- SEE CURRENT CATALOG FOR ADDITIONAL PART SUFFIXES TO INDICATE COLOR AND/OR PACKAGE QUANTITY.
- THE FIBERRUNNER 12x4 TRANSITION LEFT WITH 6" EXITS IS DESIGNED WITH A MINIMUM 2" (50.8) BEND RADIUS TO PROTECT FIBER OPTIC CABLES.
- DIMENSIONS IN PARENTHESES ARE IN METRIC.

ENG. REF.: D37617XC_DC_FRRF126L_01.prt

CAD FILENAME/LAYERS		C FRRF126L.pdf	
PANDUIT CORP		TINLEY PARK, ILLINOIS	
FIBERRUNNER 12x4 TRANSITION LEFT WITH 6" EXIT (FRRF126L)		CUSTOMER DRAWING	
UNLESS OTHERWISE SPECIFIED, DIMENSIONAL TOLERANCES ARE:		UNLESS OTHERWISE SPECIFIED, ALL DIMENSIONS ARE GIVEN IN INCHES, THIRD ANGLE PROJECTION.	
(.)X) ± .03 (.8)		(.)XXX) ± .03 (.8)	
ANGLES ±		SCALE NONE	
DRAWN BY	JHNU	MAT'L:	ABS
DATE	5-24-01	DRAWING NO.	37617-114
CHK'D	HIW	DWG	A
		SIZE	A

REV	DATE	BY	CHK	DESCRIPTION	ECN	R	CUST	SUP	GMBH
-	-----	---	---	E. REVISED PART WEIGHT	-----	--	--		
-	-----	---	---	D. REVISED GENERAL NOTES C. REVISED CAD FILENAME	-----	--	--		
1	7-13-06	DTP	RN	B. REVISED DRAWING TITLE A. REVISED AND REDRAWN	37617-114	RN	RN		