

Excellent Integrated System Limited

Stocking Distributor

Click to view price, real time Inventory, Delivery & Lifecycle Information:

[Panduit](#)
[CPNEI-2G](#)

For any questions, you can email us directly:
sales@integrated-circuit.com

THIS COPY IS PROVIDED ON A RESTRICTED BASIS AND IS NOT TO BE USED IN ANY WAY DETRIMENTAL TO THE INTERESTS OF PANDUIT CORP.

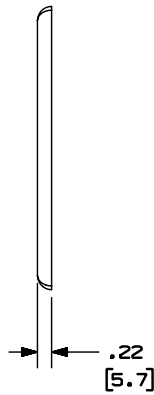
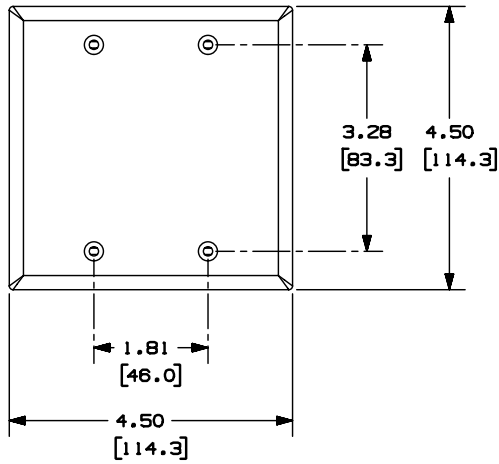

PANDUIT PART NO.	WEIGHT
CPN-2G	.087 LBS/EACH [39.50 g/EACH]

NOTES:

- SEE CURRENT CATALOG FOR ADDITIONAL PART NUMBER SUFFIXES TO INDICATE COLOR AND/OR PACKAGE QUANTITY.
- FOUR (4) #6-32 X 1/2" SLOTTED OVAL HEAD SCREWS ARE INCLUDED WITH FACEPLATE.
- DIMENSIONS IN PARENTHESIS ARE IN METRIC.

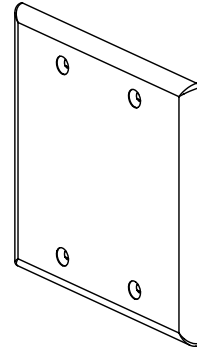

00 FILNAME/LAYER D38665BA_DC_CPN-2G_00B.PRT

										PANDUIT		CORP. TINLEY PARK, ILLINOIS	
										70 mm BLANK SCREW-ON FACEPLATE (CPN-2G) CUSTOMER DRAWING			
										UNLESS OTHERWISE SPECIFIED, DIMENSIONAL TOLERANCES ARE: (.XX) ± .03 (.8) ANGLES ±		UNLESS OTHERWISE SPECIFIED, ALL DIMENSIONS ARE GIVEN IN INCHES, THIRD ANGLE PROJECTION.	
1	06-24-03	JBN	PM	RELEASED TO PRODUCTION	38665-02	RGRO	RGRO			DRAWN BY JBN	MAT'L: ABS	SCALE NONE	
R	04-04-03	JBN	PM	DRAWING RELEASED						DATE 04-04-03		DRAWING NO. 38665-02	DWG A
REV	DATE	BY	CHK	DESCRIPTION	ECN	CHK	CUST	SUP		DRW'G PM			SIZE