

Excellent Integrated System Limited

Stocking Distributor

Click to view price, real time Inventory, Delivery & Lifecycle Information:

[Panduit](#)
[PLF1MC-M3](#)

For any questions, you can email us directly:
sales@integrated-circuit.com

THIS COPY IS PROVIDED ON A RESTRICTED BASIS AND IS NOT TO BE USED IN ANY WAY DETRIMENTAL TO THE INTERESTS OF PANDUIT CORP.

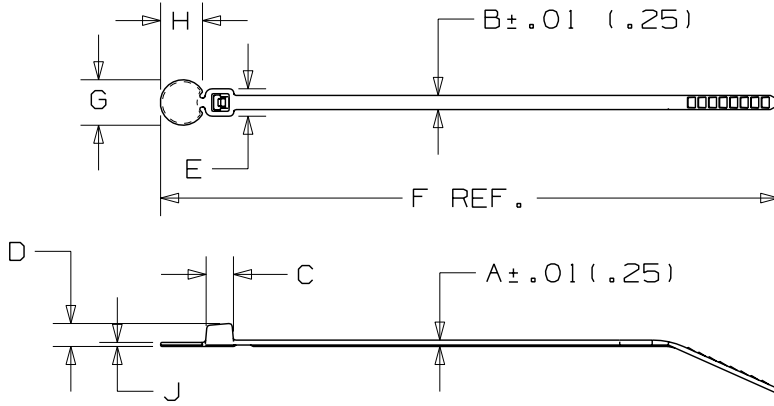

PANDUIT PART NO. *	BUNDLE DIA.		A in (mm)	B in (mm)	C in (mm)	D in (mm)	E in (mm)	F in (mm)	G in (mm)	H in (mm)	J in (mm)	WRITE-ON AREA in (mm)	MIN. LOOP TENSILE lbs (N)	CROSS SECTION	WEIGHT lbs/100 pcs. (g)
	MIN. in (mm)	MAX. in (mm)													
PLF1MC	.06 (1.5)	.87 (22.0)	.045 (1.1)	.098 (2.5)	.177 (4.5)	.154 (3.9)	.180 (4.6)	4.3 (109)	.315 (8.0)	.290 (7.4)	.038 (.96)	.064 (1.626)	18 (80)	MINIATURE	.07 (31.8)

DIMENSIONS IN PARENTHESES ARE IN METRIC UNITS

PANDUIT CORP. TINLEY PARK, ILLINOIS

PLF1MC CABLE TIE

UNLESS OTHERWISE SPECIFIED,
DIMENSIONAL TOLERANCES ARE:
(.X) ± .01 (.25) (.XXX) ± .020 (.50)
(.XX) ± .02 (.5) ANGLES ± _____

UNLESS OTHERWISE SPECIFIED,
ALL DIMENSIONS ARE GIVEN
IN INCHES, THIRD ANGLE PROJECTION.

DRAWN BY

MAT'L:

SCALE

NONE

RAMA

NYLON 6.6

DRAWING NO.

SS-27445

DATE

6/23/05

DWG

A

CHK'D

BOBK

SIZE

REV	DATE	BY	CHK	DESCRIPTION	ECN	R	CUST	SUP
3	5/02/06	FAB		CHANGED DIM. J FROM .028" TO .038"	27445	3		