

Excellent Integrated System Limited

Stocking Distributor

Click to view price, real time Inventory, Delivery & Lifecycle Information:

[Molex Connector Corporation](#)
[0428170012](#)

For any questions, you can email us directly:

sales@integrated-circuit.com

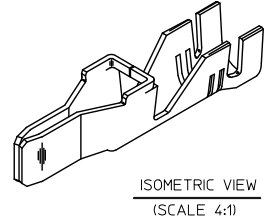
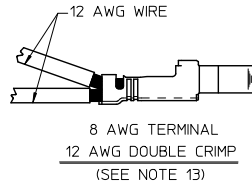
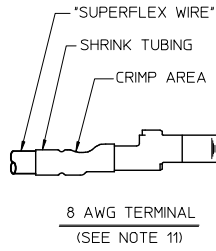
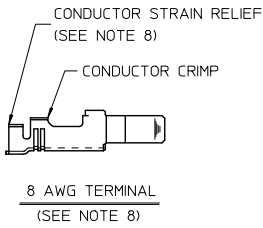
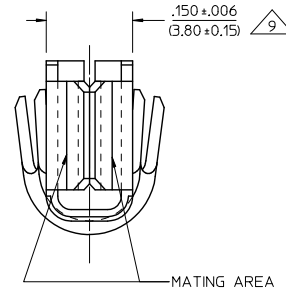
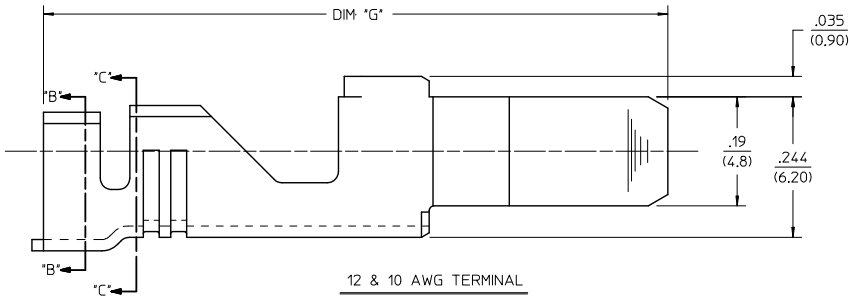
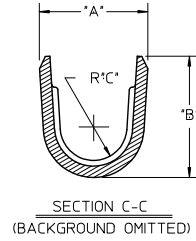
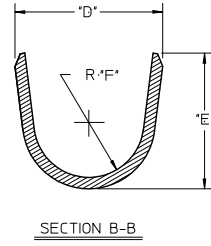
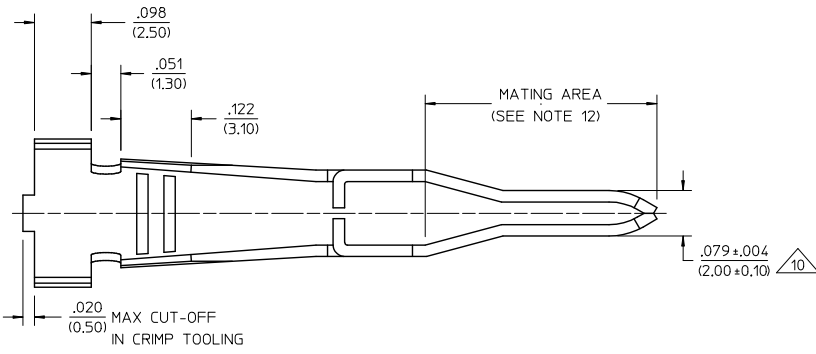

METRIC WIRE EC NO.: UCP2015-5009 DRAWN BY: 2015/05/28 CHK: ANDERSON APPROV: SMITH 2015/06/04	QUALITY SYMBOLS ∇=0 ∇=0 ∇=0	GENERAL TOLERANCES (UNLESS SPECIFIED)		DIMENSION STYLE		SCALE	DESIGN UNITS	THIRD ANGLE PROJECTION		
			mm	INCH	IN/MM		8:1	METRIC		
		4 PLACES	± ---	± ---	DRAWN BY	DATE	TITLE			
		3 PLACES	± ---	± 0.10	RJF	1/7/192	MALE CRIMP TERMINAL, 12, 10 & 8AWG MINIFIT SR.			
	2 PLACES	± 0.25	± 0.16	CHECKED BY	DATE					
	1 PLACE	± 0.40	± ---	RJF	1/7/192					
	0 PLACE	± ---	± ---	APPROVED BY	DATE	DOCUMENT NO.		SHEET NO.		
	ANGULAR ± 1/2°		MATERIAL NO.		SD-42817-*		1 OF 2			
DRAFT WHERE APPLICABLE MUST REMAIN WITHIN DIMENSIONS		SEE CHART		THIS DRAWING CONTAINS INFORMATION THAT IS PROPRIETARY TO MOLEX INCORPORATED AND SHOULD NOT BE USED WITHOUT WRITTEN PERMISSION						



Distributor of Molex Connector Corporation: Excellent Integrated System Limited

Datasheet of 0428170012 - CONN TERM MALE 10-12AWG GOLD

Contact us: sales@integrated-circuit.com Website: www.integrated-circuit.com

ITEM NUMBER	WIRE RANGE	DIM. A	DIM. B	DIM. C	DIM. D	DIM. E	DIM. F	DIM. G	MAX. INSULATION DIAMETER	PLATING	STATUS
42817-0011	12 & 10 AWG (5 & 6mm ²)	.213±.024 (5.40±.60)	.240±.016 (6.10±.40)	R ₁ .067 (1.70)	.232±.024 (5.90±.60)	.260±.016 (6.60±.40)	R ₁ .087 (2.20)	.1087 (27.60)	.209 DIA. (5.30)	OVERALL TIN	PLANNED FOR OBSOLESCENCE
42817-0031	8 AWG	.229±.024 (5.83±.60)	.292±.016 (7.42±.40)	R ₁ .067 (1.70)	.236±.024 (6.00±.60)	.216±.016 (5.50±.40)	R ₁ .087 (2.20)	.1087 (27.60)	.260 DIA. (6.60)		
42817-0111	12 & 10 AWG (5 & 6mm ²)	.213±.024 (5.40±.60)	.240±.016 (6.10±.40)	R ₁ .067 (1.70)	.232±.024 (5.90±.60)	.260±.016 (6.60±.40)	R ₁ .087 (2.20)	.1165 (29.60)	.209 DIA. (5.30)		
42817-0131	8 AWG	.229±.024 (5.83±.60)	.292±.016 (7.42±.40)	R ₁ .067 (1.70)	.236±.024 (6.00±.60)	.216±.016 (5.50±.40)	R ₁ .087 (2.20)	.1165 (29.60)	.260 DIA. (6.60)		
42817-0012	12 & 10 AWG (5 & 6mm ²)	.213±.024 (5.40±.60)	.240±.016 (6.10±.40)	R ₁ .067 (1.70)	.232±.024 (5.90±.60)	.260±.016 (6.60±.40)	R ₁ .087 (2.20)	.1087 (27.60)	.209 DIA. (5.30)	SELECT GOLD	ACTIVE
42817-0032	8 AWG	.229±.024 (5.83±.60)	.292±.016 (7.42±.40)	R ₁ .067 (1.70)	.236±.024 (6.00±.60)	.216±.016 (5.50±.40)	R ₁ .087 (2.20)	.1087 (27.60)	.260 DIA. (6.60)		
42817-0112	12 & 10 AWG (5 & 6mm ²)	.213±.024 (5.40±.60)	.240±.016 (6.10±.40)	R ₁ .067 (1.70)	.232±.024 (5.90±.60)	.260±.016 (6.60±.40)	R ₁ .087 (2.20)	.1165 (29.60)	.209 DIA. (5.30)		
42817-0132	8 AWG	.229±.024 (5.83±.60)	.292±.016 (7.42±.40)	R ₁ .067 (1.70)	.236±.024 (6.00±.60)	.216±.016 (5.50±.40)	R ₁ .087 (2.20)	.1165 (29.60)	.260 DIA. (6.60)	SELECT SILVER	ACTIVE
42817-1014	12 & 10 AWG (5 & 6mm ²)	.213±.024 (5.40±.60)	.240±.016 (6.10±.40)	R ₁ .067 (1.70)	.232±.024 (5.90±.60)	.260±.016 (6.60±.40)	R ₁ .087 (2.20)	.1087 (27.60)	.209 DIA. (5.30)		
42817-1034	8 AWG	.229±.024 (5.83±.60)	.292±.016 (7.42±.40)	R ₁ .067 (1.70)	.236±.024 (6.00±.60)	.216±.016 (5.50±.40)	R ₁ .087 (2.20)	.1087 (27.60)	.260 DIA. (6.60)		
42817-1114	12 & 10 AWG (5 & 6mm ²)	.213±.024 (5.40±.60)	.240±.016 (6.10±.40)	R ₁ .067 (1.70)	.232±.024 (5.90±.60)	.260±.016 (6.60±.40)	R ₁ .087 (2.20)	.1165 (29.60)	.209 DIA. (5.30)	SELECT SILVER	ACTIVE
42817-1134	8 AWG	.229±.024 (5.83±.60)	.292±.016 (7.42±.40)	R ₁ .067 (1.70)	.236±.024 (6.00±.60)	.216±.016 (5.50±.40)	R ₁ .087 (2.20)	.1165 (29.60)	.260 DIA. (6.60)		

NOTES:

- MATERIAL: COPPER ALLOY 151, .020/(.150) THICK.
- PLATING:
 - .000100/(.00254) MIN. TIN OVER .000050/(.00127) MIN. NICKEL.
 - .000030/(.00076) MIN. SELECT GOLD IN CONTACT AREA. .000100/(.00254) MIN. SELECT TIN ON SOLDER TAILS OVER .000050/(.00127) MIN. NICKEL.
 - .000100/(.00254) MINIMUM SELECT SILVER IN CONTACT AREA. .000100/(.00254) MIN. SELECT TIN ON SOLDER TAILS OVER .000050/(.00127) MIN. NICKEL.
- PRODUCT SPEC: PS-42815-001.
- PACKAGING INFORMATION: PK-42815-001.
- PART IS DESIGNED IN METRIC.
- TERMINALS FOR USE WITH STRANDED WIRE ONLY.
- ITEM NUMBERS PRECEDED BY AN "X" IN THE CHART ARE NOT AVAILABLE.
- THE 8 AWG TERMINAL HAS NO INSULATION CRIMP. THE SECONDARY CRIMP SECTION ACTS AS A STRAIN RELIEF ON THE BARE CONDUCTOR ONLY. SEE MOLEX CRIMP SPECIFICATION FOR DETAILS.
- AFTER CRIMPING, THIS DIMENSION IS .140/(3.55) MINIMUM.
- AFTER CRIMPING, THIS DIMENSION IS .089/(2.25) MINIMUM.
- WHEN USING THE 8 AWG TERMINAL WITH "HI-FLEX" WIRE, MOLEX STRONGLY RECOMMENDS THAT THE APPROPRIATELY RATED HEAT SHRINK INSULATION BE APPLIED OVER THE WIRE INSULATION AND CRIMP AREA, AS SHOWN, TO MINIMIZE WIRE INSULATION CREEPAGE OUTSIDE OF HOUSING.

- WHEN USING OVERALL TIN PLATED TERMINALS. FOR APPLICATIONS INVOLVING VIBRATION AND/OR THERMAL CYCLING. MOLEX STRONGLY RECOMMENDS THE USE OF NYE LUBRICANT.NYOGEL 760G. ON THE MATING AREA OF THE TERMINAL. LUBRICANT SHOULD BE APPLIED AFTER THE TERMINALS ARE INSERTED INTO THE HOUSING. REFER AS-42815-001 FOR ADDITIONAL INFORMATION.
- THE 8 AWG TERMINAL WILL ALSO ACCOMMODATE 2 12 AWG WIRES SEE CRIMP SPEC FOR DETAILS.

SEE SHEET 1 EC NO: UCP 2015-5009 DRAWN: JIMMIE CHK: HANDESON APPR: SMITH 2015/05/28 2015/05/28 2015/06/04	QUALITY SYMBOLS ∇=0 ∇=0 ∇=0	GENERAL TOLERANCES (UNLESS SPECIFIED) 4 PLACES ±--- ±--- 3 PLACES ±--- ±.010 2 PLACES ±0.25 ±.016 1 PLACE ±0.40 ±--- 0 PLACE ±--- ±---	DIMENSION STYLE IN/MM	SCALE 8:1	DESIGN UNITS METRIC	THIRD ANGLE PROJECTION
		DRAWN BY: R J F CHECKED BY: R J F APPROVED BY: RAS DATE: 11/7/92 DATE: 11/7/92 DATE: 11/7/92	TITLE MALE CRIMP TERMINAL, 12, 10 & 8AWG MINIFIT SR. 	MATERIAL NO. SEE CHART	DOCUMENT NO. SD-42817-*	SHEET NO. 2 OF 2

DRAFT WHERE APPLICABLE MUST REMAIN WITHIN DIMENSIONS
 THIS DRAWING CONTAINS INFORMATION THAT IS PROPRIETARY TO MOLEX INCORPORATED AND SHOULD NOT BE USED WITHOUT WRITTEN PERMISSION