



## **Excellent Integrated System Limited**

Stocking Distributor

Click to view price, real time Inventory, Delivery & Lifecycle Information:

[Amphenol RF](#)  
[102-799-34](#)

For any questions, you can email us directly:

[sales@integrated-circuit.com](mailto:sales@integrated-circuit.com)



**Distributor of Amphenol RF: Excellent Integrated System Limited**  
**Datasheet of 102-799-34 - STRAIGHT PLUG COAX CONNECTOR**

NOTES:  
 1. DO NOT SCALE THIS DRAWING.

2. MATERIALS AND FINISHES:  
 BODY - BRASS, NICKEL PLATED  
 CONTACT - BRASS, GOLD PLATED  
 OUTER CONTACT - BeCu, GOLD PLATED  
 FERRULE - COPPER, NICKEL PLATED  
 INSULATOR - TFE FLUOROCARBON

3. CONNECTOR CONFORMS TO:  
 DIN 41 626, DIN 47 297  
 NFC 93 569, NFC 93 571  
 CECC 22 230

4. PERFORMANCE:  
 IMPEDANCE - 50 Ohm  
 FREQUENCY RANGE - DC TO 10 GHz  
 INS RESISTANCE - 10,000 Mohm  
 DWV - 750 V  
 VSWR DC TO 0.1 GHz - 1.06  
 0.1 TO 0.5 GHz - 1.13  
 0.5 TO 1.0 GHz - 1.22  
 OPERATING TEMP - -40° TO +155°C  
 DURABILITY - 500 CYCLES

5. FOR USE WITH L910/34, L910/39 CABLE

6. CRIMP FERRULE USING .213 HEX DIE (M22520/5-05, CAVITY A)

102-799-34		REVISIONS			
DRAWING NO.	REV	DESCRIPTION	DATE	ECO	APPR
THIRD ANGLE PROJ.	A	ENGINEERING RELEASE	05/01/97	41915	DL/BG
	B	INTERNAL MODIFICATION	6/4/97	42010	DL/eq

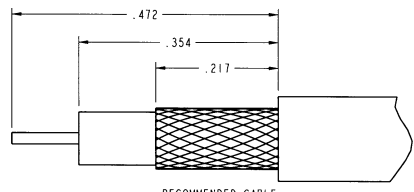
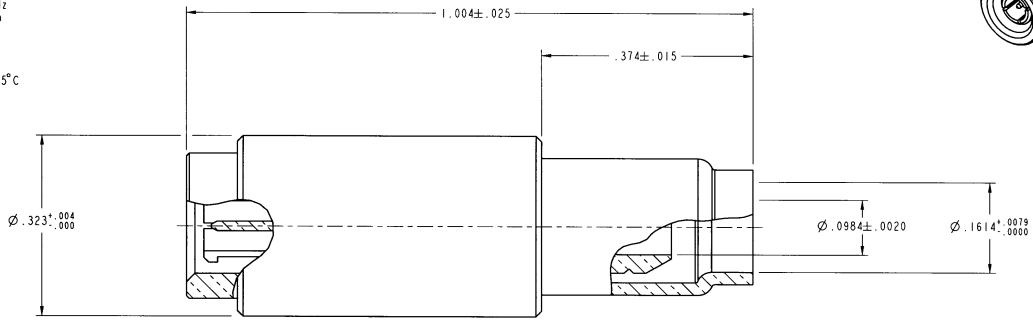
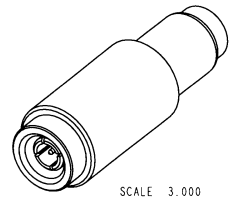

RECOMMENDED CABLE STRIPPING DIMENSIONS SCALE 6.000

CUSTOMER OUTLINE DRAWING

UNLESS OTHERWISE SPECIFIED, DIMENSIONS ARE IN INCHES AND TOLERANCES ARE: 2 PLACE DECIMAL ±.015 (0.381 mm)    3 PLACE DECIMAL ±.005 (0.127 mm)    ANGLES ± 1°	MATERIAL	DRAWN D. LUI	DATE 14-Apr-97	TITLE STRAIGHT PLUG (1.0/2.3)	Amphenol Corporation Communication and Network Products Division Danbury, CT U.S.A. 06810
	REFERENCE	ENGINEER	DATE		
NOTICE - These drawings, specifications, or other data (1) are, and remain the property of Amphenol Corp. (2) must be returned upon request; and (3) are confidential and not to be disclosed to any person other than those to whom they are given by Amphenol Corp. The furnishing of these drawings, specifications, or other data by Amphenol Corp., or to any other person to anyone for any purpose is not to be regarded by implication or otherwise in any manner licensing, granting rights or permitting such holder or any other person to manufacture, use or sell any product, process or design, patented or otherwise, that may in any way be related to or disclosed by said drawings, specifications, or other data.	REF SOCAPEX 102 799 34 EAR 966535 0	APPROVED B. GLEISSNER	DATE 30-Apr-97	CODE ID 74868	DWG SIZE B
		CAD FILE 1:\1023\102-799-34	DRAWING NO. 102-799-34	SHEET 1 OF 2	REV B