

Excellent Integrated System Limited

Stocking Distributor

Click to view price, real time Inventory, Delivery & Lifecycle Information:

[Amphenol RF](#)
[902-9047](#)

For any questions, you can email us directly:

sales@integrated-circuit.com

NOTES:

1. MATERIALS AND FINISHES:
 BODY- BRASS(C3604BD), GOLD PLATED,
 CONTACT- BeB(C1720BD), GOLD PLATED
 INSULATORS(BS1)- PTFE
 SLEEVE- BRASS(C3604BD), NICKLE PLATED
 CAP- BRASS(C3604BD), GOLD PLATED
 P-SHELL- BeB(C1720BD), NICKLE PLATED
2. PACKAGING:
 A. QUANTITY: SINGLE PACK
 B. MARKING: BAG TO BE MARKED
 "AMPHENOL, 902-9047, AND DATE CODE"
3. CABLE ASSEMBLY:
 A. TRIM CABLE AS SHOWN
 B. INSERT CABLE COMPLETELY WITH BRAID ON OUTSIDE
 OF CRIMP BODY
 C. CRIMP FERRULE USING AMPHENOL TOOL 227-944
 WITH DIE SET 227-1221-03,
 CAVITY "B" (2.7mm HEX)
 D. SOLDER CONTACT TO CABLE CENTER
 CONDUCTOR AFTER CRIMPING.
 E. DEPRESS CAP AFTER SOLDERING TO COVER
 SOLDER ACCESS HOLE.

THIRD ANGLE PROJ.		REVISIONS			
REV	DESCRIPTION	DATE	ECO	APPR	
A	RELEASE TO MFG.	4/10/07	46488	NBP	

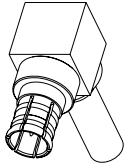

SCALE 3.000

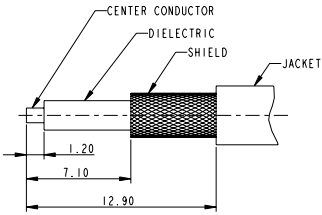
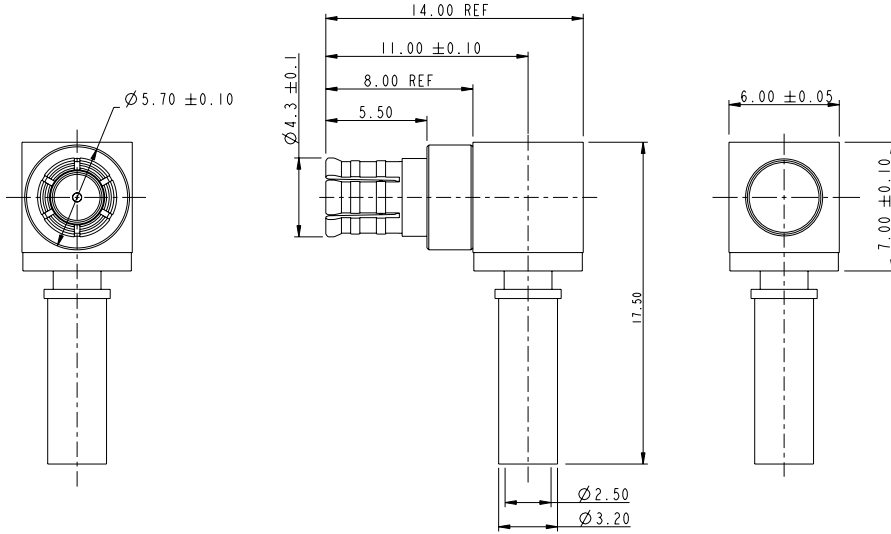

RECOMMENDED CABLE STRIPPING DIMENSIONS

CUSTOMER OUTLINE DRAWING
 ALL OTHER SHEETS ARE FOR INTERNAL USE ONLY

METRIC DRAWING

UNLESS OTHERWISE SPECIFIED, DIMENSIONS ARE METRIC AND TOLERANCES ARE:
 1 PLACE DECIMAL ± 0.3MM (.012") 2 PLACE DECIMAL ± .10 MM (.004") ANGLES ± 1°

NOTICE - These drawings, specifications, or other data (1) are, and remain the property of Amphenol Corp. (2) must be retained upon request, and (3) are confidential and not to be disclosed to any person other than those to whom they are given by Amphenol Corp. The furnishing of these drawings, specifications, or other data by Amphenol Corp., or to any other person to anyone for any purpose is not to be regarded by implication or otherwise in any manner licensing, granting rights to permitting such holder or any other person to manufacture, use or sell any product, process or design, patented or otherwise, that may in any way be related to or disclosed by said drawings, specifications, or other data.

MATERIAL	DRAWN	DATE	TITLE			Amphenol RF Danbury CT USA, Tainan, Taiwan, Shenzhen, China www.amphenolrf.com
	PRAVEEN N.B	23-Mar-07				
	ENGINEER	DATE	SCALE: 5.0:1.0 SHEET 1 OF 1			
	PRAVEEN N.B	23-Mar-07				
REFERENCE AND CONFIGURATION LEVEL:	APPROVED	DATE	DRAWING NO.			
	M. HOYACK	3/28/07				
FINISH	CAD FILE		DWG SIZE	CODE ID	REV	ITEM NO.
	/902-9047		B	74868	A	PART NO. 902-9047