

## Excellent Integrated System Limited

Stocking Distributor

Click to view price, real time Inventory, Delivery & Lifecycle Information:

[Amphenol Commercial Products  
1571869501](#)

For any questions, you can email us directly:

[sales@integrated-circuit.com](mailto:sales@integrated-circuit.com)



This document is the property of Amphenol Corporation and is intended for the express condition that it is not to be disclosed, reproduced or used, in whole or in part, for manufacturing or sale, by anyone other than Amphenol Corporation without its prior consent. It is the right of Amphenol Corporation to use any information in this document.

REVISIONS				
SYM	ECN#	DESCRIPTION	DATE	APPROVED
1	HK#	RELEASE DRAWING	5/29/08	IP

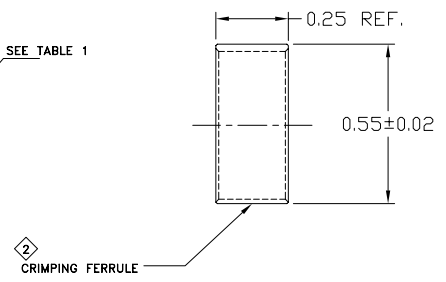
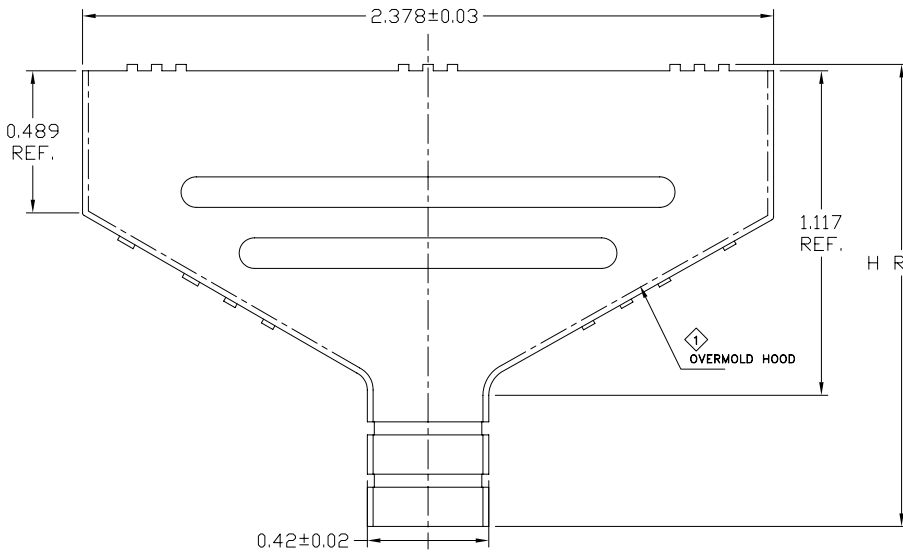

TABLE 1

PART NO.	DIM. H
157-1869-50X	1.59 REF.
157-1869-51X	1.41 REF.

NOTES:

- OVERMOLD CAN MAT'L.: COLD ROLLED STEEL 1018,1/4 HARD.
- CRIMPING FERRULE MAT'L.: CDA 260,1/4 HARD
- IDENTIFICATION TAG SHAL BE MARKED WITH AMPHENOL PART NO. AND PLACED IN THE POLYETHYLENE BAG.
- BULK PACK FERRULE IN A POLYETHYLENE BAG. BULK PACK OVERMOLD HOODS IN A BOX ALONG WITH THE POLYETHYLENE BAG FILLED WITH FERRULES.
- ALL DIMENSION IS ONLY FOR REFERENCE PURPOSE, BUT NOT CONTROLLED.
- ORDER PART NUMBER:157-1869-XXX.



PLATING DESCRIPTION	PART NUMBER	OVERMOLD HOOD	CRIMPING FERRULE	3X5
		ITEM 1	ITEM 2	POLYETHYLENE BAG
		2 PCS REQ'D	1 PCS REQ'D	NOT SHOWN
PURE TIN	157-1869-501	157-1858-501	157-1870-12	1-979-21-4
PURE TIN	157-1869-511	157-1858-511	157-1870-12	1-979-21-4
UNPLATE	157-1869-500	157-1858-500	157-1870-11	1-979-21-4
UNPLATE	157-1869-510	157-1858-510	157-1870-11	1-979-21-4

UNLESS OTHERWISE SPECIFIED TOLERANCES	APPROVAL	DATE	Amphenol
U.S. METRIC	DRAWN XS.GJO	5/28/08	
J ±/-.020	CHECKED		TITLE OVER MOLD HOOD, 50 CONTACT SIZE
.JX ±/-.015	CHECKED		
JXX ±/-.015			SIZE A3 DRAWING NO. C157-1869-XXX REV. 1
FRACTIONS ±/-.015			
ANGLES ±/-.015			SCALE NONE SHEET 1 OF 1
REMOVE SHARP EDGES			
FOR MATERIALS AND FINISHES SEE NOTES	DRAWING FILE : \DRAWING\157\C1571869XXX.DWG		
	ANGLE OF PROJECTION		
DIMENSIONS			
U.S. INCHES			
(METRIC) (MM)			