

Front Panels

Description

Front panels are available for 19" DIN-rack mounting of 3 U cassette type power supplies in *Schroff* system version (*Intermas* system on request) and may be attached to the converter by means of countersunk screws.

An assembly kit, consisting of a front panel and a support bracket, enables arrangement of two standard cassettes with up to six output voltages in 6 U configuration.

All front panels are of colorless anodized aluminum and delivered with one or 2 grey plastic handles of 3 TE for easy pull-out and 2 or 4 hand-press insertable plastic retainers with captive screws for fixing to the rack.

Note: Custom specific front panels are available on request.

Dimensions according to DIN 41494-1 (IEC 60297):

Width: 1 TE = 5.08 mm (0.20")

Height: 1 U = 44.45 mm (1.750")

Tolerances: ± 0.2 mm, unless otherwise specified.

Note: In Europa often *HE* instead of *U* is used.



Schroff System for 3 U Rack

Q-, P- Series Front Panels in 4, 5, or 6 TE

These front panels available in three versions and fit to all DC-DC converters of the Q- and P-Series; see fig. 1 for the mechanical details.

Table 1: Front panel selection for P and Q Series

TE	X mm	Case	Conv. series	Panel type	Designation
4	20.0	Q01	Q	G04-Q01	HZZ00835
		Q04	P	G04-Q04	HZZ00840
5	25.1	Q01	Q	G05-Q01	HZZ00836
		Q04	P	G05-Q04	HZZ00841
6	30.2	Q01	Q	G06-Q01 ¹	HZZ00839
		Q04	P	G06-Q04	HZZ00842
8	40.3	Q01	Q	G08-Q01	
		Q04	P	G08-Q04	HZZ00850

Note: For using several units next to each other, we advise to pack them not too densely in order to assure good thermal management (see also relevant data sheet).

Delivery contents:

Front panel, grey plastic handle, 3 countersunk screws, set of 2 plastic retainers with captive screws, and assembly instruction.

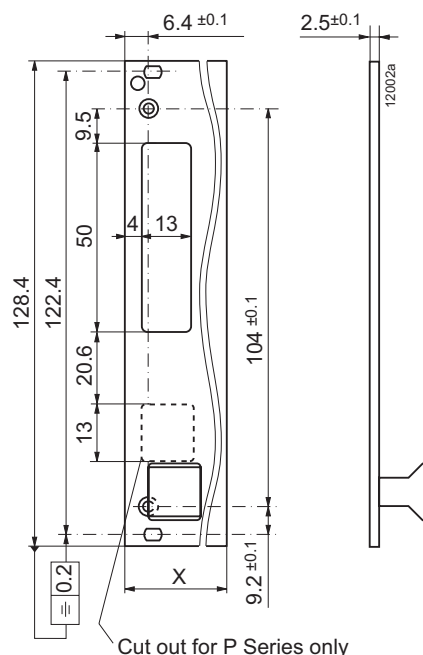

Fig. 1
Front panel for P and Q Series converters

M and LH Series Front Panels in 8 TE

This front panel fits to all 50 Watt DC-DC and AC-DC converters of the M Series (case M02) and LH Series (case H02).

Table 2: Front panel selection for M and LH Series

TE	mm	Case size	Converter series	Panel type Designation
8	40.3	M02	M	G08-M02
		H02	LH	HZZ00839

Delivery contents:

Front panel with grey plastic handle, 2 countersunk screws, set of 2 plastic retainers with captive screws, and assembly instruction.

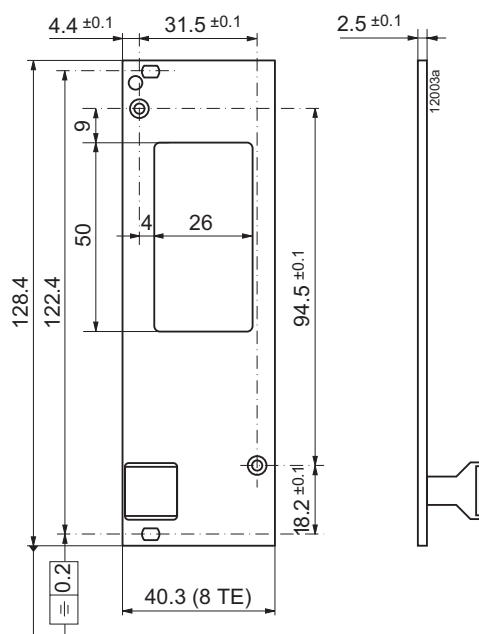

Fig. 2
Front panel for M and LH Series

PSL Series Front Panel in 8 TE

This front panel fits to the Switching Regulators of the PSL Series (case size L04).

Table 3: Front panel selection for PSL Series

TE	mm	Case size	Converter series	Panel type Designation
8	40.3	L04	PSL	G08-L HZZ00805
			PSL with opt. D	G08-L04-D HZZ00816

Delivery contents:

Front panel with grey plastic handle, 2 countersunk screws, set of 2 plastic retainers with captive screws and assembly instructions.

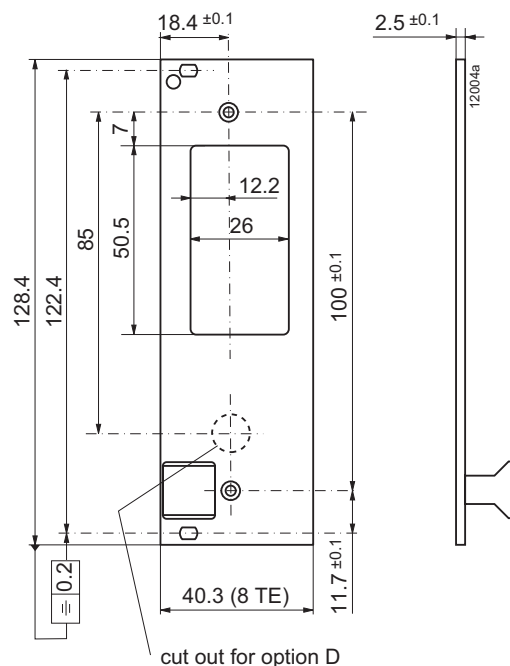

Fig. 3
Front panel for PSL Series

Front Panels 12 TE for S, HR, HRL, ER, ERL, PSS Front Panels 16 TE for K, HRP, ERP, PSK

These front panels fit to the converter series mentioned in the table below

Table 4: Front panel selection for S, K, R, PSS, PSK Series

Width x TE	mm	Case size	Converter series	Panel type Designation
12	60.6	S01	PSS	G12-S HZZ00845
		S02	S	
			ERL, HRL	
16	81.0	K01	PSK	G16-K HZZ00831
		K02	K, LKP	
			ERP, HRP	

Delivery contents:

Front panel with grey plastic handle, two countersunk screws, set of four plastic retainers with captive screws and assembly instructions.

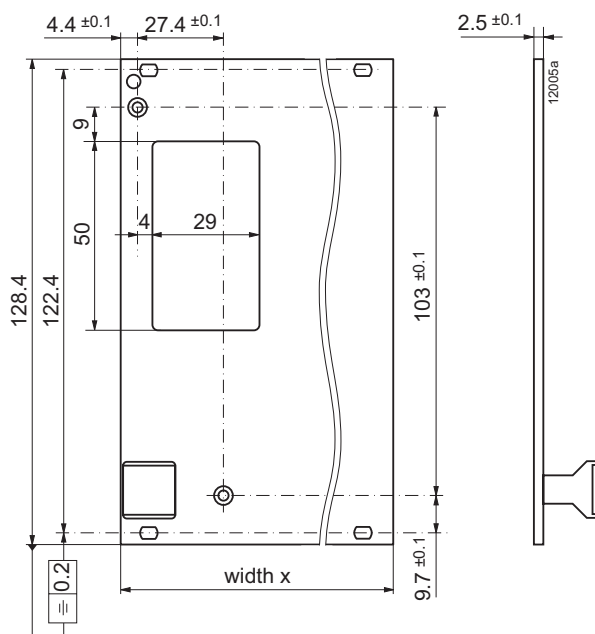

Fig. 4
Front panel for S, K, R, PSS, PSK Series; see table 4

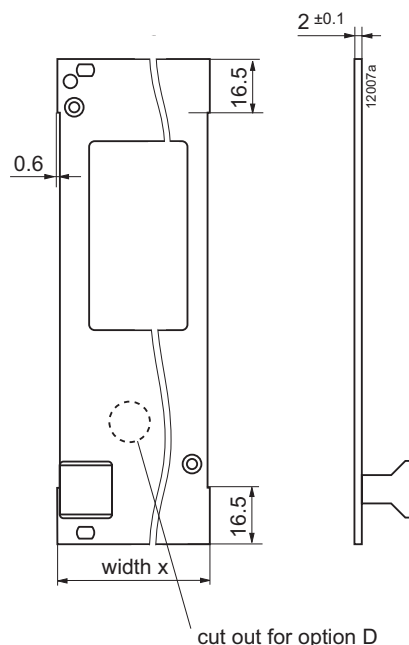

Fig. 5
Intermax system front panels (various case sizes)

Intermax System for 3 U Rack

The major differences between the Intermax and the Schroff system front panels are the thickness (2 mm instead of 2.5 mm), the hole size for the plastic retainers, and a small cut-out on each side; see figure 5. All other dimensions are specified in the relevant Schroff front panel drawings.

The following Intermax front panels are available on request:

Table 6: Intermax front panel selection

Width x TE	mm	Case size	Converter series	Panel type Designation
8	40.3	H02	LH	F08-M02
		M02	M	HZZ00702
8	40.3	L04	PSL	F08-L
			PSL with opt. D	HZZ00705
				F08-L04-D
				HZZ00716
12	60.6	S01	PSS	F12-S
		S02	S, HR, HRL, ER, ERL	HZZ00732
16	81.0	K01	PSK	F16-K
		K02	K, HRP, ERP	HZZ00731

Delivery contents:

Front panel with grey plastic handle, two countersunk screws and assembly instructions.

Schroff System Kit for 6 U Rack

To configure Power-One converters for use in 6 U racks, a special assembly kit has been created consisting of a double-height front panel together with a support bracket for 2 converters as shown in figure 6.

All other dimensions are given in the relevant 3 U front panel drawings according to their case size. The assembly kit is available with the type designation according to the following table:

Table 7: 6 U assembly kit selection

Width x TE	mm	Case size	Converter series	Type Designation
5	25.1	Q01	Q	Kit G05-6HE-Q01 HZZ00838
		Q04	P	Kit G05-6HE-Q04 HZZ
8	40.3	H02	LH	Kit G08-6HE-M02 HZZ00804
		M02	M	
12	60.6	S01	PSS	Kit G12-6HE-S HZZ00833
		S02	S, HR, HRL, ER, ERL	
16	81.0	K01	PSK	Kit G16-6HE-K HZZ00832
		K02	K, HRP, ERP	

Delivery contents:

Double-height front panel with 2 grey plastic handles, 4 countersunk screws, set of 2 plastic retainers with captive screws, a support bracket, and assembly instruction.

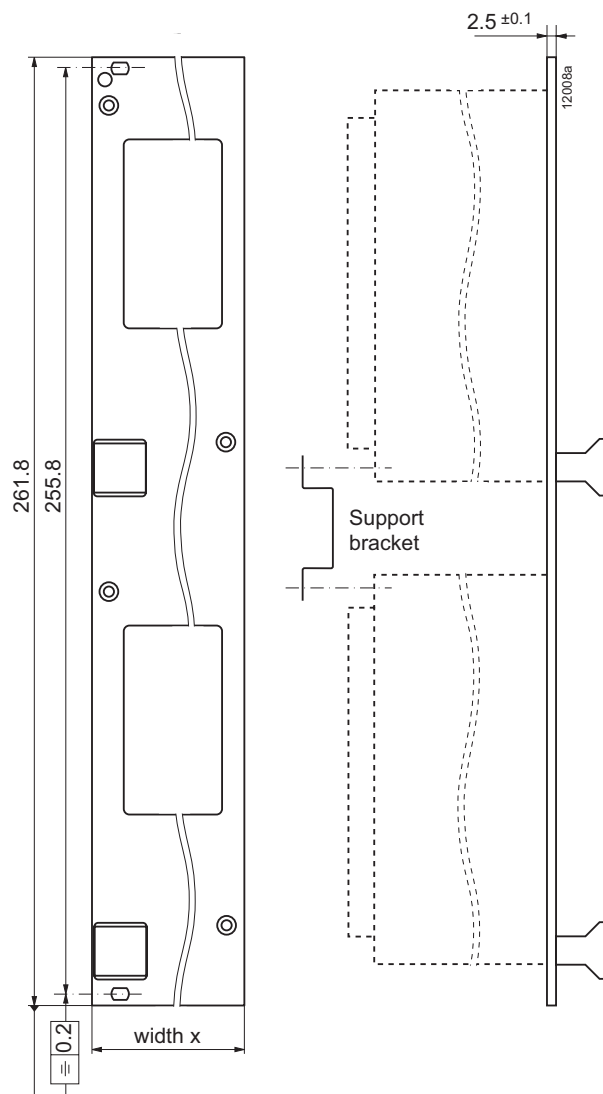

Fig. 6
Front panel for 6 U configuration (various case sizes).
Different additional holes depending on the model are not shown in the drawing.

DIN-Rack Systems

Complete 19" rack with side walls, transversal rails, and mounting flanges. Six guiding rails are included for set up of a system with up to three converters. The guiding rails shall be fixed to the rack by the delivered screws (12 screws M2.5 x 12 and 12 nuts).

The rack can be used for different 19" cassette style converters such as Q, P, M, K, S, R, etc. (additional guiding rails XKR001-G may be necessary).

Part no.: MQB02002
Size: 19" x 3 U / 84 HP (483 x 132 x 235 mm)

An enhanced version for Railway application is available:

Part no.: MQB02020G



19" and 23" (IEC 60297-1, -2 and -3)

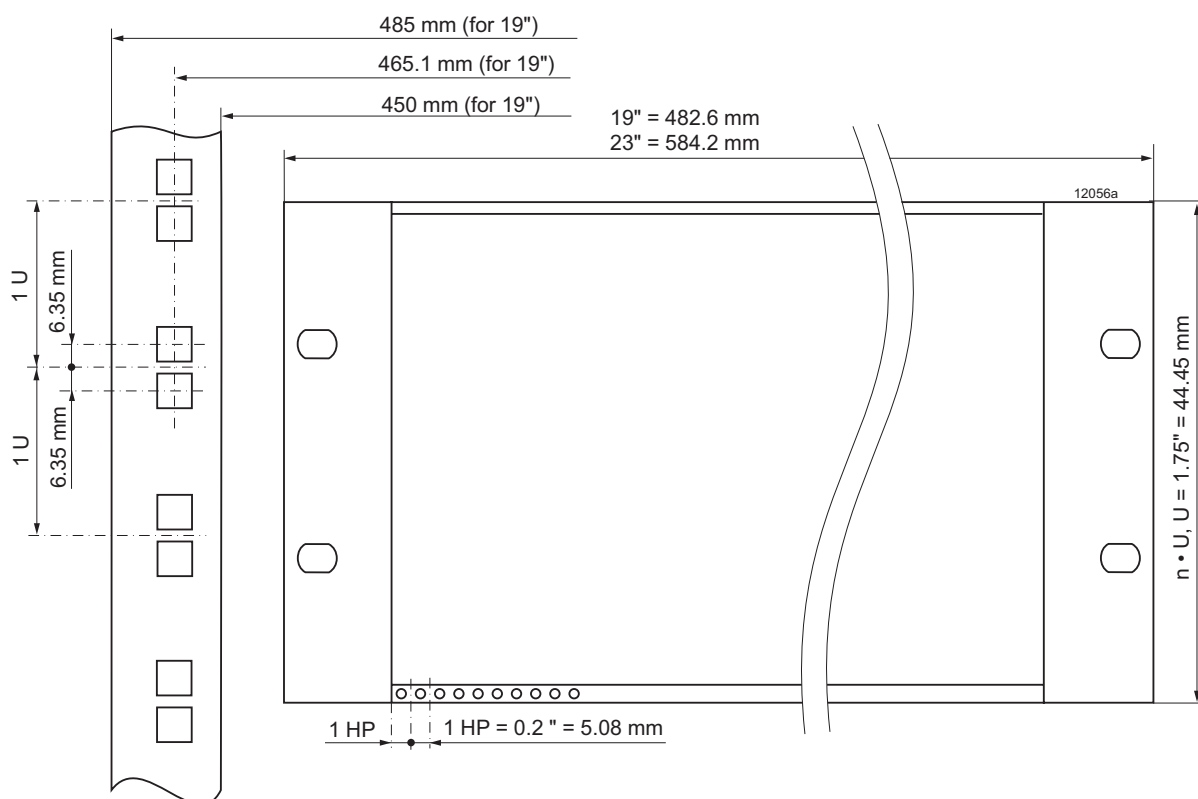

Fig. 7
19" and 23" rack systems

Dimensions in according to DIN 41494-1 (IEC 60297):

Width: 1 HP (or TE) = 5.08 mm (0.20"); height: 1 U (or HE) = 44.45 mm (1.750")

Tolerances ± 0.2 mm, unless otherwise specified.

NUCLEAR AND MEDICAL APPLICATIONS - Power-One products are not designed, intended for use in, or authorized for use as critical components in life support systems, equipment used in hazardous environments, or nuclear control systems without the express written consent of the respective divisional president of Power-One, Inc.

TECHNICAL REVISIONS - The appearance of products, including safety agency certifications pictured on labels, may change depending on the date manufactured. Specifications are subject to change without notice.