

Excellent Integrated System Limited

Stocking Distributor

Click to view price, real time Inventory, Delivery & Lifecycle Information:

[FCI](#)
[EZ02715200J0G](#)

For any questions, you can email us directly:

sales@integrated-circuit.com

| | |
|----------------|---------|
| PRODUCT NUMBER | PITCH |
| EZxx71x200J0G | 5.00 mm |

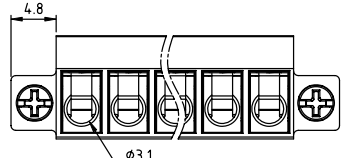
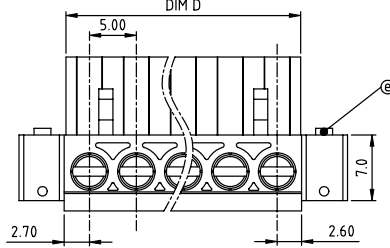
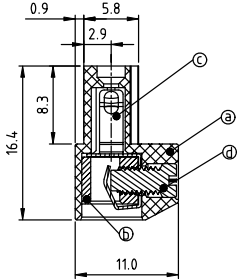
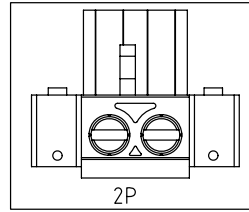
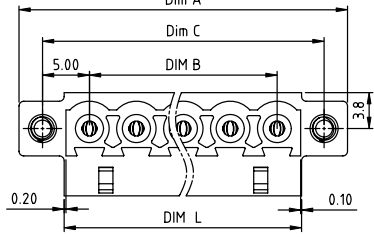

- Material:
- Item 1 Terminal(housing): Thermoplastic (UL94V-0)
 - Item 2 Clamp: Brass(CuZn) Ni plated
 - Item 3 Female contact: PhBz Tin plated
 - Item 4 Terminal Screw: Steel zinc plated."-" solt type
 - Item 5 With flange screw: M2.5 Steel Zinc plated."+/-" solt type
- Electrical: cULus
- Voltage rating: 300 V
 - Current rating: 15 A
 - Wire range:
 - Solid wire(AWG):12-22
 - Stranded wire(AWG):12-22
 - Torque: 4.3 Lb-In
 - Screw:M3
 - Wire strip length:7-8 mm
 - Withstanding Voltage:1.6KV
 - Operating temperature:-40°C to +115°C
 - Safety Approval: cULus

N=NUMBER OF POLES

Dim L=Nx5.0+0.3
Dim A=(N-1)x5.0+15.0
Dim B=(N-1)x5.0
Dim C=(N-1)x5.0+10.0
Dim D=Nx5.0

| POLES | Tolerance |
|---------|-----------|
| 2P-6P | ±0.15 |
| 7P-12P | ±0.20 |
| 13P-18P | ±0.25 |
| 19P-24P | ±0.30 |

PART NO.: EZ xx 71 x 2 00J0 G

| | | | | |
|--------------|-----|----------|--------------------|---|
| Solid block | 0 | Color | Black (RAL9005) | RoHS compliant (lead=4%) In copper Alloy |
| No. of poles | 2 | | Red (RAL3001/D) | |
| | 02 | | Orange(RAL2011/P) | |
| | 03 | | Yellow(RAL1018/A) | |
| | ... | | 5 Green(RAL6018/T) | |
| | 24 | 24 poles | 6 Blue (RAL5015/A) | |
| | | | 8 Grey(RAL7035/D) | |
| | | | 9 White(RAL1102) | |
| | | | C Green(RAL6018/U) | |

| | | | | |
|---------------------------------------|-----------------------|-------------------------|------------------|--|
| mat'l. code | surface ASME Y14.5 | tolerance ASME Y14.5 | projection MM | product family TERMINAL BLOCK |
| ltr | ecn | no | dr | date |
| tolerances unless otherwise specified | | | | title TERMINAL BLOCK PLUGGABLE PLUG, WITH FLANGE |
| angled | X.±0.5 | | | dwg no EZxx71x200J0G |
| X'±1' | X.X±0.3 | | | sheet 1 of 1 size A4 |
| | X.XX±0.1 | | | type CUSTOMER Drawing |
| dr | EVIN ZHONG | 041814 | | |
| enfr | EVIN ZHONG | 041814 | | |
| chr | HANKE FENG | 041814 | | |
| appd | SHI JUN | 041814 | | |
| sheet index | revision sheet | A 1 | | |