

Excellent Integrated System Limited

Stocking Distributor

Click to view price, real time Inventory, Delivery & Lifecycle Information:

[FCI](#)
[KF02105000J0G](#)

For any questions, you can email us directly:
sales@integrated-circuit.com

1 | 2

FCIconnect.com

3

4

PRODUCT NUMBER	PITCH
KFxx10x000J0G	3.50 mm

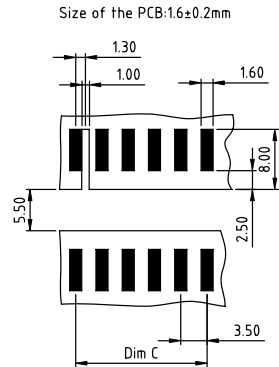
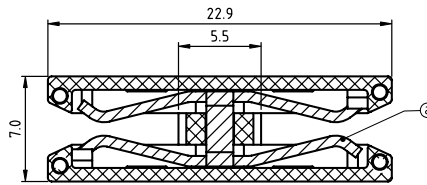
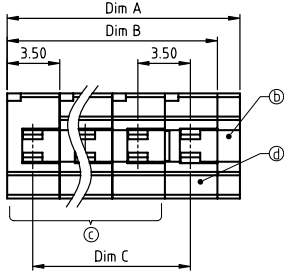

RECOMMENDED P.C.B LAYOUT
TOP VIEW

Material:

- Item②Female contact: PhBz(CuSn), Tin plated
- Item③Terminal Cover: Thermoplastic (UL94V-0)
- Item④Terminal housing: Thermoplastic (UL94V-0)
- Item⑤Terminal housing (B type): Thermoplastic (UL94V-0)

Electrical cULus

- Voltage rating: 300VAC
- Current rating: 8A
- Withstanding Voltage: 1.6KV
- Operating temperature: -40°C to +115°C

Dimension

Dim A	N×3.5+1.50
Dim B	N×3.5
Dim C	(N-1)×3.5

N=Number of poles

Poles	Tolerance
2p-6p	±0.15
7p-13p	±0.20
14p-18p	±0.30
19p-24p	±0.35

PART NO.: KF xx 10 x 0 00J0 G

End stackable	No. of poles	Color	RoHS compliant (lead<4%) In copper Alloy
0	2	Black (RAL9005)	
02	2 poles	Red (RAL3001/D)	
03	3 poles	Orange(RAL2011/P)	
...	...	4 Yellow(RAL1018/A)	
...	...	5 Green(RAL6018/T)	
24	24 poles	6 Blue (RAL5015/A)	
		8 Grey(RAL7035/D)	
		9 White(RAL1102)	
		C Green(RAL6018/U)	

mat'l. code	surface	tolerance	projection	product family
	ASME Y14.5	ASME Y14.5		TERMINAL BLOCK
ltr	ecn	no	dr	date
				tolerances unless otherwise specified
				angles
				X.±0.5
				X.X±0.3
				X'±1'
				X.XX±0.1
				scale
				MM
				dr
				ENGR
				chr
				appd
				SHI JUN 050614
sheet index	revision sheet	A	1	
				product family
				TERMINAL BLOCK
				title
				TERMINAL BLOCK
				PCB CONNECTOR,BOARD TO BOARD
				dwg no
				KFxx10x000J0G
				sheet 1 of 1
				size
				A4
				type
				CUSTOMER Drawing