

Excellent Integrated System Limited

Stocking Distributor

Click to view price, real time Inventory, Delivery & Lifecycle Information:

[FCI](#)
[KH02055100J0G](#)

For any questions, you can email us directly:
sales@integrated-circuit.com

PRODUCT NUMBER	PITCH
KHxx05x100J0G	6.35 mm

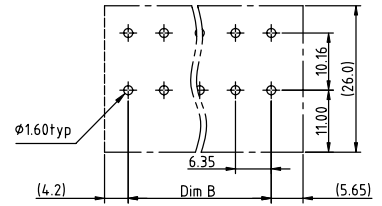
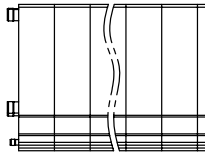

RECOMMENDED P.C.B LAYOUT
TOP VIEW

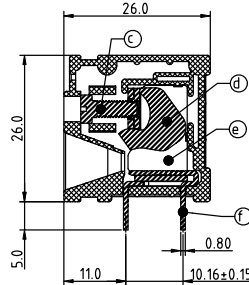
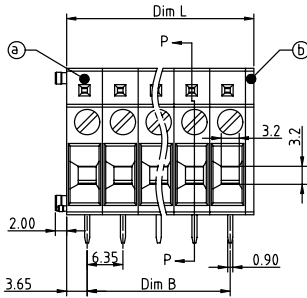

SECTION P-P

Material

- Item ① Terminal body; Thermoplastic (UL94V-0)
- Item ② Terminal cover; Thermoplastic (UL94V-0)
- Item ③ Terminal screw ;Steel Zinc plating "-" slot type
- Item ④ Firm wire chunk; Steel Zinc plated
- Item ⑤ Terminal body (metal housing); Steel, Zinc plating
- Item ⑥ Solder pin; Copper, Tin plated

Electrical cULus

- Voltage rating: 300VAC
- Current rating: 30A
- Wire range:
- Solid wire (AWG): 10-24
- Stranded wire (AWG): 10-24
- Torque (Lb-In): 4.3
- Screw: M3
- Wire strip length: 15-16mm
- Withstanding Voltage: 1.6KV
- Operating temperature: -40°C to +115°C
- Soldering temperature: 260°C ± 5°C / 5 Sec
- Safety Approval:

N = Number of poles
Dim A = $N \times 6.35 + 1.5$
Dim B = $(N-1) \times 6.35$

poles	Dim L	Dim B
1p	±0.10	±0.10
2-6p	±0.20	±0.20
7-12p	±0.30	±0.30
13-16p	±0.40	±0.40

PART NO.: KH xx 05 x 1 00J0 G

End stackable	Body Color	RoHS compliant
No. of poles	0 Black (RAL9005)	(lead<4%) In copper Alloy
01 1 pole	2 Red (RAL3001/D)	
02 2 poles	3 Orange (RAL2011/P)	
...	4 Yellow (RAL1018/A)	
...	5 Green (RAL6018/T)	
16 16 poles	6 Blue (RAL5015/A)	
	8 Grey (RAL7035/D)	
	9 White (RAL1102)	
	C Green (RAL6018/U)	

mat'l. code	surface ASME Y14.5 ✓	tolerance ASME Y14.5	projection 	product family TERMINAL BLOCK
ltr	ecn	no	dr	date
tolerances unless otherwise specified				
angles	X.±0.5		MM	
radius	X.X±0.3		←	
flatness	X.XX±0.1		scale	
dr	EVIN ZHONG	040114		
engr	EVIN ZHONG	040114		
chr	HANKE FENG	040114		
appd	SHI JUN	040114		
sheet index	revision sheet	A 1		