

Excellent Integrated System Limited

Stocking Distributor

Click to view price, real time Inventory, Delivery & Lifecycle Information:

[FCI](#)
[KU04C25100J0G](#)

For any questions, you can email us directly:

sales@integrated-circuit.com

PRODUCT NUMBER	PITCH
KU04C2x100J0G	15.00 mm

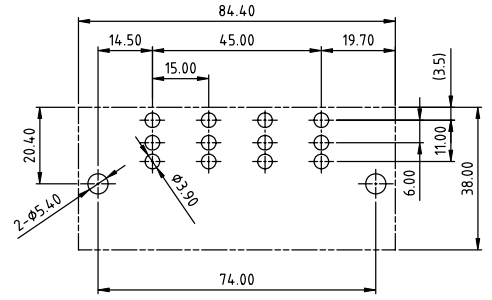
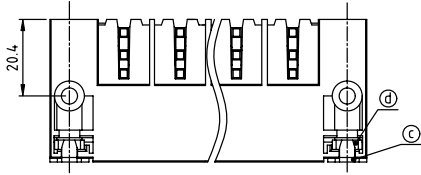

RECOMMENDED P.C.B. LAYOUT
TOP VIEW

- Material:
- Item (a) Terminal housing-Thermoplastic (UL94V-0)
 - Item (b) Male contact: Copper. Gold plated.
 - Item (c) Contact: Brass, Tin Plated.
 - Item (d) With flange nut: Steel M5.0 zinc plated.
- Electrical:
- Voltage rating: 600 V
 - Current rating: 115 A
 - Withstanding Voltage: 2.2 KV
 - Operating temperature: -40°C to +115°C
 - Soldering temperature: 260°C±5°C/5 Sec
 - Safety Approval: cULus

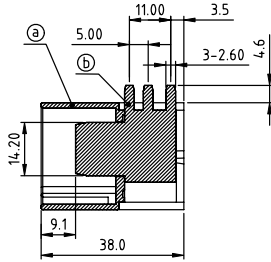
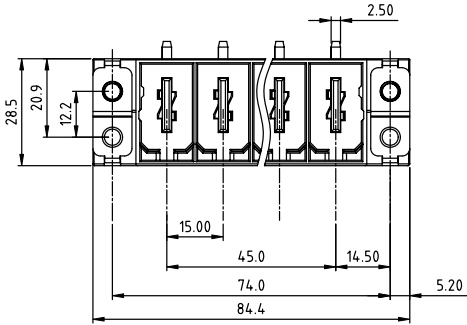

PART NO.: KU 04 C 2 x 1 00J0 G

- | | |
|---------------------|-----------------|
| Color | RoHS compliant |
| 0 Black (RAL9005) | (lead<4%) |
| 2 Red (RAL3001/D) | In copper Alloy |
| 3 Orange(RAL2011/P) | |
| 4 Yellow(RAL1018/A) | |
| 5 Green(RAL6018/T) | |
| 6 Blue (RAL5015/A) | |
| 8 Grey(RAL7035/D) | |
| 9 White(RAL1102) | |
| C Green(RAL6018/U) | |

mat'l. code	surface ASME Y14.5	tolerance ASME Y14.5	projection	product family
ltr	ecn	no	dr	date
tolerances unless otherwise specified				TERMINAL BLOCK
angles	X.±0.5		MM	title
X'±1'	X.X±0.3		scale	TERMINAL BLOCK PLUGGABLE SOCKET RIGHT ANGLE WITH FLANGE SHIELD FEED-THROUGH
dr	EVIN ZHONG	050814	FCI	sheet 1 of 1
enrg	EVIN ZHONG	050814	dwg no	KU04C2x100J0G
chr	HANKE FENG	050814	size	A4
appr	SHI JUN	050814	type	CUSTOMER Drawing
sheet index	revision sheet	A 1		