

Excellent Integrated System Limited

Stocking Distributor

Click to view price, real time Inventory, Delivery & Lifecycle Information:

[FCI](#)
[NH04705000JOG](#)

For any questions, you can email us directly:
sales@integrated-circuit.com

PRODUCT NUMBER	PITCH
NHxx70x000JOG	5.00mm

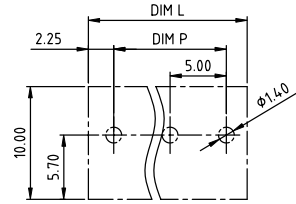
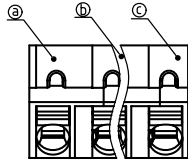

RECOMMENDED P.C.B LAYOUT
TOP VIEW

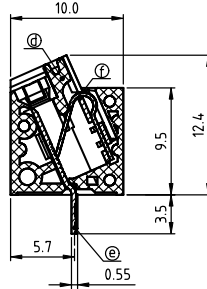
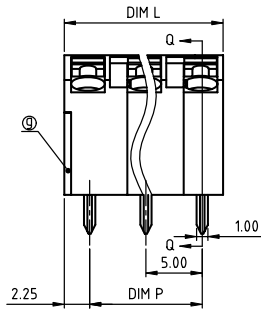

SECTION Q-Q

Material:

- Item A Terminal with cover of body: Thermoplastic (UL94V-0)
- Item B Terminal normal body: Thermoplastic (UL94V-0)
- Item C Terminal side body: Thermoplastic (UL94V-0)
- Item D Terminal lever: Thermoplastic (UL94V-0) Orange(RAL2011/P)
- Item E Female Contact: Brass, Tin Plated.
- Item F Spring clamp: Stainless steel
- Item G Terminal cover: Thermoplastic (UL94V-0)

Electrical:

- Voltage rating: cULus 300 V
- Current rating: 10A
- Wire range:
- Solid wire(AWG): 16-26
- Stranded wire(AWG): 16-26
- Wire strip length: 8-9 mm
- Withstanding Voltage: 1.6 KV
- Operating temperature: -40°C to +115°C
- Soldering temperature: 260°C ±5°C/5 Sec
- Safety Approval: cULus

N=Number of poles

Dim L=(N-1)×5.0+4.1		
Dim P=(N-1)×5.0		
POLES	DIM L	DIM P
1p	±0.10	
2p-6p	±0.10	±0.10
7p-12p	±0.20	±0.20
13p-18p	±0.30	±0.30
19p-24p	±0.40	±0.40

PART NO.: NH xx 70 x 000JO G

No. of poles	0	Color	Black (RAL9005)	RoHS compliant
End Stackable	2		Red (RAL3001/D)	(lead-4%)
01 1 poles	3		Orange(RAL2011/P)	In copper Alloy
02 2 poles	4		Yellow(RAL1018/A)	
...	...		Green(RAL6018/T)	
24 24 poles	5		Blue (RAL5015/A)	
	6		Grey(RAL7004/P)	
	8		White(RAL1102)	
	9		Multiple colors	
	C			

mat'l. code	surface	tolerance	projection	product family
	ASME Y14.5	ASME Y14.5	MM	TERMINAL BLOCK
ltr	ecn	no	dr	date
				tolerances unless otherwise specified
	angle	mm		title
	X±1°	X.±0.5		TERMINAL BLOCK
		X.X±0.3		SPRING CLAMP,66D WIRE INLET
		X.XX±0.1	scale	dwg no
	dr	EVIN ZHONG	060314	sheet 1 of 1
	enr	EVIN ZHONG	060314	size
	chr	HANKE FENG	060314	NHxx70x000JOG
	appd	SHI JUN	060314	A4
sheet	revision	A		type
index	sheet	1		CUSTOMER Drawing