

Excellent Integrated System Limited

Stocking Distributor

Click to view price, real time Inventory, Delivery & Lifecycle Information:

[FCI](#)
[TR02055000J0G](#)

For any questions, you can email us directly:

sales@integrated-circuit.com

PRODUCT NUMBER	PITCH
TRxx05x000J0G	5.00 mm

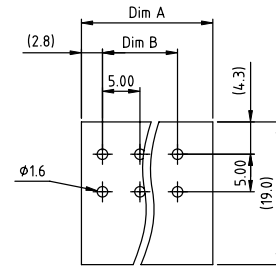
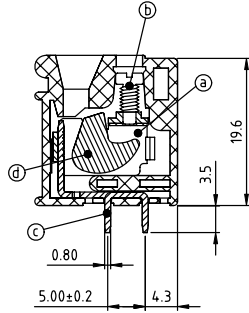
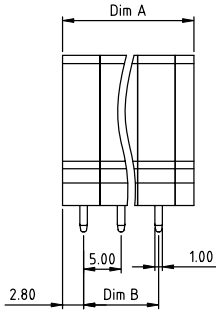
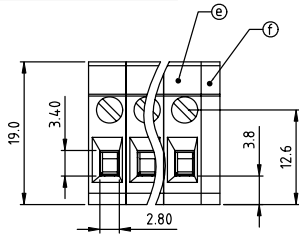

RECOMMENDED P.C.B LAYOUT
TOP VIEW

Material:

- Item ① Terminal body (metal housing): steel stamping Zinc plating
- Item ② Terminal screw: Steel Zinc plating "-" slot type
- Item ③ Contacts: Brass, Tin plated
- Item ④ Firm wire chunk: steel Zinc plating
- Item ⑤ Terminal (housing): Thermoplastic (UL94V-0)
- Item ⑥ Terminal cover: Thermoplastic (UL94V-0)

Electrical cULus

- Voltage rating: 300VAC
- Current rating: 20A
- Wire range:
- Solid wire (AWG): 12-22
- Stranded wire (AWG): 12-22
- Torque (Lb-In): 2.4
- Screw: M2.5
- Wire strip length: 10-11mm
- Withstanding Voltage: 1.6KV
- Operating temperature: -40°C to +115°C
- Soldering temperature: 260°C±5°C/5 Sec
- Safety Approval: cULus

N = Number of poles
Dim A = N × 5.0 + 2.5
Dim B = (N - 1) × 5.0

Poles	Tolerance
1p	±0.10
2p-6p	±0.20
7p-12p	±0.25
13p-18p	±0.35
19p-24p	±0.40

PART NO.: TR xx 0 5 x 0 00J0 G

End stackable	No. of poles	Body Color	RoHS compliant (lead-4%) In copper Alloy
0	2	Black (RAL9005)	
01	1 pole	Red (RAL3001/D)	
02	2 poles	Orange (RAL2011/P)	
...	...	4 Yellow (RAL1018/A)	
...	...	5 Green (RAL6018/T)	
24	24 poles	6 Blue (RAL5015/A)	
		8 Grey (RAL7035/D)	
		9 White (RAL1102)	
		C Green (RAL6018/U)	

mat'l. code	surface ASME Y14.5 ✓	tolerance ASME Y14.5	projection MM	product family TERMINAL BLOCK
ltr	ecn	no	dr	date
tolerances unless otherwise specified				title TERMINAL BLOCK
angles	X.±0.5		WIRE PROTECTOR, 90D WIRE INLET	
	X.X±0.3		dwg no	
X'±1'	X.XX±0.1		sheet 1 of 1	
dr	EVIN ZHONG	040114	size A4	
enrg	EVIN ZHONG	040114	TRxx05x000J0G	
chr	HANKE FENG	040114	type CUSTOMER Drawing	
appd	SHI JUN	040114		
sheet index	revision sheet	A 1		