

Excellent Integrated System Limited

Stocking Distributor

Click to view price, real time Inventory, Delivery & Lifecycle Information:

[FCI](#)
[V702115000J0G](#)

For any questions, you can email us directly:
sales@integrated-circuit.com

PRODUCT NUMBER	PITCH
V7xx11x000J0G	3.50 mm

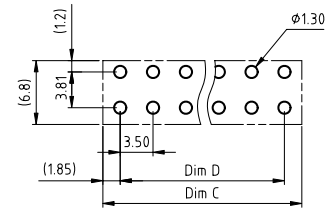
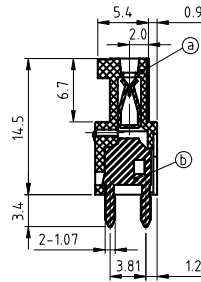
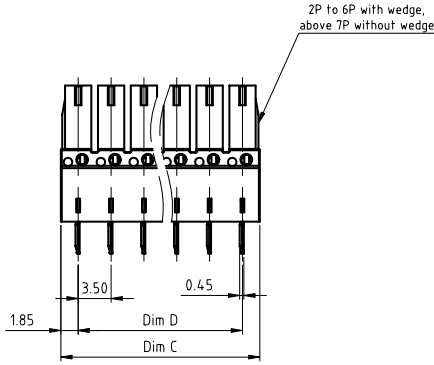
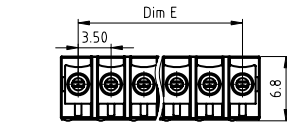

RECOMMENDED P.C.B. LAYOUT
TOP VIEW

Material:

- Item (a) Terminal body: Thermoplastic (UL94 V-0)
- Item (b) Female contact: PhBz(CuSn), Tin plated

Electrical cULus

- Voltage rating: 300VAC
- Current rating: 4A
- Withstanding Voltage: 1.6kv
- Operating temperature: -40°C to +115°C
- Soldering temperature: 260°C±5°C/5 Sec
- Safety Approval: cULus

N=Number of poles
Dim C=(N-1)×3.5+3.7
Dim D=(N-1)×3.5
Dim E=(N-1)×3.5

poles	Tolerance
2-5p	±0.10
6-10p	±0.15
11-15p	±0.20
16-20p	±0.25
21-24p	±0.30

PART NO.: V7 xx 11 x 0 00J0 G

Solid block	No. of poles	Color	RoHS compliant (lead<4%) In copper Alloy
0	2	Black (RAL9005)	
2	3	Red (RAL3001/D)	
03	4	Orange(RAL2011/P)	
...	5	Yellow(RAL1018/A)	
...	6	Green(RAL6018/T)	
24	7	Blue (RAL5015/A)	
	8	Grey(RAL7035/D)	
	9	White(RAL1102)	
	C	Green(RAL6018/U)	

mat'l. code		surface	tolerance	projection	product family
		ASME Y14.5	ASME Y14.5	ASME Y14.5	TERMINAL BLOCK
tr ecn no dr date		tolerances unless otherwise specified			title
		angles	X.±0.5	MM	TERMINAL BLOCK
		X'±1'	X.X±0.3	scale	PLUGGABLE PCB PLUG,VERTICAL
		dr	EVIN ZHONG 043014	FCI	dwg no sheet 1 of 1 size
		enrg	EVIN ZHONG 043014		V7xx11x000J0G A4
		chr	HANKE FENG 043014		type CUSTOMER Drawing
		appd	SHI JUN 043014		
sheet index	revision sheet	A 1			