



Distributor of EDAC Inc.: Excellent Integrated System Limited

Datasheet of 690-W04-260-013 - Connector Plug USB TypeA 4 Position Free Hanging (In-Line)

Contact us: sales@integrated-circuit.com Website: www.integrated-circuit.com

Excellent Integrated System Limited

Stocking Distributor

Click to view price, real time Inventory, Delivery & Lifecycle Information:

[EDAC Inc.](#)

[690-W04-260-013](#)

For any questions, you can email us directly:

sales@integrated-circuit.com

us: sales@integrated-circuit.com Website: www.integrated-circuit.com



THIS SERIES FULLY CONFORMS TO THE EUROPEAN UNION DIRECTIVES 2002/95/EC AND 2002/96/EC FOR ROHS COMPLIANCY.

Waterproof Connectors

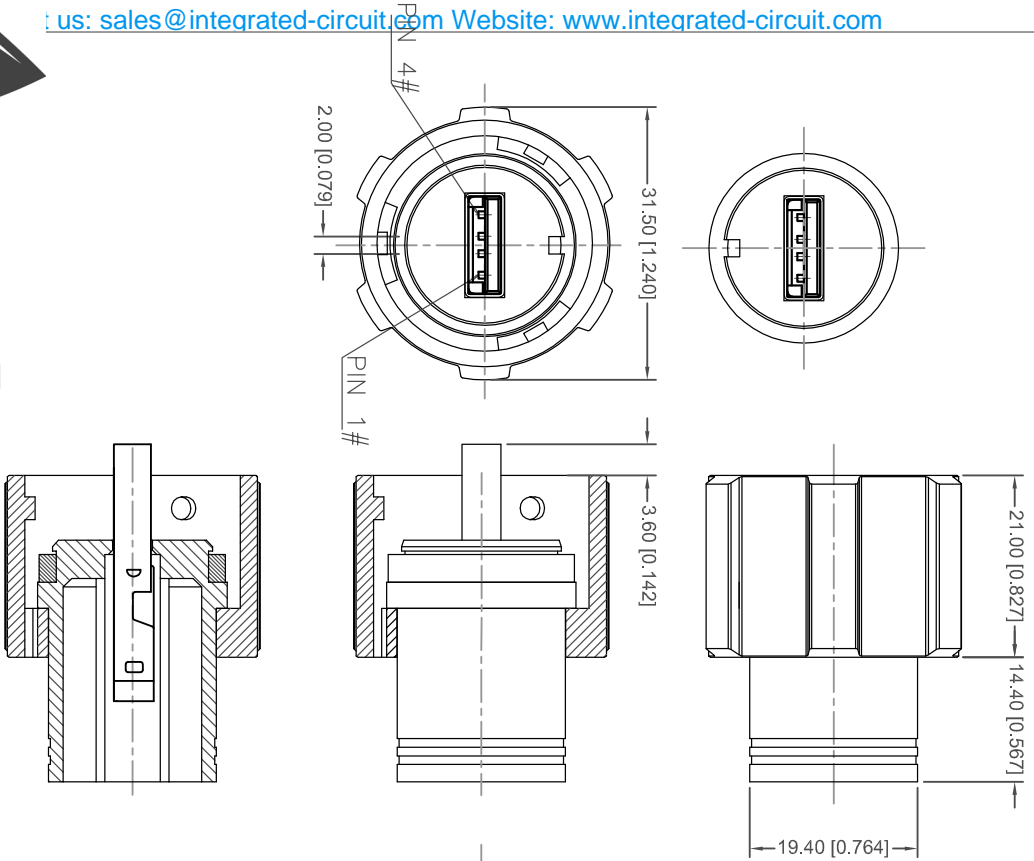

| TOLERANCE UNLESS OTHERWISE SPECIFIED IN MM: | ANGLE | X° |
|---|--------|----|
| 0.0 | 4.0/20 | |
| 0.00 | 4.0/10 | |
| 0.000 | 4.0/5 | |

THIS IS A C.A.D. GENERATED DRAWING DO NOT MAKE MANUAL REVISIONS TO MASTER.



| ISSUE NUMBER |
|---------------------------|
| ORIGINAL (1) |
| COLOR WHITE WAS BLACK (2) |
| ADD NOTES 3 & 4 |
| R.STA.MONICA JUN.18/2014 |

1. MATERIAL :
 - 1-1. EXTERNAL HOUSING : PBT UL94V-0 ; COLOR : BLACK
 - 1-2. EXTERNAL NUT : PBT UL94V-0 ; COLOR : BLACK
 - 1-3. O-RING : SILICONE ; COLOR : BROWN
 - 1-4. USB :
 - 1-4-1. HOUSING : PBT UL94V-0 ; COLOR : WHITE
 - 1-4-2. CONTACT : PHOSPHOR BRONZE.
 - 1-4-3. SHELL : SPTe

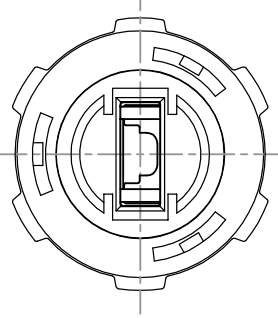

2. FINISH :

- 2-1. CONTACT : GOLD 3u" ON CONTACT AREA
SOLDER TAILS: TIN 100u"
- UNDER PLATE : NICKEL PLATING
- 2-2. SHELL: NICKEL OVER ALL
3. ELECTRICAL SPECIFICATIONS:
 - 3-1. RATED CURRENT : 1A
 - 3-2. RATED VOLTAGE : 30V
 - 3-3. WATER PROOF : IP67
4. ENVIRONMENTAL:
 - 4-1. OPERATING TEMPERATURE : -20°C~85°C

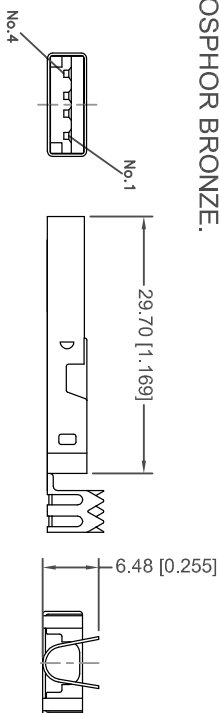

USB 4P (M)

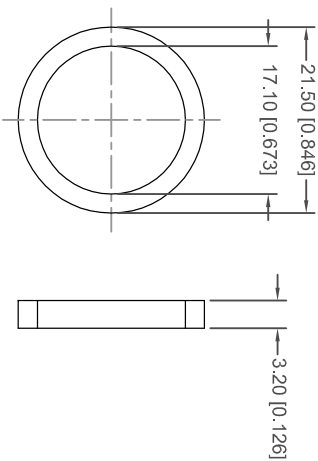

O-RING

WATERPROOF USB TYPE A, 4P (MALE)

EDAC INC
TORONTO, ONTARIO
CANADA

THESE DRAWINGS AND SPECIFICATIONS ARE THE PROPERTY OF EDAC INC. AND SHALL NOT BE REPRODUCED OR COPIED OR USED AS THE BASIS FOR THE MANUFACTURE OR SALE OF APPARATUS WITHOUT WRITTEN PERMISSION.

| | |
|-------------------------------------|-------------------|
| ACAD REFERENCE NO.: 690-W04-260-013 | |
| DRAWN: R.STA.MONICA | DATE: APR.07/2014 |
| CHECKED: | DATE: |
| PART NUMBER | SHEET 1 OF 1 |
| 690-W04-260-013 | |
| DRAWING NUMBER | ISSUE |
| 690-W04-260-013 | 2 |