

Excellent Integrated System Limited

Stocking Distributor

Click to view price, real time Inventory, Delivery & Lifecycle Information:

[FCI](#)
[AL06505300J0G](#)

For any questions, you can email us directly:
sales@integrated-circuit.com

PRODUCT NUMBER	PITCH
ALxxxx300J0G	N/A

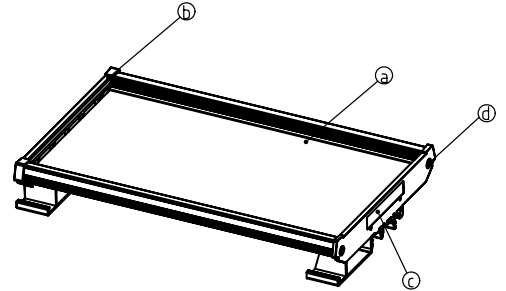
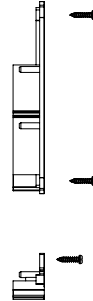
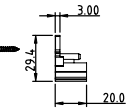
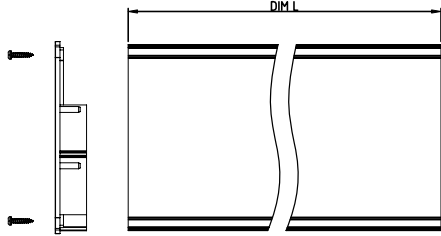
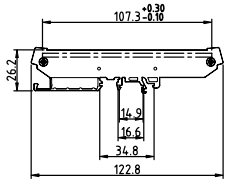

Materials

- Item a insulating body PVC (UL94V-0)
- Item b insulating side Cover (left) Thermoplastic (UL94V-0)
- Item c insulating side Cover (right) Thermoplastic (UL94V-0)
- Item d Screw(Pa2.8x8) Steel, Zinc plated

Remark

DIM L (Length of insulating body)=PCB Length-3.8mm
 PCB Width:107.05±0.05mm
 PCB thickness :1.6±0.10mm

PART NO.: AL xxxx x 3 00J0 G

PCB length 5 Green(RAL6018/T)
 0450 45.0mm
 0505 50.5mm

 4000 400.0mm
 0450 to 4000
 From 45.0mm to 400mm

Body Color
 RoHS compliant

mat'l. code	surface ASME Y14.5 ✓	tolerance ASME Y14.5	projection MM	product family TERMINAL BLOCK
ltr	ecn	no	dr	date
tolerances unless otherwise specified				title TERMINAL BLOCK ACCESSORIES, NON-INSTALLED SIDE COVER THE WIDTH OF PCB IS 107 MM
angles	0	X.±0.5	scale	
X'±1'	X.X±0.3	X.XX±0.1	sheet 1 of 1 size	
dr	HANKE FENG	072314	ALxxxx300J0G A4	
enr	HANKE FENG	072314	type	
chr	HANKE FENG	072314	CUSTOMER Drawing	
appd	SHI JUN	072314		
sheet index	revision sheet	A 1		