

## Excellent Integrated System Limited

Stocking Distributor

Click to view price, real time Inventory, Delivery & Lifecycle Information:

[FCI](#)  
[LD09P24A4GV00LF](#)

For any questions, you can email us directly:  
[sales@integrated-circuit.com](mailto:sales@integrated-circuit.com)

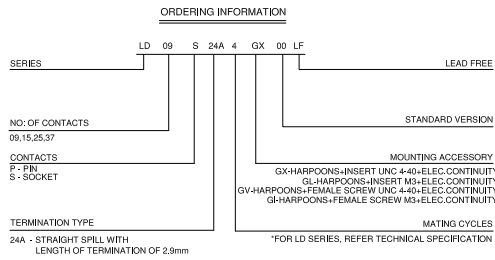
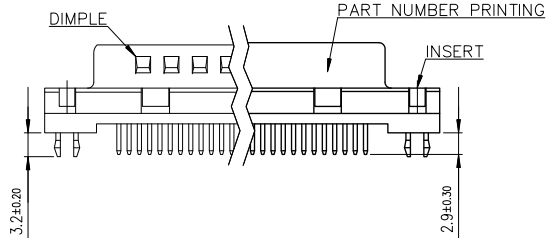
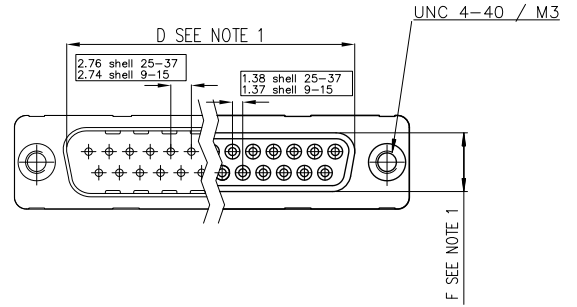
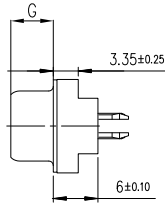
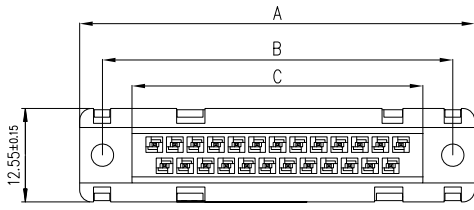

SHELL	A±0.38	B±0.12	C±0.10	D±0.25	E±0.07	F	G
09 P	30.81	24.99	16.96	16.79	10.96	8.35±0.12	5.90±0.15
09 S	30.81	24.99	16.96	16.21	10.96	7.89±0.13	6.17±0.12
15 P	39.14	33.32	25.18	25.12	19.18	8.35±0.12	5.90±0.15
15 S	39.14	33.32	25.18	24.54	19.18	7.89±0.13	6.17±0.12
25 P	53.03	47.04	39.12	38.84	33.12	8.35±0.12	5.70±0.25
25 S	53.03	47.04	39.12	38.25	33.12	7.89±0.13	6.17±0.12
37 P	69.32	63.50	55.68	55.30	49.68	8.35±0.12	5.70±0.25
37 S	69.32	63.50	55.68	54.71	49.68	7.89±0.13	6.17±0.12

**NOTES:**

- 1) INSIDE DIMENSIONS FOR THE MALE CONNECTOR AND OUTSIDE DIMENSIONS FOR THE FEMALE CONNECTOR
- 2) DIMPLE IS PROVIDED ONLY FOR THE MALE CONNECTOR
- 3) THE GENERAL VIEW IS FOR THE OPTION GX/GL

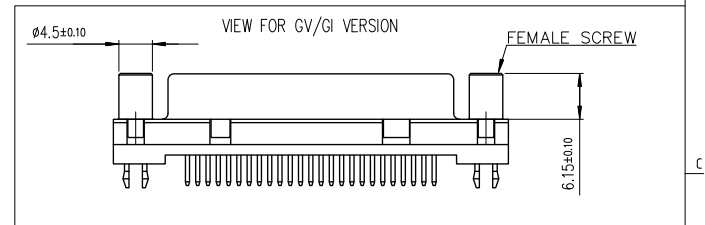

mat'l. code	surface	tolerance	projection	product family
-	ISO 1302	ISO 406 ISO 1101	MM	D-SUB
lfr	ecn no	dr	date	title
A	-	AB	2014-08-01	DELTA-D STRAIGHT SPILL
B	ELX-1-19184	AB	2014-10-24	LD SERIES
dr	engr	chr	appd	scale: 2:1
ALIAS BABU	ALIAS BABU	MITHUN PAUL	BIJU K PAUL	FCI
2014-08-01	2014-10-24	2014-10-24	2014-10-24	dwg no
				10130912
sheet index	revision sheet	B 1	B 2	type
				Product Customer Drawing

## TECHNICAL SPECIFICATION

### PHYSICAL CHARACTERISTICS

INSULATOR MATERIAL : BLACK THERMOPLASTIC UL94 V0

CONTACTS MATERIAL : COPPER ALLOY

CONTACTS PLATING : GOLD FLASH OVER NICKEL

SHELL PLATING : NICKEL/TIN

### ELECTRICAL CHARACTERISTICS

RATED VOLTAGE : 250V

RATED CURRENT : 5 A

CONTACT RESISTANCE :  $\leq 25m\Omega$

INSULATION RESISTANCE :  $\geq 5000 M\Omega$

### MECHANICAL CHARACTERISTICS

MATING CYCLES : 50 MINIMUM

RETENTION AGAINST TORQUE : 0.5Nm

### ENVIRONMENTAL CHARACTERISTICS

OPERATING TEMPERATURE : -55°C TO +105°C

### PACKING SPECIFICATION

REFER GS-14-2405

MATING VIEW FOR FEMALE CONNECTOR

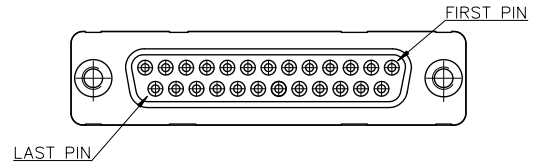

MATING VIEW FOR MALE CONNECTOR

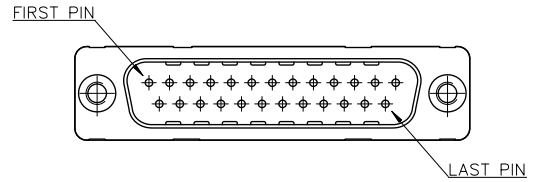

PC card drilling dimensions(after plating)  
(thickness 1.60±0.20mm)

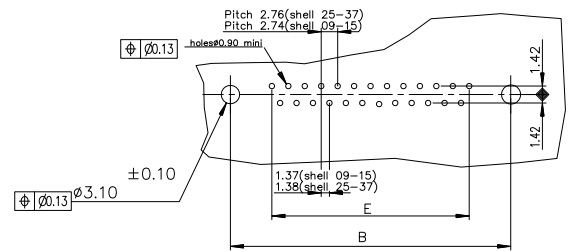

mat'l. code	-	surface	ISO 1302	tolerance	ISO 406	ISO 1101	projection	product family	D-SUB
lfr	ecn	no	dr	date	tolerances unless otherwise specified		MM	title	
B					angles	linear		scale 2:1	DELTA-D STRAIGHT SPILL LD SERIES
					0'±2'	.000±0.1		dwg no	sheet 2 of 2
			dr	ALIAS BABU	2014-08-01			10130912	A3
			engr	ALIAS BABU	2014-10-24			type	Product Customer Drawing
			chr	MITHUN PAUL	2014-10-24				
			ppd	BIJU K PAUL	2014-10-24				
sheet index		revision sheet							