

## Excellent Integrated System Limited

Stocking Distributor

Click to view price, real time Inventory, Delivery & Lifecycle Information:

[B&K Precision](#)  
[CT2908-1](#)

For any questions, you can email us directly:

[sales@integrated-circuit.com](mailto:sales@integrated-circuit.com)

THIS IS ISSUED IN STRICT CONFIDENCE THAT IT IS NOT USED AS A BASIS FOR MANUFACTURE OR SALE AND THAT IT IS NOT COPIED, REPRINTED OR DISCLOSED TO A THIRD PARTY EITHER WHOLLY OR IN PART WITHOUT THE PRIOR WRITTEN CONSENT OF CAL TEST ELECTRONICS, INC.

1. 4mm SAFETY BANANA JACK w/M3 THREADED HOLE.
2. SPECIFICATIONS:  
INSULATOR: POLYAMIDE (NYLON).  
CONTACT: BRASS, NICKEL PLATED  
LOCKING NUT: BRASS, NICKEL PLATED
3. RATING:  
VOLTAGE: 1,000 V CAT III/600 V CAT IV P2 (IEC61010-031)  
CURRENT: 36 A MAX.  
RESISTANCE: <12 mΩ.  
TEMPERATURE: -20° C TO +80° C.
4. MOUNTING HOLE: REF. DIAGRAM.
5. INSULATOR THREAD, M12x0.75, MAX. TORQUE 1.7 ft-lb (2.3 Nm) AT 20° C.
6. MAXIMUM PANEL THICKNESS: .40 (10).
7. RECOMMENDED ASSEMBLY TOOL: CT2246A.

**PART NUMBER**

**CT2908-#**

COLOR: 0 - BLACK  
1 - BROWN  
2 - RED  
3 - ORANGE (SPECIAL)  
4 - YELLOW  
5 - GREEN  
6 - BLUE  
7 - PURPLE  
8 - GRAY  
9 - WHITE

CONFORMITY TO RoHS 2002/95/EC

**REVISIONS**

| REV. | DESCRIPTIONS                                                                 | DATE    | APPROVED |
|------|------------------------------------------------------------------------------|---------|----------|
| -    | CLASS A RELEASED                                                             | 7/12/99 |          |
| A    | ADDED CAGE CODE                                                              | 6/10/05 |          |
| B    | COLOR ORANGE ADDED AS SPECIAL; REVISED NOTE 5 WITH NUT TORQUE SPECIFICATION. | 6/2/09  |          |

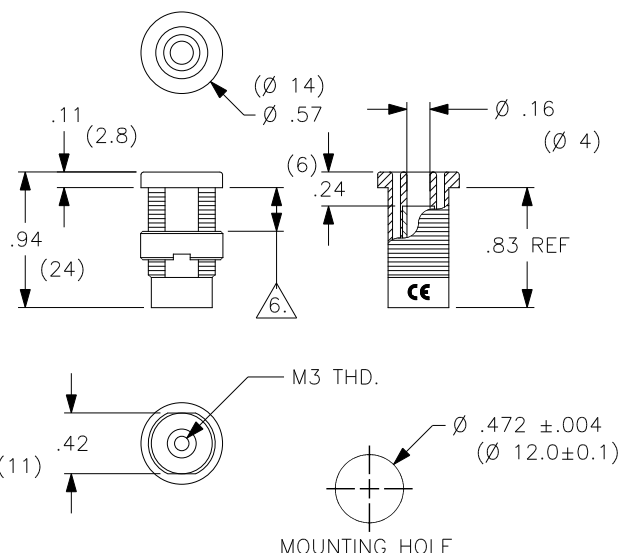

**THIRD ANGLE PROJECTION**

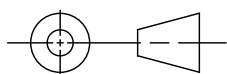

UNLESS OTHERWISE SPECIFIED  
DIMENSIONS ARE IN INCHES  
TOLERANCES ARE:  
FRACTIONS DECIMALS  
± 1/32 .XX ± .02  
.XXX ± .005  
DO NOT SCALE DRAWING

**CONTRACT NO.**

| APPROVALS       | DATE    |
|-----------------|---------|
| DRAWN WDH       | 7/12/99 |
| CHECKED         |         |
| ENGR.           |         |
| DESIGN ACTIVITY |         |

**Cal Test Electronics**

22820 Savi Ranch Parkway  
Yorba Linda, CA 92887-4610

**TITLE**

**4mm SAFETY JACK, PANEL  
w/M3 THREADED HOLE**

| SIZE      | CAGE CODE | DWG. NO.     | REV. |
|-----------|-----------|--------------|------|
| A         | 43F45     | P290800      | B    |
| SCALE 1:1 |           | SHEET 1 OF 1 |      |