



Distributor of Molex Connector Corporation: Excellent Integrated System Limited
Datasheet of 0190030129 - Connector Quick Connect Receptacle 18-22 AWG 0.187"
(4.75mm) Crimp

Contact us: sales@integrated-circuit.com Website: www.integrated-circuit.com

Excellent Integrated System Limited

Stocking Distributor

Click to view price, real time Inventory, Delivery & Lifecycle Information:

[Molex Connector Corporation](#)
[0190030129](#)

For any questions, you can email us directly:
sales@integrated-circuit.com



Distributor of Molex Connector Corporation: Excellent Integrated System Limited

Datasheet of 0190030129 - Connector Quick Connect Receptacle 18-22 AWG 0.187"

(4.75mm) Crimp

SD-19003-001

www.integrated-circuit.com Website: www.integrated-circuit.com

MATERIAL NUMBER	ENGINEERING NUMBER	FITS MALE TAB SIZE	"A" MAX.	"C" MAX.	"E" MAX.	CARRIER CONFIGURATION
190030126	AA-2202V	.187X.020	.78/19.8	.316/8.03	.160/4.06	LOOSE PIECE
190030127	AA-2202VT	.187X.020	.78/19.8	.316/8.03	.160/4.06	TAPE MOUNT
190030128	AA-2202VC	.187X.020	.78/19.8	.316/8.03	.160/4.06	PLASTIC STRIP
190030129	AA-2203V	.187X.032	.78/19.8	.316/8.03	.160/4.06	LOOSE PIECE
190030130	AA-2203VT	.187X.032	.78/19.8	.316/8.03	.160/4.06	TAPE MOUNT
190030131	AA-2203VC	.187X.032	.78/19.8	.316/8.03	.160/4.06	PLASTIC STRIP
190030005	AA-2201VN	.250X.032	.86/21.8	.380/9.65	.180/4.57	LOOSE PIECE
190030007	AA-2201VNT	.250X.032	.86/21.8	.380/9.65	.180/4.57	TAPE MOUNT
190030111	AA-2201VNC	.250X.032	.86/21.8	.380/9.65	.180/4.57	PLASTIC STRIP

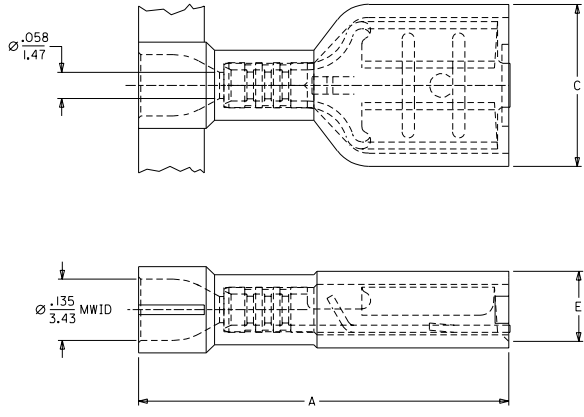

- NOTES:
- ① MATERIAL: TERMINAL: BRASS .016/0.41.
PLATING: ELECTRO-TIN
INSULATION: NYLON 6/6 94V-0 RATING
COLOR: RED
 - MWID = MAXIMUM WIRE INSULATION DIAMETER.
 - ALL DIMENSIONS = INCHES/MM

SALES DRAWING

REV'D NYLON COLOR EC NO. ETC2004-0101 DRW/HEB 03/11/21 CHK/HEB 03/11/21 APPR/RWD 03/11/21 B	QUALITY SYMBOLS MAJOR ∇ = 0 CRITICAL ∇ / = 0 REV DESCRIPTION	GENERAL TOLERANCES: (UNLESS SPECIFIED)		SCALE NO: NE	DESIGN UNITS <input type="checkbox"/> mm <input checked="" type="checkbox"/> INCH	THIRD ANGLE PROJECTION	DIMENSIONS: <input type="checkbox"/> mm <input checked="" type="checkbox"/> INCH <input type="checkbox"/> mm ONLY	SHT REV	
		4 PLACES ± 0.005	3 PLACES ± 0.005	2 PLACES ± 0.013	1 PLACE ± 0.025	DRAWN BY & DATE HEB 01/06/07	CHECKED BY & DATE RWD 01/06/07	APPROVED BY & DATE RWD 01/06/07	TITLE: FID FEMALE, INSULKRIMP 94V-0 MATERIAL 22-18 AWG
		ANGLAR: $\pm 1/2^\circ$		CAD FILENAME S19003001.DGN	MATERIAL NO. SEE TABLE	DRAWING NO. SD-19003-001	SHEET NO. 1 OF 1	SIZE B	
		DRAFT WHERE APPLICABLE MUST REMAIN WITHIN DIMENSIONS							THIS DRAWING CONTAINS INFORMATION THAT IS PROPRIETARY TO MOLEX INCORPORATED AND SHOULD NOT BE USED WITHOUT WRITTEN PERMISSION.