

Excellent Integrated System Limited

Stocking Distributor

Click to view price, real time Inventory, Delivery & Lifecycle Information:

[Molex Connector Corporation](#)
[0347930082](#)

For any questions, you can email us directly:

sales@integrated-circuit.com

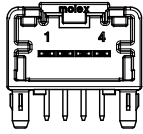

4 CIRCUIT RIGHT ANGLE HEADER
POLARIZATION OPTION A

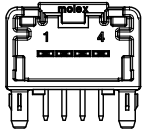

4 CIRCUIT RIGHT ANGLE HEADER
POLARIZATION OPTION B

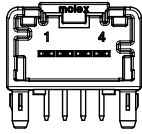

4 CIRCUIT RIGHT ANGLE HEADER
POLARIZATION OPTION C

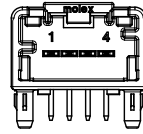

4 CIRCUIT RIGHT ANGLE HEADER
POLARIZATION OPTION D

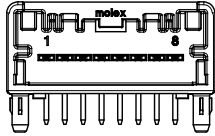

8 CIRCUIT RIGHT ANGLE HEADER
POLARIZATION OPTION A

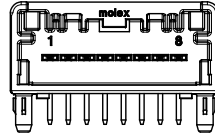

8 CIRCUIT RIGHT ANGLE HEADER
POLARIZATION OPTION B

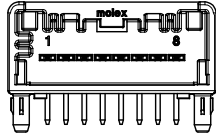

8 CIRCUIT RIGHT ANGLE HEADER
POLARIZATION OPTION C

MINI50 RIGHT ANGLE HEADER ASSEMBLIES

MATERIAL NUMBER		CONFIGURATION	CIRCUIT	POL	COLOR	BLADE PLATING	MATING COMPONENT	
TUBE PACKAGING PK-31301-688	TRAY PACKAGING PK-31301-440						UN-BRIDGED	BRIDGED
34793-9040	34793-0040	USCAR	4	A	BLACK	TIN OVER NICKEL	34791-0040	34791-0140
34793-9041	34793-0041	USCAR	4	B	GRAY	TIN OVER NICKEL	34791-0041	34791-0141
34793-9042	34793-0042	USCAR	4	C	DARK GRAY	TIN OVER NICKEL	34791-0042	34791-0142
34793-9043	34793-0043	USCAR	4	D	GREEN	TIN OVER NICKEL	34791-0043	34791-0143
34793-9080	34793-0080	USCAR	8	A	BLACK	TIN OVER NICKEL	34791-0080	34791-0180
34793-9081	34793-0081	USCAR	8	B	GRAY	TIN OVER NICKEL	34791-0081	34791-0181
34793-9082	34793-0082	USCAR	8	C	DARK GRAY	TIN OVER NICKEL	34791-0082	34791-0182

NOTES: VALID UNLESS OTHERWISE SPECIFIED

- GENERAL:
 - APPLICATION SPECIFICATION SEE: AS-34791-020
 - PRODUCT SPECIFICATION SEE: PS-34791-020
 - PACKAGING SPECIFICATION PER MOLEX DRAWING; SEE CHART
 - SOLDERABILITY PER SMES-152
 - PARTS MUST BE IN COMPLIANCE TO MOLEX CHEMICAL SUBSTANCES FOR PRODUCTS AND PACKAGING SPECIFICATION: DEHS-699000-300
 - DATA MUST BE SUBMITTED UNDER THE MOLEX PART NUMBER TO IHDS (COMPANY ID#13255)
 - FLAMMABILITY REQUIREMENT: PER ISO3795 OR GM3191
 - VISUAL DEFECTS SHALL MEET COSMETIC STANDARD PS-45499-002 (Class B)
- DESIGN - MATERIALS:
 - SHROUD (PLASTIC HOUSING) SPS 30% GF, 20% REGRND MAX PER WEIGHT
 - BLADES:
 - BASE METAL: C260 BRASS
 - PLATING REQUIREMENTS:
 - TIN OVER NICKEL
 - UNDERPLATING
 - OVERALL NICKEL
 - OVERPLATING
 - OVERALL TIN
- DESIGN - GEOMETRY:
 - THIS IS A 100% CAD GENERATED PART. THE CAD MATHEMATICAL DATA IS THE MASTER FOR THIS PART. FOR DIMENSIONAL OR ANY INFORMATION NOT SHOWN ON THIS DRAWING, ANALYZE THE CAD MODEL.
 - GEOMETRIC DIMENSIONS AND TOLERANCES PER ASME Y14.5M - 2009
 - GENERAL TOLERANCES:
 - LINEAR: SEE TITLE BLOCK
 - ANGULAR: 13°
 - EDGES AND UNDIMENSIONED DETAILS PER ISO1575
 - CORNERS SHOWN AS SHARP TO BE R 0.1 MAX
 - LETTERING SHALL BE 0.10 MAX RAISED. THIS INCLUDES RECYCLING CODE, PLANT AND CAVITY ID, VENDOR ID, AND CIRCUIT ID.

LAST BALLOON ON DRAWING:
②
DELETED BALLOONS:
①

DARK GRAY POL C EC NO. IJL/2004-0861 ITEDRWS/PLM/CUSA 2011/11/25 CHKD: APPR:RUM/ML 2011/11/25 DESIGNED BY:	QUALITY SYMBOLS	GENERAL TOLERANCES (UNLESS SPECIFIED)	DIMENSION STYLE	SCALE	DESIGN UNITS	THIRD ANGLE PROJECTION	
	$\nabla=0$ $\nabla=0$ $\nabla=0$	mm INCH 4 PLACES ±--- ±--- 3 PLACES ±--- ±--- 2 PLACES ±0.20 ±--- 1 PLACE ±0.20 ±--- ANGULAR ±--- ±---	MM ONLY 5:1 METRIC	DRAWN BY: JDUNA J DATE: 2010/06/21 CHECKED BY: BDICK DATE: 2010/06/21 APPROVED BY: SMARCEAU DATE: 2011/11/21	TITLE: MINI 50 SINGLE ROW R/A HEADER ASSEMBLY SALES DRAWING	MOLEX MOLEX INCORPORATED	SHEET NO. 1 OF 3
	DRAFT WHERE APPLICABLE MUST REMAIN WITHIN DIMENSIONS		MATERIAL NO. SEE TABLE	DOCUMENT NO. SD-34793-001			
	THIS DRAWING CONTAINS INFORMATION THAT IS PROPRIETARY TO MOLEX INCORPORATED AND SHOULD NOT BE USED WITHOUT WRITTEN PERMISSION						

4 CKT RIGHT ANGLE HEADER

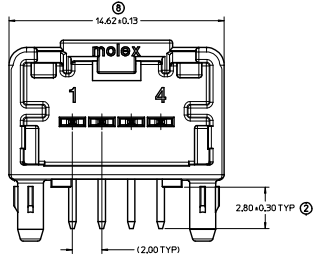
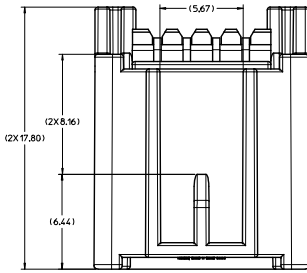

PCB LAYOUT
CONNECTOR MATE SIDE

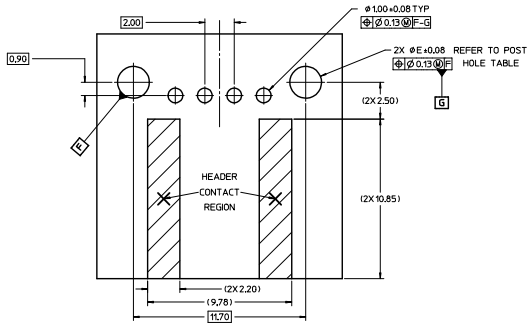

HEADER TO PCB
FLUSH MOUNT

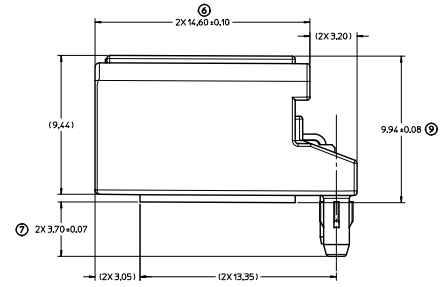
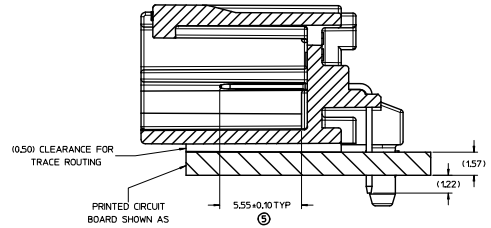

POST HOLE TABLE

	DM 'E'
PRESS FIT	2.15
DROP IN	2.55

DARK GRAY POL C ELC NO. UAU04L-0861 DRAWING NO. 201111/2 CHGCD: APPROVAL: 201111/2 ECU	QUALITY SYMBOLS	GENERAL TOLERANCES (UNLESS SPECIFIED)	DIMENSION STYLE MM ONLY	SCALE 8:1	DESIGN UNITS METRIC	THIRD ANGLE PROJECTION	
	∇=0 ∇=0 ∇=0	4 PLACES ±--- ±--- 3 PLACES ±--- ±--- 2 PLACES ±0.10 ±--- 1 PLACE ±0.20 ±--- ANGULAR ±---°	mm INCH ±--- ±--- ±--- ±--- ±--- ±--- ±--- ±---	DRAWN BY JDUNA J 2010/06/21	DATE 2010/06/21	TITLE MINI 50 SINGLE ROW R/A HEADER ASSEMBLY SALES DRAWING	MOLEX INCORPORATED
	DRAFT WHERE APPLICABLE MUST REMAIN WITHIN DIMENSIONS	MATERIAL NO. SEE TABLE	OCCUPANT NO. SD-34793-001	SHEET NO. 2 OF 3	THIS DRAWING CONTAINS INFORMATION THAT IS PROPRIETARY TO MOLEX INCORPORATED AND SHOULD NOT BE USED WITHOUT WRITTEN PERMISSION		

8 CKT RIGHT ANGLE HEADER

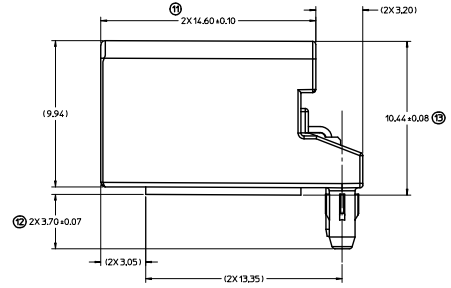
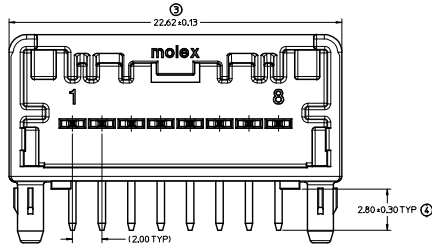
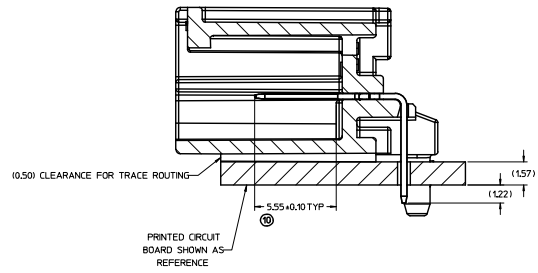
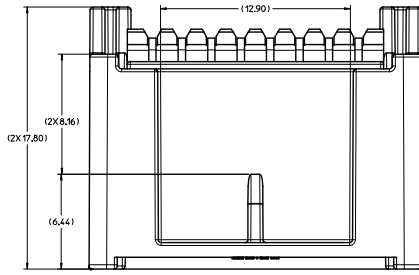

PCB LAYOUT
CONNECTOR MATE SIDE

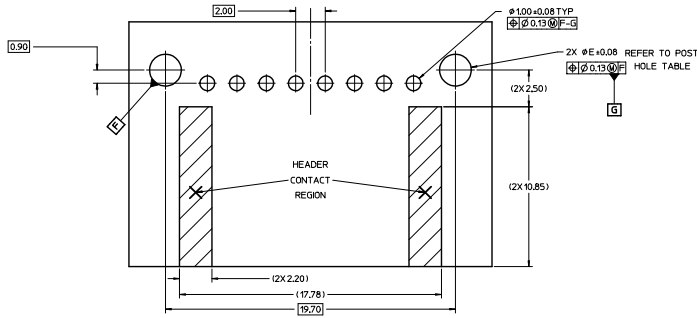

POST HOLE TABLE

	DIM E'
PRESS FIT	2.15
DROP IN	2.55

QUALITY SYMBOLS	GENERAL TOLERANCES (UNLESS SPECIFIED)	DIMENSION STYLE		SCALE	DESIGN UNITS	THIRD ANGLE PROJECTION
		MM ONLY	INCH			
$\nabla = 0$	4 PLACES ± --- ± ---	MM	INCH	8:1	METRIC	THIRD ANGLE PROJECTION
$\nabla = 0$	3 PLACES ± --- ± ---	MM ONLY	INCH	8:1	METRIC	THIRD ANGLE PROJECTION
$\nabla = 0$	2 PLACES ± 0.10 ± ---	MM ONLY	INCH	8:1	METRIC	THIRD ANGLE PROJECTION
$\nabla = 0$	1 PLACE ± 0.20 ± ---	MM ONLY	INCH	8:1	METRIC	THIRD ANGLE PROJECTION
$\nabla = 0$	0 PLACE ± --- ± ---	MM ONLY	INCH	8:1	METRIC	THIRD ANGLE PROJECTION
	ANGULAR ± --- °	MM ONLY	INCH	8:1	METRIC	THIRD ANGLE PROJECTION
	DRAFT WHERE APPLICABLE MUST REMAIN WITHIN DIMENSIONS	MM ONLY	INCH	8:1	METRIC	THIRD ANGLE PROJECTION

MINI 50 SINGLE ROW
R/A HEADER ASSEMBLY
SALES DRAWING

molex

DOCUMENT NO. SD-34793-001

SHEET NO. 3 OF 3

SEE CHART
THIS DRAWING CONTAINS INFORMATION THAT IS PROPRIETARY TO MOLEX
INCORPORATED AND SHOULD NOT BE USED WITHOUT WRITTEN PERMISSION