

Excellent Integrated System Limited

Stocking Distributor

Click to view price, real time Inventory, Delivery & Lifecycle Information:

[FCI](#)
[10112684-G03-05ALF](#)

For any questions, you can email us directly:
sales@integrated-circuit.com

10112684 - X XX-YY Z LF

INDICATES THAT PRODUCT IS RoHS COMPATIBLE. SEE NOTE 3

PACKAGING :

- A = Tape and reel with Pick-up cap. See GS-14-1516 As available
- U = Tube without Pick-up cap. Only for contacts qty from 4 to 25. See GS-14-1551
- Blank = Bli box for contacts qty 2 and 3 See note 5

CONTACTS QTY : 02 to 25 = N

STYLE	01	02	03	04
DIM C	3.2	2.0	4.0	7.0
POST LENGTH				

PLATING : G= 0.76µ Gold/GXT on mating area
 2-6µ Pure Tin on solder area
 F= Gold flash on mating area
 2-6µ pure Tin on solder area
 T= 2-6µ pure Tin on mating area
 2-6µ pure Tin on solder area
 All with 1.27 Ni underplating

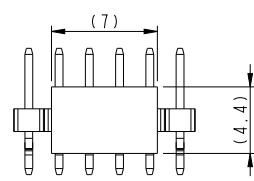
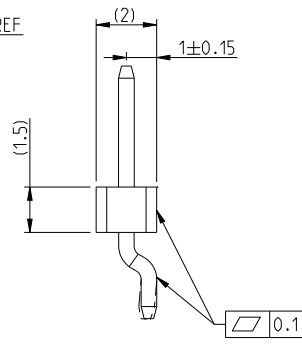
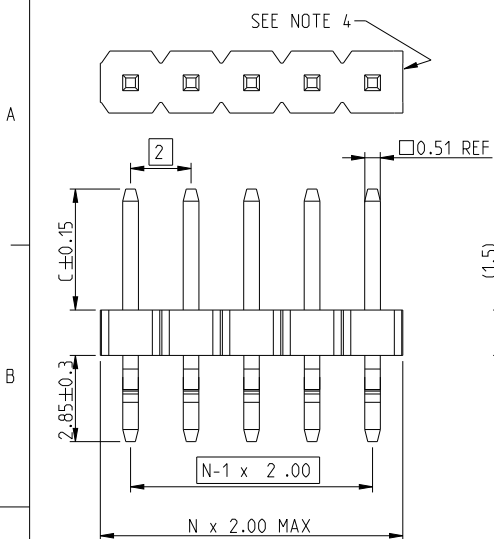

VIEW WITH PICK-UP CAP
SCALE 4:1

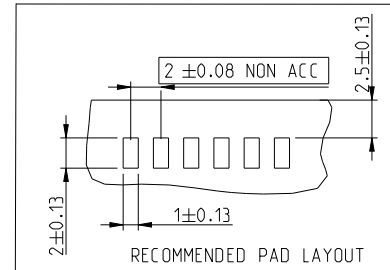

- NOTES :
- 1- MATERIALS :
 BODY : High Temp thermoplastic 30% GF, COLOR BLACK UL94 V-0
 PIN : COPPER ALLOY
 - 2- 7N MIN PIN RETENTION IN EITHER DIRECTION
 - 3- RoHS COMPATIBLE PRODUCT SPECIFICATION :
 a- PLATING : LF means the product is Lead Free.
 2µ MIN matte Tin over 1.27µ Nickel underplating.
 b- MANUFACTURING PRODUCT SPECIFICATION :
 Housing will withstand exposure to 260°C peak temperature for 30 secondes in a convection infra-red or vapor phase oven.
 c- LABELLING :
 Meets packaging specs as per GS-14-920
 d- LEGAL STATMENT : See GS-47-0004
 - 4- ONE TIP OF BODY MIGHT BE WITHOUT INDENTS AS PER EXTREMITY OF MOLDED BODY.
 - 5- MINIMUM QUANTITY IN BLI BOX : 500

spec ref	GS-12-652	dr	A Perreux	20140208	projection	mm	size	A3	scale	8:1	
tolerance std	ISO 406 ISO 1101	TOLERANCES UNLESS OTHERWISE SPECIFIED	eng	J Dallard	20150907			ecn no	ELX-F21864-1	rel level	Released
ISO 1302	linear	0.X ± 0.30 0.XX ± 0.13 0.XXX ± 0.05	chr	Laurent Mullin	20150907						
ISO 1302	angular	0° ± P	appr	J M Maire	20150907						
surface	✓	angular	0° ± P	www.fci.com	product family	UNSHROUDED HEADER SMT SIMPLE ROW	eng no	10112684	rev	E	
cat. no.		Product - Customer Drw		sheet 1 of 1							

Copyright FCI