

## Excellent Integrated System Limited

Stocking Distributor

Click to view price, real time Inventory, Delivery & Lifecycle Information:

[FCI](#)

[51710-031LF](#)

For any questions, you can email us directly:

[sales@integrated-circuit.com](mailto:sales@integrated-circuit.com)

Tous droits strictement réservés. Reproduction ou communication à des tiers interdite sous quelque forme que ce soit sans autorisation écrite du propriétaire. Propriété de C.FCI. Droits de reproduction FCI.

All rights strictly reserved. Reproduction or issue to third parties in any form whatever is not permitted without written authority from the proprietor. Property of FCI. Copyright FCI.



PRODUCT NO.	ROWS	POWER		SIGNAL				POWER		
		E1	P1	P2	1	2	3	4	P3	P4
51710-031-- NOTE ③	D C B A									

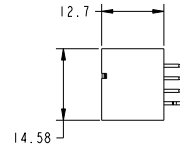
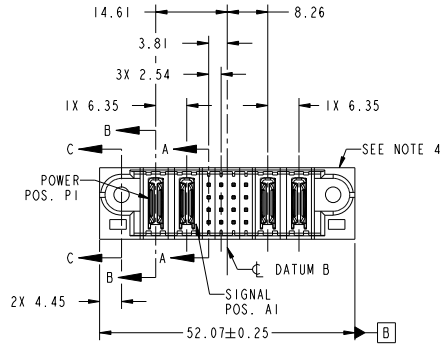

CODE	DIM "M" MATING LENGTH	CONTACT TYPE
PA	[N/A]	POWER
H	[5.59]	SIGNAL
HA	[N/A]	HOLD-DOWN
E	[6.86]	SIGNAL

mat'l code				tolerances unless otherwise specified		CUSTOMER	
ltr	ecn no.	dr	date	linear	0.X ±0.5	COPY	www.fciconnect.com
A	DG08-0305	JW	08/14/08	projection	0.XX ±0.25	title	2P + 16S + 2P
B	DG08-0273	JW	12/05/08	angles	0.XXX ±0.1	VERTICAL SOLDER HEADER	
				dr	0° ±2°	product family	PwrBlade
				enr		size	dwg no
				chr	JULIA WANG 08/14/08	scale	51710-031
				oppd	JEROME CHEN 08/14/08		213
sheet index	revision sheet	B 1	B 2	B 3	B 4		1 of 4

Pro/E

cage code 22526

Tous droits strictement réservés. Reproduction ou communication à des tiers interdite sous quelque forme que ce soit sans autorisation écrite du propriétaire. Propriété de FCI. Droits de reproduction FCI.

All rights strictly reserved. Reproduction or issue to third parties in any form whatever is not permitted without written authority from the proprietor. Property of FCI. Copyright FCI.



PRODUCT NUMBER  
51710-031--  
NOTE 3

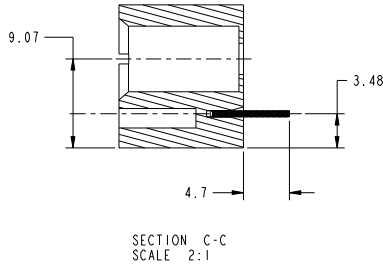
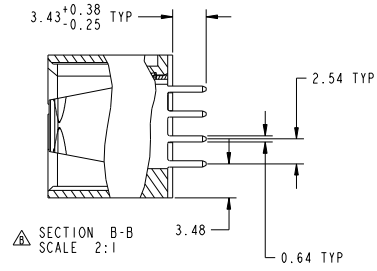
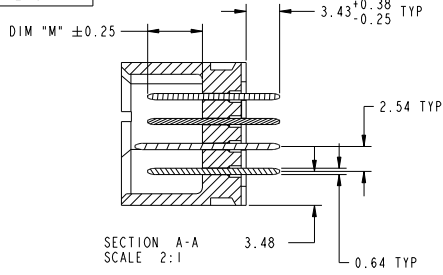

mat'l code				tolerances unless otherwise specified		CUSTOMER		FCI	
ltr	ecm no.	dr	date	linear	0.X ±0.5	COPY	www.fciconnect.com		
B					0.XX ±0.25	projection		2P + 16S + 2P	
				angles	0.XXX ±0.1			VERTICAL SOLDER HEADER	
					0° ±2°	MM		product family	PwrBlade
		dr	JULIA WANG	08/14/08		size	A	dwg no	51710-031
		engr	JEROME CHEN	08/14/08		scale	1:1	code	213
		chr	GARY HSIEH	08/14/08				sheet	2 of 4
		oppd	JOSEPH HSIA	08/14/08					
sheet index	revision sheet							cage code	22526

Pro/E

Tous droits strictement réservés. Reproduction ou communication à des tiers interdite sous quelque forme que ce soit sans autorisation écrite du propriétaire. Propriété de FCI. Droits de reproduction FCI.



All rights strictly reserved. Reproduction or issue to third parties in any form whatever is not permitted without written authority from the proprietor. Property of FCI. Copyright FCI.

PRODUCT NUMBER  
51710-031...  
NOTE 3

1 | 2 | 3 | 4

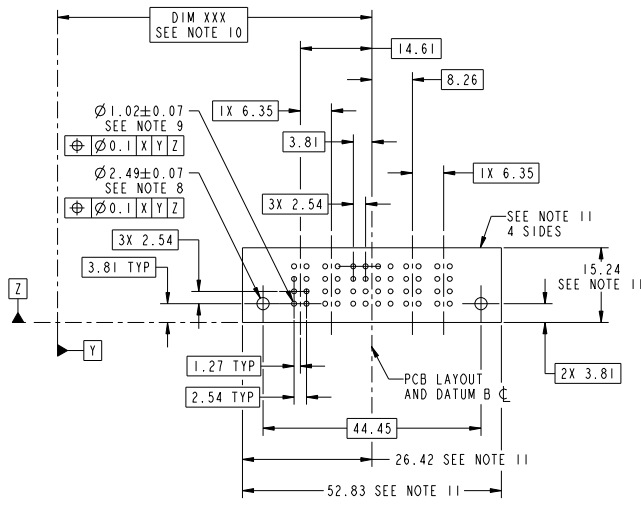

mat'l code				tolerances unless otherwise specified		CUSTOMER		FCI		www.fciconnect.com	
ltr	ecm no.	dr	date	linear	0.X ±0.5	COPY		projection		title	
B					0.XX ±0.25	MM		A		2P + 16S + 2P VERTICAL SOLDER HEADER	
				angles	0° ±2°	scale		1:1		product family PwrBlade	
				dr	JULIA WANG 08/14/08	size		A		code 213	
				engr	JEROME CHEN 08/14/08	dwg no		51710-031		sheet 3 of 4	
				chr	GARY HSIEH 08/14/08	scale		1:1			
				oppd	JOSEPH HSIA 08/14/08						
sheet index	revision sheet									cage code	22526

1 | 2 | 3 | 4

Pro/E

Tous droits strictement réservés. Reproduction ou communication à des tiers interdite sous quelque forme que ce soit sans autorisation écrite du propriétaire. Propriété de FCI. Droits de reproduction FCI.

All rights strictly reserved. Reproduction or issue to third parties in any form whatever is not permitted without written authority from the proprietor. Property of FCI. Copyright FCI.

PRODUCT NUMBER  
51710-031...  
NOTE 3

NOTES:

1. DIMENSIONS AND TOLERANCES ARE IN ACCORDANCE WITH ASME Y14.5M, 1994 UNLESS OTHERWISE SPECIFIED.

CONNECTOR NOTES:

- ② HOUSING MATERIAL: UL 94 V-0 GLASS FILLED HIGH-TEMP THERMOPLASTIC  
POWER CONTACT MATERIAL: COPPER ALLOY  
SIGNAL PIN MATERIAL: COPPER ALLOY
- 3. PLATING:  
SEE ITEM 1 & 2 IN PRINT 10064183 FOR PLATING SPEC OF 51710-031, 51710-031LF RESPECTIVELY.

④ MANUFACTURER'S NAME, P/N, AND DATE CODE TO APPEAR ON THIS SURFACE.

5. PRODUCT SPECIFICATION GS-12-149.  
APPLICATION SPECIFICATION BUS-20-067.

6. PACKAGED IN TRAYS.

PCB NOTES:

- 7. ALL HOLE DIAMETERS ARE FINISHED HOLE SIZE.
- 8. MOUNTING HOLES, WHERE APPLICABLE, ARE UNPLATED.

⑨  $\varnothing 1.151 \pm 0.025$  DRILLED HOLES PLATED WITH 0.008 MIN SnPb OR Sn OVER .001 (.03) TO 0.08 Cu PLATING TO ACHIEVE  $\varnothing 1.02 \pm .07$  HOLE.

⑩ "DIM XXX" TO BE DETERMINED BY THE CUSTOMER.

⑪ CONNECTOR KEEP-OUT ZONE.

12. A  $\Delta$ SYMBOL WILL BE NEXT TO ANY DIMENSION, VIEW, OR NOTE WHICH HAS BEEN MODIFIED WITH THE CURRENT DRAWING REVISION.

mat'l code				tolerances unless otherwise specified		CUSTOMER		FCI	
ltr	ecm no.	dr	date	linear	angular	projection	copy	title	www.fciconnect.com
B				0.X ± 0.5	0.XX ± 0.25	0.XXX ± 0.1	COPY	2P + 16S + 2P VERTICAL SOLDER HEADER	
				0° ± 2°		MM	scale: 1:1	product family: PwrBlade	code: 213
		dr	JULIA WANG	08/14/08				size: A	sheet: 4 of 4
		engr	JEROME CHEN	08/14/08				dwg no: 51710-031	
		chr	GARY HSIEH	08/14/08					
		oppd	JOSEPH HSIA	08/14/08					
sheet index	revision sheet							cage code: 22526	