

## Excellent Integrated System Limited

Stocking Distributor

Click to view price, real time Inventory, Delivery & Lifecycle Information:

[FCI](#)  
[D09S33E6GX09LF](#)

For any questions, you can email us directly:  
[sales@integrated-circuit.com](mailto:sales@integrated-circuit.com)

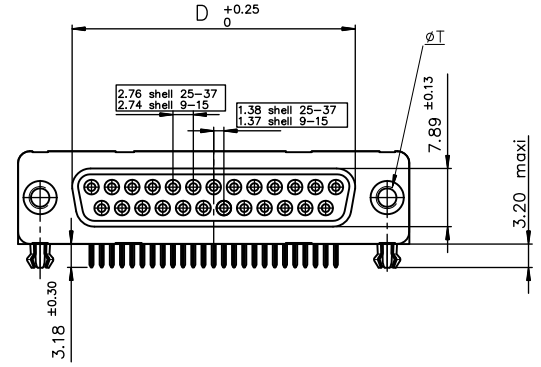
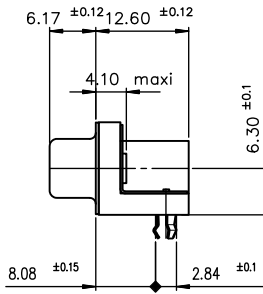
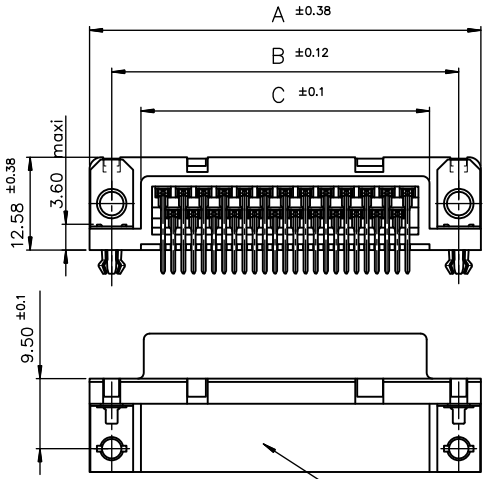

LEAD FREE PART NUMBER

SHELL	A±0.38	B±0.12	C±0.10	D±0.25	E±0.07	Flash Au Plating	0.76µ Au Plating
09	30.81	24.99	16.96	16.21	10.96	D09S33E4G*09LF	D09S33E6G*09LF
15	39.14	33.32	25.18	24.54	19.18	D15S33E4G*09LF	D15S33E6G*09LF
25	53.03	47.04	39.12	38.25	33.12	D25S33E4G*09LF	D25S33E6G*09LF

Part Number & Date Code Printing

L -->ØT=M.3  
X -->ØT=UNC 4-40

PC card drilling dimensions(after plating)  
(thickness 1.60±0.20mm)

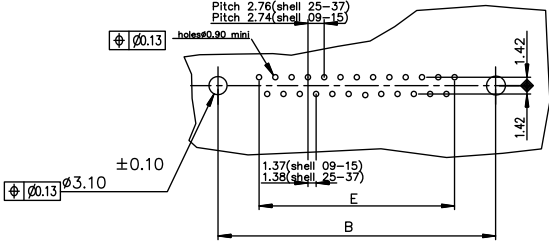

Technical characteristics:

Insulators: self-extinguishing thermoplastic, ULclass94V0, IR or reflow process compatible

Climatic characteristics:

Operating temperature range: -55°C +225°C

FOR ALL OTHER DETAILS REFER DWG.NO: C01-8646-0000

mat'l. code	surface	tolerance	projection	product family
	ISO 1302	ISO 416 ISO 1101		D-SUB
ltr	ecn no	dr	date	title
E	ELX-I-21461	AB	2015-07-22	DD RA SOCKET CONNECTOR
				HIGH TEMPERATURE INSULATOR
				dwg no
				C01-8646-0449
				sheet 1 of 1
				size
				A3
				type
				Product Customer Drawing
sheet index	revision	sheet	E	
		1		

PDS: Rev :E

STATUS:Released

Printed: Jul 22, 2015