

Excellent Integrated System Limited

Stocking Distributor

Click to view price, real time Inventory, Delivery & Lifecycle Information:

[FCI](#)

[10106127-8003002LF](#)

For any questions, you can email us directly:

sales@integrated-circuit.com

PART NUMBER 10106127-8003002LF

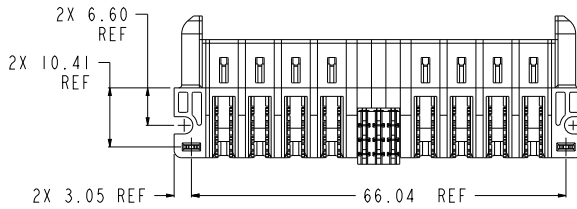
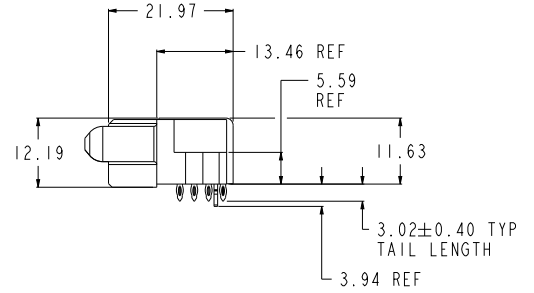
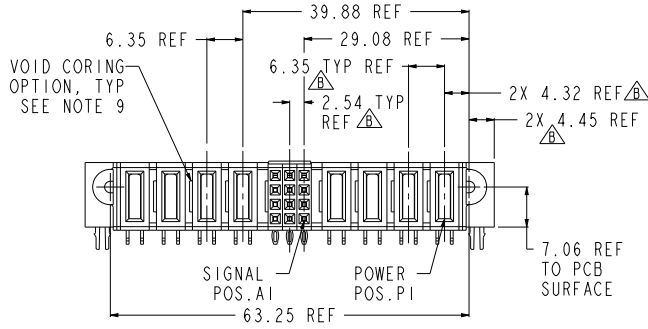
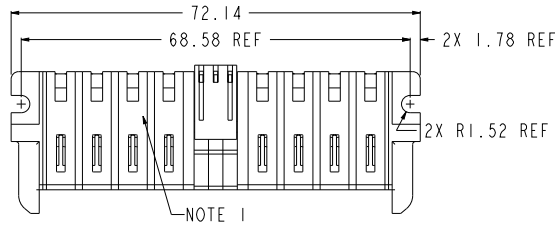

Copyright FCI

spec ref	#	dr	Peng-Bing Fu	20120909	projection	MM	size	A3	scale	2.000		
tolerance std	TOLERANCES UNLESS OTHERWISE SPECIFIED	eng	Peng-Bing Fu	20121014			ecn no	ELX-00-01944-1	rel level	Released		
surface	linear	0.X	±0.50	chr			Tian-Xu Huang	20121115	product family	-	rev	B
		0.XX	±0.25	appr			Pai-Ming Zhang	20121115				
	angular	0°	±2°			www.fci.com	title 4HP + 12S + 4HP RA PRESS-FIT RECEPTACLE	cat. no. 10106127-8003002	Product - Customer Drw	sheet 1 of 3		

Part File - REV C - 2009-04-09

1

2

3

PDS: Rev B

STATUS: Released

Printed: Nov 16, 2012

PRODUCT NUMBER

10106127-8003002LF

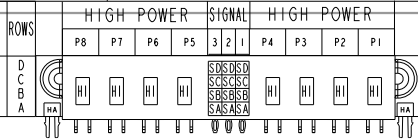

CODE	DESCRIPTION
HI	FMLB HIGH POWER CONTACT
SA	STD SIGNAL CONTACT, ROW A
SB	STD SIGNAL CONTACT, ROW B
SC	STD SIGNAL CONTACT, ROW C
SD	STD SIGNAL CONTACT, ROW D
HA	METAL HOLD DOWN

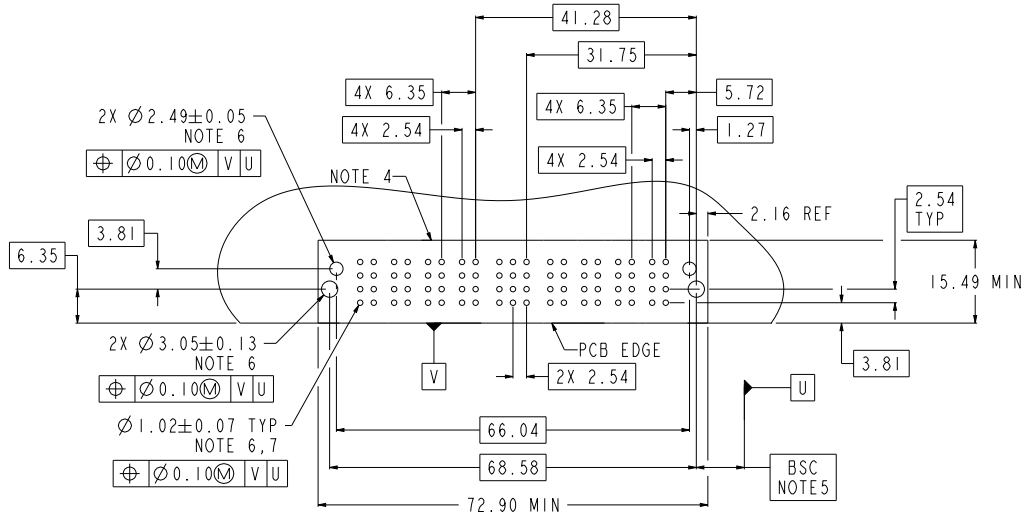

dr	Peng-Bing Fu	20120909	projection	MM	size	A3	scale	1:1.414
eng	Peng-Bing Fu	20121014			ecn no	-	rel level	Released
chr	Tian-Xu Huang	20121115						
appr	Pai-Ming Zhang	20121115	product family	-				
			title 4HP + 12S + 4HP RA PRESS-FIT RECEPTACLE		eng no 10106127-8003002		rev B	
www.fci.com			cat. no.		Product - Customer Draw		sheet 2 of 3	



Copyright © FCI.

NOTES:

- 1) "FCI", PART NUMBER AND DATE CODE TO BE MARKED IN AREA SHOWN. PART LENGTH UNDER 30MM SHOW DATE CODE ONLY.
- 2) MATERIALS:
 -HOUSING - GLASS FILLED WITH HIGH TEMP THERMOPLASTIC, UL94V-0.
 -SIGNAL CONTACT - COPPER ALLOY.
 -POWER CONTACT - HIGH CONDUCTIVITY COPPER ALLOY.
- 3) PLATING SPECIFICATION REFER TO FCI 10116351
- 4) DENOTES CONNECTOR KEEP OUT ZONE.
- 5) DATUM AND BASIC DIMENIONS WERE ESTABLISHED BY CUSTOMER.
- 6) ALL HOLE DIAMETERS ARE FINISHED HOLE SIZES.
- 7) 1.15±0.025MM DRILLED HOLE PLATED WITH 0.00762MM MIN Sn OVER 0.0254-0.0762MM Cu PLATING TO ACHIEVE A 1.02±0.07MM HOLE.
- 8) PRODUCT SPECIFICATION REFER TO FCI GS-12-658.
 APPLICATION SPECIFICATION REFER TO FCI GS-20-141.
 PRODUCT PACKAGED IN TRAYS, REFER TO FCI GS-14-1502.
- 9) THE VOID CORING IN BETWEEN POWER MODULES, SIGNAL MODULES AND END MODULES ARE OPTIONAL AND THE SHAPE MAY BE DIFFERENT FOR OPTIMIZE THE MOLDING PROCESS. THE VOID CORING WILL NOT EFFECT TO PRODUCT FUNCTION.
- 10) A SYMBOL WILL BE NEXT TO ANY DIMENSION,VIEW,OR NOTE WHICH HAS BEEN MODIFIED WITH THE CURRENT DRAWING REVISION.

dr	Peng-Bing Fu	20120909	projection	MM	size	A3	scale	1.000
eng	Peng-Bing Fu	20121014		←→	ecn no	ELX-06-01844-1		
chr	Tian-Xu Huang	20121115			rel level	Released		
appr	Pai-Ming Zhang	20121115	product family	-				
		title		4HP + 12S + 4HP		eng no		10106127-8003002
www.fci.com		cat. no.		-		Product - Customer Draw		sheet 3 of 3
		3		PDS: Rev.B		STATUS:Released		Printed: Nov 16, 2012



Copyright FCI.