

Excellent Integrated System Limited

Stocking Distributor

Click to view price, real time Inventory, Delivery & Lifecycle Information:

[FCI](#)

[10123973-004RLF](#)

For any questions, you can email us directly:

sales@integrated-circuit.com

PRODUCT NO.	
FCI	10123973-004RLF

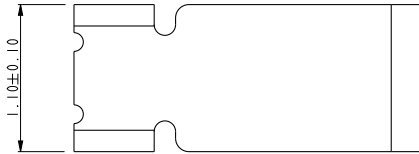
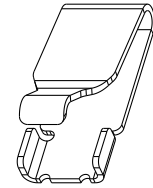
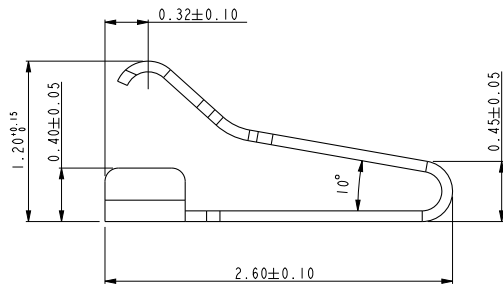

NOTES:

1. MATERIAL: STAINLESS STEEL.
2. CONTACT PLATING:
CONTACT AREA: PLATING 8 MICROINCH Au OVER Ni UNDERPLATE,
SOLDER AREA : PLATING GOLD FLASH OVER Ni UNDERPLATE.
3. PACKAGING: TAPE & REEL
4. PART NUMBER DESCRIPTION:
10123973-0 0 X X X

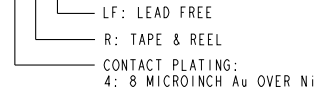

Copyright FCI.

spec ref	*	dr	Andy Lu	2013/04/17	projection	mm	size	A4	scale	25 : 1
tolerance std	ASME Y14.5	eng	Andy Lu	2013/04/19			ecn no	-	rel level	Released
TOLERANCES UNLESS OTHERWISE SPECIFIED		chr	Young Ou	2013/04/19			product family	-	rel level	Released
surface	linear	0.X	±0.3		FCI title UNIVERSAL CONTACT SMT SPRING www.fci.com	cat. no.	Product - Customer Drw	sheet 1 of 2	rev A	
ASME Y14.5	angular	0.XX	±0.15							
		0.XXX	±0.050							
0°	±2°									

Prod File - REV C - 2009-08-09

PDS: Rev :A

STATUS:Released

Printed: Apr 19, 2013

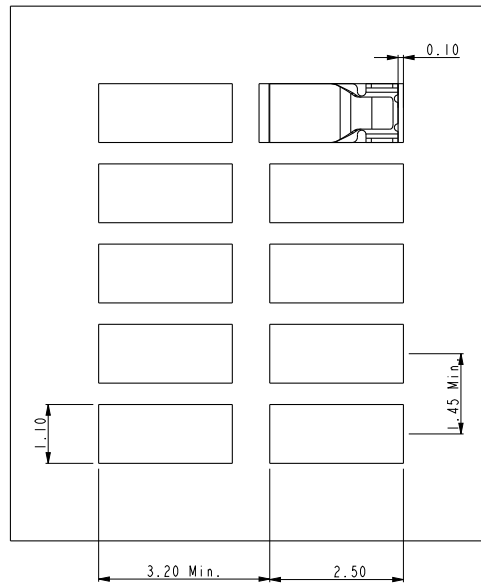

RECOMMENDED PCB DIMENSION & MIN PITCH
TOLERANCE: +/-0.05MM

spec ref	*	dr	Andy Lu	2013/04/17	projection	mm	size	A4	scale	10 : 1									
tolerance std	ASME Y14.5	eng	Andy Lu	2013/04/19			ecp no	-	rel level	Released									
TOLERANCES UNLESS OTHERWISE SPECIFIED		chr	Young Ou	2013/04/19			product family	-	rel level	Released									
surface		appr	Pei-Ming Zheng	2013/04/19			cat. no.	10123973	rev	A									
ASME Y14.5	<table border="1"> <tr> <td>linear</td> <td>0.X</td> <td>±0.3</td> </tr> <tr> <td></td> <td>0.XX</td> <td>±0.15</td> </tr> <tr> <td></td> <td>0.XXX</td> <td>±0.050</td> </tr> <tr> <td>angular</td> <td>0°</td> <td>±2°</td> </tr> </table>	linear	0.X	±0.3		0.XX	±0.15		0.XXX	±0.050	angular	0°	±2°	www.fci.com		UNIVERSAL CONTACT SMT SPRING		Product - Customer Drw	sheet 2 of 2
linear	0.X	±0.3																	
	0.XX	±0.15																	
	0.XXX	±0.050																	
angular	0°	±2°																	

Print File - REV C - 2009-08-09