

Excellent Integrated System Limited

Stocking Distributor

Click to view price, real time Inventory, Delivery & Lifecycle Information:

[FCI](#)
[10124034-406001CLF](#)

For any questions, you can email us directly:
sales@integrated-circuit.com

PART NUMBER
SEE TABLE

A

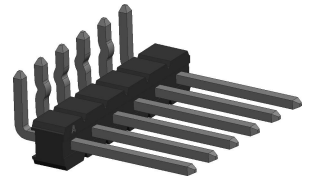
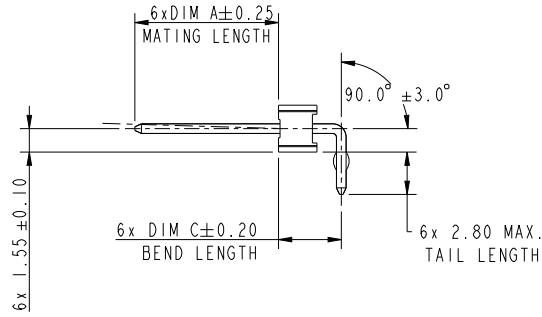
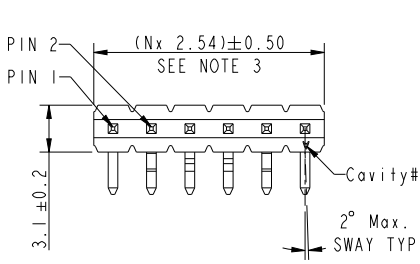

B

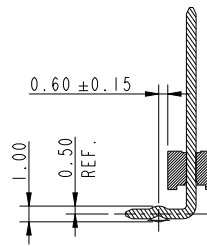
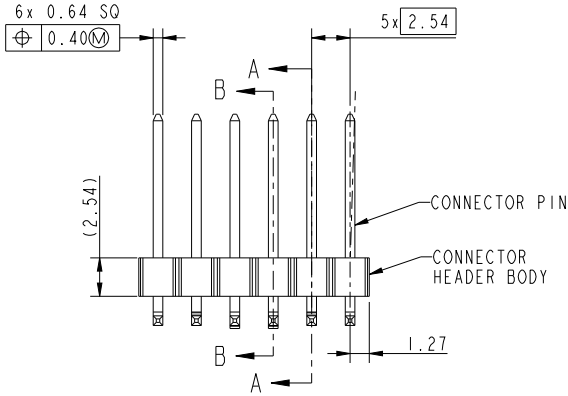

SECTION A-A
TYPICAL PIN 2 AND 5

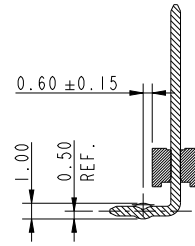

SECTION B-B
TYPICAL PIN 3 AND 4

C

D

spec ref	GS-14-050	dr	Brandon Ding	20130927	projection	MM	size	A3	scale	1:1
tolerance std	TOLERANCES UNLESS OTHERWISE SPECIFIED	eng	Zhang-Kun He	20131215			ecn no	ELX-N-1447-1	rel level Released	rev B
surface	linear	0.X	±0.3				title BERGSTIK HEADER 2.54mm PITCH, SR, R/A, SHELF-RET	eng no 10124034		
	angular	0°	±2°							

Print Date - REV C - 2009-04-09

1

2

3

PDS: Rev.B

STATUS:Released

Printed: Dec 19, 2013



Copyright FCI.

PART NUMBER	PLATING	MATING LENGTH	TAIL LENGTH	BEND LENGTH	RETENTION PIN POS.		PIN MATERIAL	STATUS
		DIM A	DIM B	DIM C	SECTION A-A	SECTION B-B		ACTIVE
10124034-406001LF	100u" MIN MATTE Sn OVER 50u" MIN Ni	9.5	2.80 MAX.	4.15	2, 5	3, 4	PHOSPHOR BRONZE	ACTIVE
10124034-406002LF	100u" MIN MATTE Sn OVER 50u" MIN Ni	9.5	2.80 MAX.	4.15	2, 5	3, 4	BRASS	NO TOOLED

NOTES

- MATERIAL:
CONNECTOR BODY:HIGH TEMPERATURE NYLON WITH 30% GLASS FIBER, FLAME RETARDENT PER UL-94V-0. COLOR:BLACK.
CONNECTOR PIN:COPPER ALLOY REFER TO ABOVE TABLE.
- FINISH: CONNECTOR PIN:SEE ABOVE PLATING CODE TABLE.
- PACKAGING:
PACKAGED IN POLY BAGS WITHOUT CAP(BLANK).
EIGHT DIGIT PART NUMBERS FOLLOWED BY A "C" ARE PACKAGED IN TAPE AND REEL WITHOUT PICKUP CAP.
- PRODUCT SPEC: BUS-12-050.
- TWO SIDES OF PIN TIPS NOT PLATED. TYPICAL BOTH ENDS.
- 2LBS/0.9KG MIN PIN RETENTION IN EITHER DIRECTION.
- 5LB/2.3KG MAX INSERTION FORCE AND .25LB/.1KG MIN RETENTION FORCE PER RETENTIVE PIN USING 1.00mm THICK CIRCUIT BOARDS AND RECOMMENDED HOLE PATTERN.
- PART WILL WITHSTAND EXPOSURE TO 260°C PEAK TEMPERATURE FOR 10 SECONDS IN WAVE SOLDER, INFRA-RED OR VAPOR PHASE SOLDER PROCESS

PRODUCT NUMBER CODES

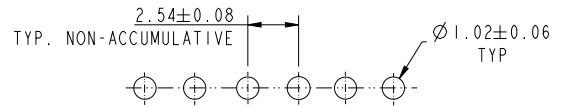
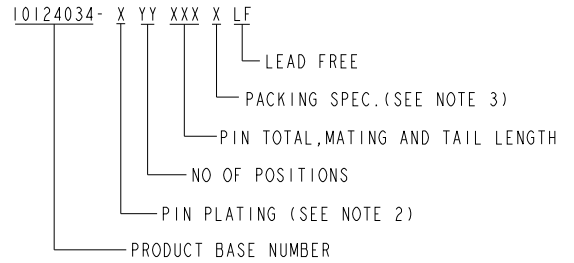

RECOMMENDED PCB LAYOUT PATTERN

spec ref	GS-14-050	dr	Brandon Ding	20120927	projection	MM	size	A3	scale	1:1										
tolerance std	TOLERANCES UNLESS OTHERWISE SPECIFIED	eng	Zhang-Kun He	20121216			ecn no	ELX-N-16477-1	rel level		Released									
surface	<table border="1"> <tr> <td>linear</td> <td>0.X</td> <td>±0.3</td> </tr> <tr> <td></td> <td>0.XX</td> <td>±0.13</td> </tr> <tr> <td></td> <td>0.XXX</td> <td>±0.051</td> </tr> </table>	linear	0.X	±0.3				0.XX	±0.13		0.XXX	±0.051	chr	-	product family	-	eng no	10124034	rev	B
		linear	0.X	±0.3																
	0.XX	±0.13																		
	0.XXX	±0.051																		
ISO 1302	angular	0°	±2°	appr	Rick Blum	20131216	www.fci.com	cat. no.	-	Product - Customer Drw	sheet 2 of 2									

