

SIGN	DATE	DESCRIPTION	APPROVER
△	2013.06.13	Rev change	SHIN
△	2013.06.27	Corrected dimensions	
△	2014.02.14	Revised tolerances and corrected layout	
<i>THIS IS CAD DRAWING, DO NOT REVISE MANUALLY!!!</i>			

Material

- Insulator: Glass filled Polyester
- Flammability: UL94V-0
- Contacts: Phosphor Bronze
- Contact Plating: See options
- Shell: Copper Alloy, 80u Ni over 50u Cu

Ratings

- Current: 1.5A
- Voltage: 30V AC(r.m.s.)
- Dielectric Withstanding Voltage: 500V AC at sea level
- Contact Resistance: $\lt; 30m\Omega$
- Insulation Resistance: >1,000 MΩ
- Operating Temperature: -55° ~ +85°
- Mating Force: 3.5Kg Max
- Umating Force: 1Kg. Min

RoHS Compliant

PART NUMBER:

USB-A1VSXX0

COLOR:
B: Black
W: White

PLATING:
6: Selective Au Flash/50u" Ni
8: Selective 30u" Au/50u" Ni (USB 2.0)

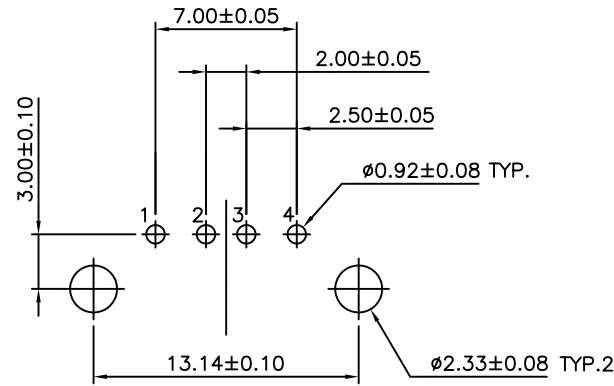
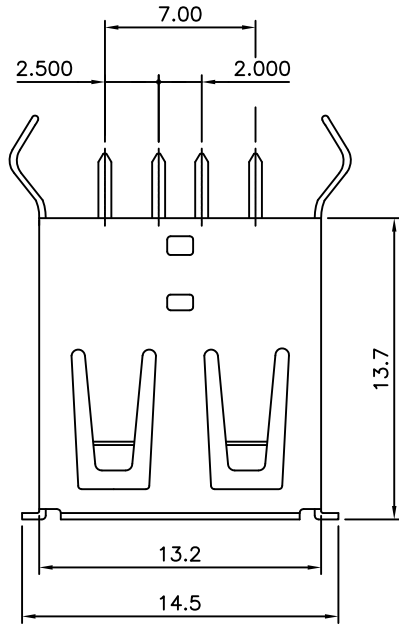

Recommended P.C. Board Layout

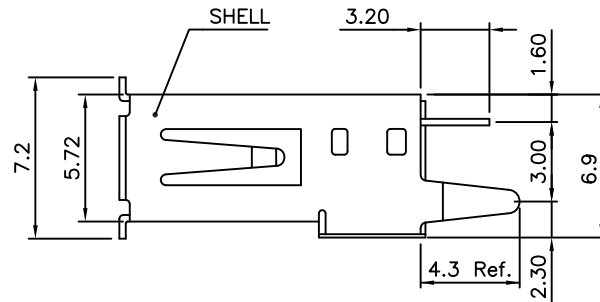
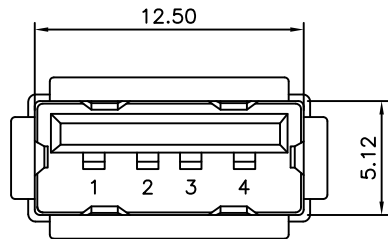

THESE DRAWINGS AND SPECIFICATIONS ARE THE PROPERTY OF ON-SHORE TECHNOLOGY, INC. AND SHALL NOT BE REPRODUCED, COPIED OR USED IN ANY MANNER WITHOUT THE PRIOR WRITTEN CONSENT OF ON-SHORE TECHNOLOGY, INC.



TITLE		USB - A type, Vertical, thru hole, single port, housing type 0			
PART NO.		USB-A1VSXX0		DWG NO. USB-A1VSXX0.DWG	
APPROVED		CHECKED	DESIGNED	DRAWN	1200
		Sandy 2012.30.04	Sandy 2012.30.04	Sandy 2012.30.04	Tolerance
				UNIT: mm	
				SCALE: NONE	
				REV.: C	
				X° ±1°	
				X.X ±0.30	
				X.XX ±0.25	
				X.XXX ±0.15	

SHEET: 01/01