

Excellent Integrated System Limited

Stocking Distributor

Click to view price, real time Inventory, Delivery & Lifecycle Information:

[Bivar, Inc.](#)
[LP-06 WE](#)

For any questions, you can email us directly:
sales@integrated-circuit.com

REV.	DESCRIPTION	DATE	APPROVED
F	Production Release	02/27/04	M. C.
G	Added Notes 4, 5, 6 & Color Options Sheet #2	05/16/16	J. C.

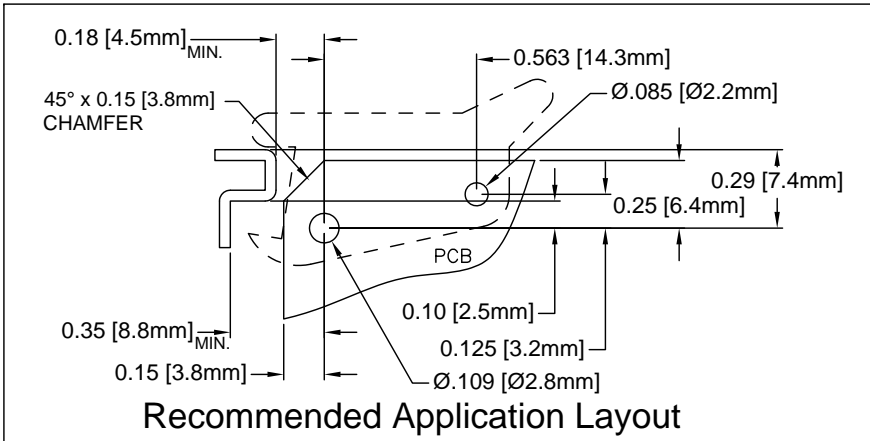
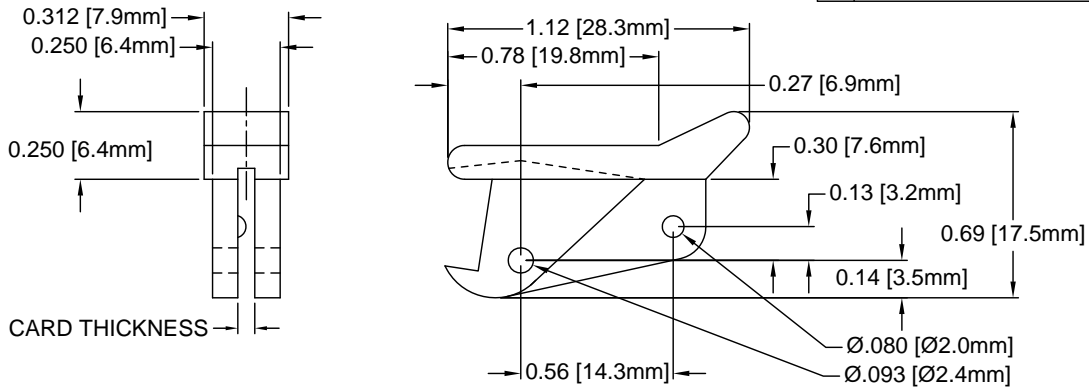

PART NO.	COLOR	ROLL PIN	CARD THICKNESS
LP-06 NT	NATURAL	RP-250	1/16"(1.6mm)
LP-06 WE	WHITE	RP-250	
LP-06 XX	SEE S.#2	RP-250	

5. PRE-ASSEMBLED ROLL PINS AVAILABLE UPON REQUEST.
4. ROLL PINS INCLUDED. PACKAGED SEPARATELY.
3. MATERIAL: NYLON 6/6, 94V-2, WHITE.
2. MATERIAL: NYLON 6/6, 94V-2, NATURAL.
1. GENERAL SPECIFICATIONS: BIVAR MOLDED COMPONENT SPECIFICATION BV00-E101.

STANDARD TOLERANCE (UNLESS OTHERWISE SPECIFIED)		BIVAR®	
DECIMALS	ANGULAR	4 THOMAS, IRVINE, CA. 92618	
.X ±.1	X° ±1°	TEL: (949) 951-8808 FAX: (949) 951-3974	
.XX ±.01		TITLE: CIRCUIT BOARD CARD EJECTOR	
.XXX ±.005		REVISION: G	
DESIGNED: S. Irving	DATE: 09/21/98	PART NO: LP-06	
CHECKED: R. Dienst	DATE: 04/06/00	CAGE CODE : 32559 SHEET # 1 OF 2	
CAD GENERATED DOCUMENT, DO NOT MEASURE DRAWING.			



OTHER AVAILABLE COLORS

* SEE TABLE FOR ORDERING INFORMATION

REV#	DESCRIPTION	DATE	APPROVED
	SEE SHEET #1		

<p>LP-06</p> <p>---</p>	<p>SERIES</p>	<p>ORDER CODE</p>	<p>COLOR</p>
		AA	AQUA
		BK	BLACK
		BE	BLUE
		BN	BROWN
		FG	FOREST GREEN
		GY	GRAY
		GN	GREEN
		LE	LIME
		OE	ORANGE
		PK	PINK
		RD	RED
		VT	VIOLET
		YW	YELLOW

6. PARTS ARE DYED TO COLOR UPON REQUEST.

STANDARD TOLERANCE (UNLESS OTHERWISE SPECIFIED)		<p>BIVAR[®] 4 THOMAS, IRVINE, CA. 92618 TEL: (949) 951-8808 FAX: (949) 951-3974</p>	
DECIMALS	ANGULAR		
		TITLE: CIRCUIT BOARD CARD EJECTOR	
		DESIGNED: S. Irving	DATE: 09/21/98
CHECKED: R. Dienst		DATE: 04/06/00	CAGE CODE : 32559 SHEET # 2 OF 2
CAD GENERATED DOCUMENT, DO NOT MEASURE DRAWING.			