

Excellent Integrated System Limited

Stocking Distributor

Click to view price, real time Inventory, Delivery & Lifecycle Information:

[Molex Connector Corporation](#)

[03-06-2242](#)

For any questions, you can email us directly:

sales@integrated-circuit.com

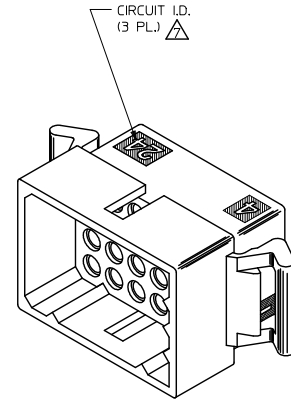
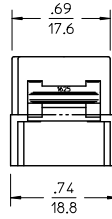
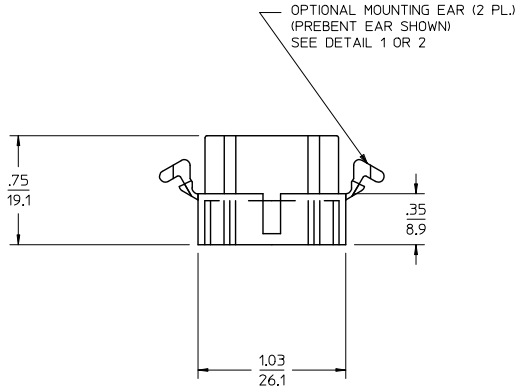
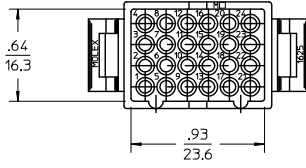

PLUG HOUSING

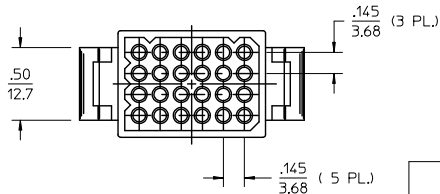

PK SPEC EC NO: UCP2015-0466 DRAWN BY: JDFOX CHKD BY: MKIPPER APPROVED BY: F SMITH	DESCRIPTION 2014/08/07 2014/08/07 2014/08/14	QUALITY SYMBOLS ▽=0 ▽=0 ▽=0	GENERAL TOLERANCES (UNLESS SPECIFIED)		DIMENSION STYLE		SCALE	DESIGN UNITS	THIRD ANGLE PROJECTION
			mm	INCH	IN/MM		2:1	INCH	☐
REV P1	DESCRIPTION	QUALITY SYMBOLS	4 PLACES	± ---	± ---	DRAWN BY	DATE	TITLE .062/(1,57) HOUSINGS PLUG AND RECEPTACLE 24 CIRCUIT molex	
			3 PLACES	± ---	± .010	JDFOX	2014/08/07		
			2 PLACES	± 0.25	± .014	CHECKED BY	DATE		
			1 PLACE	± 0.36	± ---	MKIPPER	2014/08/07		
0 PLACE	± ---	± ---	APPROVED BY	DATE	MATERIAL NO.		DOCUMENT NO.	SHEET NO.	
			ANGULAR	± 1/2°					
DRAFT WHERE APPLICABLE MUST REMAIN WITHIN DIMENSIONS			SEE CHART		SD-1625-24*		1 OF 3		
THIS DRAWING CONTAINS INFORMATION THAT IS PROPRIETARY TO MOLEX INCORPORATED AND SHOULD NOT BE USED WITHOUT WRITTEN PERMISSION									

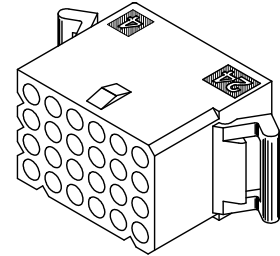
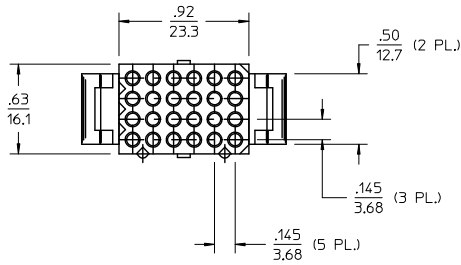
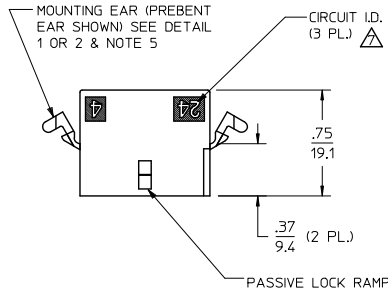
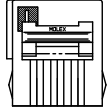
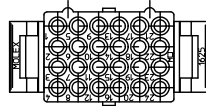

RECEPTACLE HOUSING

SEE SHEET 1 EC NO: UCP2015-0466 DRAWN: JDFOX 2014/08/07 CHECKED: MKIPPER 2014/08/07 APPROVED: F SMITH 2014/08/14 P1 REV	QUALITY SYMBOLS ∇=0 ∇=0 ∇=0	GENERAL TOLERANCES (UNLESS SPECIFIED)		DIMENSION STYLE IN/MM		SCALE 2:1	DESIGN UNITS INCH	THIRD ANGLE PROJECTION		
		4 PLACES ± --- ± ---	3 PLACES ± --- ± .010	DRAWN BY JDFOX	DATE 2014/08/07	TITLE .062/(1.57) HOUSINGS PLUG AND RECEPTACLE 24 CIRCUIT molex MATERIAL NO. SEE CHART DOCUMENT NO. SD-1625-24* SHEET NO. 2 OF 3				
		2 PLACES ± 0.25 ± .014	1 PLACE ± 0.36 ± ---	CHECKED BY MKIPPER	DATE 2014/08/07					
		0 PLACE ± --- ± ---	ANGULAR ± 1/2°	APPROVED BY F SMITH	DATE 2014/08/14					
DRAFT WHERE APPLICABLE MUST REMAIN WITHIN DIMENSIONS		SIZE C	THIS DRAWING CONTAINS INFORMATION THAT IS PROPRIETARY TO MOLEX INCORPORATED AND SHOULD NOT BE USED WITHOUT WRITTEN PERMISSION							

PLUG		RECEPTACLE	
PART NO.	ENG. NO.	PART NO.	ENG. NO.
03-06-2241	1625-24P	03-06-1241	1625-24R
03-06-2242	1625-24P1	03-06-6241	1625-24RBK
03-06-7241	1625-24PBK		
03-06-7242	1625-24PIBK		

LEGEND:

1625-24****

CIRCUIT SIZE

P = PLUG
R = RECEPTACLE

BLANK = WITH MOUNTING EARS
1 = WITHOUT EARS

COLOR:

BLANK = NATURAL COLOR
AM = AMBER BK = BLACK BU = BLUE
BN = BROWN GY = GRAY GN = GREEN
OR = ORANGE RD = RED YW = YELLOW

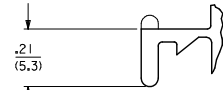

DETAIL 1

.062/(1.57) STANDARD MOUNTING EAR (SCALE 4:1)

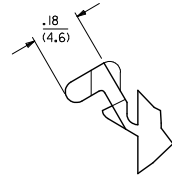
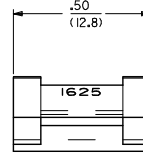

DETAIL 2

.062/(1.57) PREBEND MOUNTING EAR (SCALE 4:1)

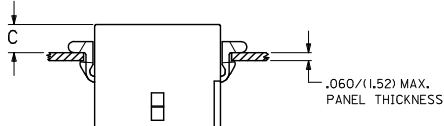

RECOMMENDED HOLE PATTERN

RECEP.	1.079 (27.41)	.715 (18.16)	.22 (5.5)	.22 (5.7)
PLUG	1.182 (30.02)	.765 (19.43)	.24 (6.0)	.24 (6.2)
PART	DIM. A	DIM. B	DIM. C (STANDARD EAR)	DIM. C (PREBEND EAR)

NOTES:

1. MATERIAL: NYLON TYPE 6/6, UL94V-2. COLOR: SEE LEGEND.
2. FINISH: NONE.
3. MOLEX PRODUCT SPEC PS-02-06 APPLIES.
4. PACKAGING SPECIFICATION: PK-1625-003.
5. WHERE DENOTED IN CHART, TOOLS ARE BUILT WITH PREBEND MOUNTING EARS PER DETAIL 2 AND SUPERSEDE ALL TOOLS PREVIOUSLY BUILT WITH THE STANDARD MOUNTING EAR.
6. THIS HOUSING FOR USE WITH .062/(1.57) DIA. TERMINALS.
7. CIRCUIT I.D. NUMBERS ON HOUSING APPEAR ON PART FROM TOOLS BUILT AFTER 8/5/91.
8. PARTS CONFORM TO CLASS B REQUIREMENTS OF COSMETIC SPECIFICATION PS-45499-002.

SEE SHEET 1 EC NO: UCP2015-0466 DRAWN BY: JDFOX 2014/08/07 CHECKED BY: CHKORRIPPER 2014/08/07 APPROVED BY: APRCSMITH 2014/08/14	QUALITY SYMBOLS 	GENERAL TOLERANCES (UNLESS SPECIFIED)		DIMENSION STYLE IN/MM		SCALE 2:1	DESIGN UNITS INCH	THIRD ANGLE PROJECTION	
			mm	INCH	DRAWN BY JDFOX	DATE 2014/08/07	.062/(1.57) HOUSINGS PLUG AND RECEPTACLE 24 CIRCUIT 		
		4 PLACES ±---	±---	CHECKED BY MKIPPER	DATE 2014/08/07				
		3 PLACES ±---	±.010	APPROVED BY FSMITH	DATE 2014/08/14				
2 PLACES ±0.25	±.014	MATERIAL NO.	DOCUMENT NO.						
1 PLACE ±0.36	±---	SEE CHART		SD-1625-24*		SHEET NO. 3 OF 3			
0 PLACE ±---	±---	DRAFT WHERE APPLICABLE MUST REMAIN WITHIN DIMENSIONS THIS DRAWING CONTAINS INFORMATION THAT IS PROPRIETARY TO MOLEX INCORPORATED AND SHOULD NOT BE USED WITHOUT WRITTEN PERMISSION							