

Excellent Integrated System Limited

Stocking Distributor

Click to view price, real time Inventory, Delivery & Lifecycle Information:

[Molex Connector Corporation](#)
[03-06-1152](#)

For any questions, you can email us directly:

sales@integrated-circuit.com

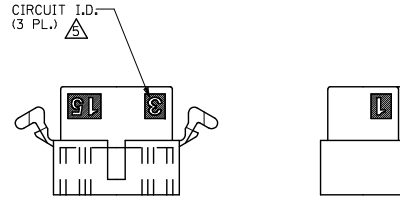
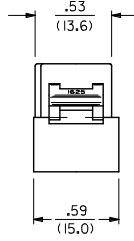
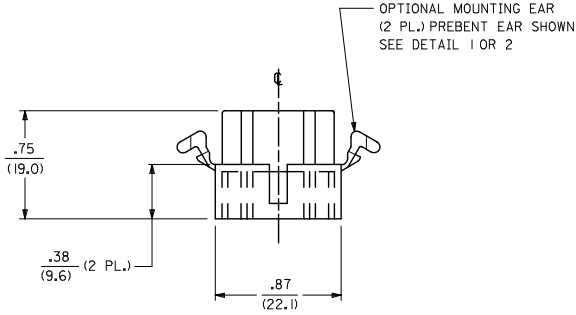
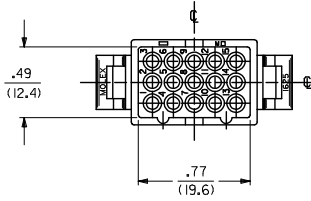

MTG. EAR NOT SHOWN FOR CKT. I.D. CLARITY

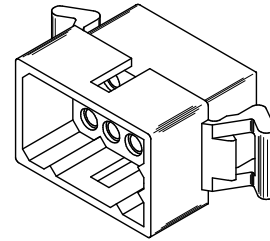

PLUG HOUSING

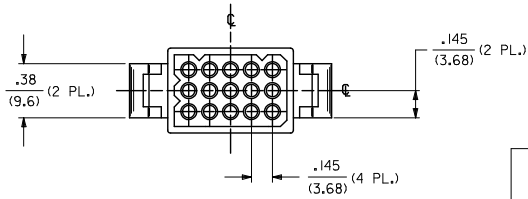

PK SPEC EC NO: UCP2015-0466 DRAWN BY: JDFOX 2014/08/05 CHECKED BY: MKIPPER 2014/08/05 APPROVED BY: F SMITH 2014/08/14 Q3 REV	QUALITY SYMBOLS ∇=0 ∇=0 ∇=0	GENERAL TOLERANCES (UNLESS SPECIFIED) 4 PLACES ± --- ± --- 3 PLACES ± --- ± .010 2 PLACES ± 0.25 ± .014 1 PLACE ± 0.35 ± --- 0 PLACE ± --- ± --- ANGULAR ± 1/2° DRAFT WHERE APPLICABLE MUST REMAIN WITHIN DIMENSIONS	DIMENSION STYLE IN/MM		DRAWN BY: JDFOX DATE: 2014/08/05	CHECKED BY: MKIPPER DATE: 2014/08/05	APPROVED BY: F SMITH DATE: 2014/08/14	SCALE: 2:1 DESIGN UNITS: INCH THIRD ANGLE PROJECTION	TITLE: .062 HOUSING, PLUG AND RECEPTACLE, 15 CIRCUIT, .145 CENTERS molex	MATERIAL NO. SEE CHART	DOCUMENT NO. SD-1625-15*	SHEET NO. 1 OF 3			
			THIS DRAWING CONTAINS INFORMATION THAT IS PROPRIETARY TO MOLEX INCORPORATED AND SHOULD NOT BE USED WITHOUT WRITTEN PERMISSION												

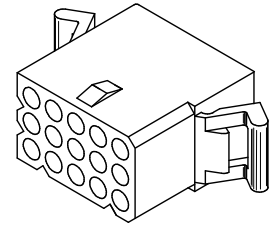
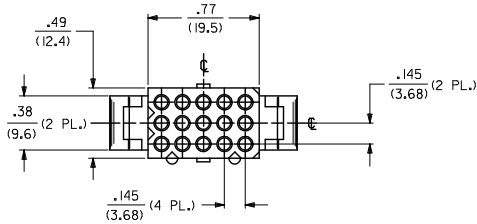
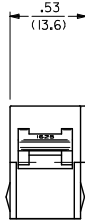
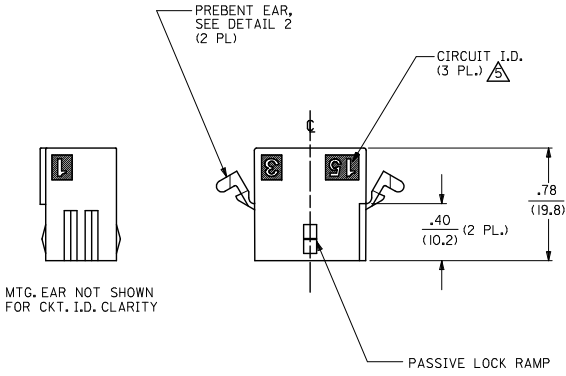
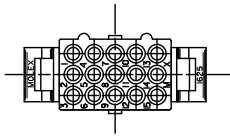

RECEPTACLE HOUSING

SEE SHEET 1 EC NO: UCP2015-0466 DRAWN BY: JDFOX 2014/08/05 CHECKED BY: MKIPPER 2014/08/05 APPROVED BY: F SMITH 2014/08/14 Q3 REV	QUALITY SYMBOLS ∇=0 ∇=0 ∇=0	GENERAL TOLERANCES (UNLESS SPECIFIED) mm INCH 4 PLACES ± --- ± --- 3 PLACES ± --- ± .010 2 PLACES ± 0.25 ± .014 1 PLACE ± 0.35 ± --- 0 PLACE ± --- ± ---	DIMENSION STYLE IN/MM	SCALE 2:1	DESIGN UNITS INCH	THIRD ANGLE PROJECTION
	DRAFT WHERE APPLICABLE MUST REMAIN WITHIN DIMENSIONS	ANGLULAR ±1/2° SEE CHART	MATERIAL NO. DOCUMENT NO. SD-1625-15*	TITLE .062 HOUSING, PLUG AND RECEPTACLE, 15 CIRCUIT, .145 CENTERS molex	SHEET NO. 2 OF 3	

PLUG		RECEPTACLE	
PART NO.	ENG. NO.	PART NO.	ENG. NO.
03-06-2151	1625-15P	03-06-1152	1625-15R1
03-06-7155	1625-15PBN	03-06-6152	1625-15R1BK
03-06-7152	1625-15P1BK	03-06-6155	1625-15R2
03-06-2152	1625-15P1	NOT TOOLED	1625-15R2BK
03-06-7151	1625-15PBK		
03-06-7153	1625-15PBN		
03-06-7154	1625-15PBU		

RECEPTACLE LEGEND:

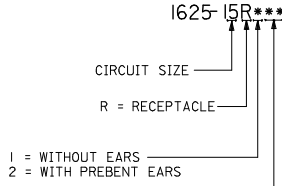

COLOR:
 BLANK = NATURAL COLOR
 AM = AMBER BK = BLACK BU = BLUE
 BN = BROWN GY = GRAY GN = GREEN
 OR = ORANGE RD = RED YW = YELLOW

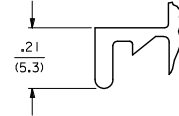

DETAIL 1

STANDARD MOUNTING EAR
SCALE 4:1

PLUG LEGEND:

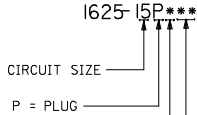

BLANK = WITH MOUNTING EARS
 1 = WITHOUT EARS

COLOR:
 BLANK = NATURAL COLOR
 AM = AMBER BK = BLACK BU = BLUE
 BN = BROWN GY = GRAY GN = GREEN
 OR = ORANGE RD = RED YW = YELLOW

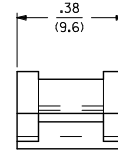
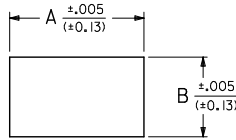
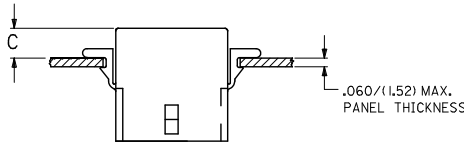

DETAIL 2

.062/(1.57)PREBENT MOUNTING EAR
(SCALE 4:1)

NOTES:

1. MATERIAL: NYLON TYPE 6/6, UL94V-2, COLOR: SEE LEGEND
2. FINISH: NONE
3. THIS PART COMPLIES WITH MOLEX PRODUCT SPEC, PS-02-06.
4. PACKAGING SPECIFICATION: PK-1625-003.
5. CIRCUIT I.D. NUMBERS ON HOUSING APPEAR ON PART FROM TOOLS BUILT AFTER 1/15/94.
6. THIS HOUSING FOR USE WITH .062/(1.57) DIA. TERMINALS.
7. WHERE DENOTED IN CHART, TOOLS ARE BUILT WITH PREBENT MOUNTING EARS PER DETAIL 2 AND SUPERSEDE ALL TOOLS PREVIOUSLY BUILT WITH THE STANDARD MOUNTING EARS.
8. PARTS CONFORM TO CLASS B REQUIREMENTS OF COSMETIC SPECIFICATION PS-45499-002.

RECOMMENDED HOLE PATTERN

RECEP.	.930 (23.62)	.569 (14.45)	.22 (5.6)
PLUG	.1032 (26.21)	.620 (15.75)	.21 (5.3)
PART	DIM. A	DIM. B	DIM. C (PREBENT EAR)

SEE SHEET 1 EC NO: UCP2015-0466 DRAWN BY: JDFOX 2014/08/05 CHECKED BY: CHKORAKIPER 2014/08/05 APPROVED BY: FSMITH 2014/08/14	QUALITY SYMBOLS ∇=0 ∇=0 ∇=0	GENERAL TOLERANCES (UNLESS SPECIFIED)		DIMENSION STYLE IN/MM		SCALE 2:1	DESIGN UNITS INCH	THIRD ANGLE PROJECTION	
		4 PLACES ± .010	3 PLACES ± .010	DRAWN BY: JDFOX	DATE: 2014/08/05	TITLE .062 HOUSING, PLUG AND RECEPTACLE, 15 CIRCUIT, .145 CENTERS molex MATERIAL NO. SD-1625-15* DOCUMENT NO. SHEET NO. 3 OF 3			
		2 PLACES ± 0.25 ± .014	1 PLACE ± 0.35 ± .014	CHECKED BY: MKIPPER	DATE: 2014/08/05				
		ANGULAR ± 1/2°		APPROVED BY: FSMITH	DATE: 2014/08/14				
DRAFT WHERE APPLICABLE MUST REMAIN WITHIN DIMENSIONS		SEE CHART							