

## Excellent Integrated System Limited

Stocking Distributor

Click to view price, real time Inventory, Delivery & Lifecycle Information:

[Molex Connector Corporation](#)

[03-06-1055](#)

For any questions, you can email us directly:

[sales@integrated-circuit.com](mailto:sales@integrated-circuit.com)

RECEPTACLE

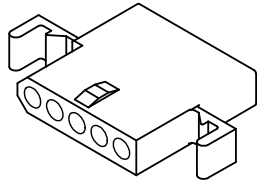
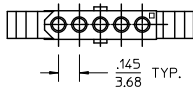
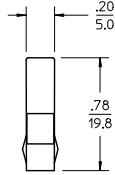
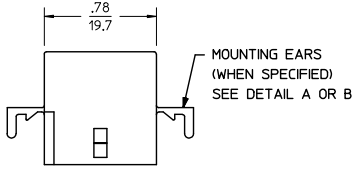
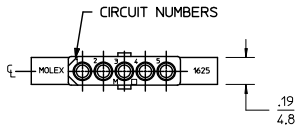

RECEPTACLE HOUSING  
SHOWN WITH STANDARD EARS

PLUG

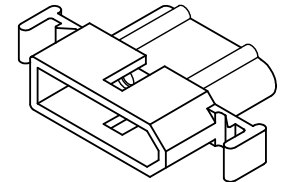
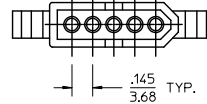
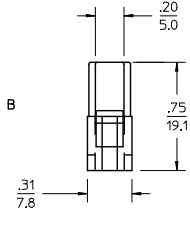
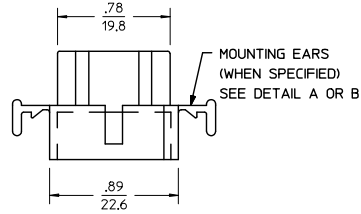
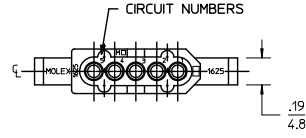

PLUG HOUSING  
SHOWN WITH STANDARD EARS

<b>PK SPEC</b> EC NO: UCP2015-0466 DRAWN: JDOX 2014/08/06 CHECKED: MKIPPER 2014/08/06 APPROVED: F SMITH 2014/08/14 F1 REV	QUALITY SYMBOLS ∇=0 ∇=0 ∇=0	GENERAL TOLERANCES (UNLESS SPECIFIED)		DIMENSION STYLE IN/MM		SCALE 2:1	DESIGN UNITS INCH	THIRD ANGLE PROJECTION
		4 PLACES ± --- ± ---	DRAWN BY JDOX DATE 2014/08/06	TITLE .062/(1.57) HOUSINGS PLUG & RECEPTACLE 5 CIRCUIT .145/(3.68)				
		3 PLACES ± --- ± .010	CHECKED BY MKIPPER DATE 2014/08/06					
		2 PLACES ± 0.25 ± .01	APPROVED BY F SMITH DATE 2014/08/14	MATERIAL NO.		DOCUMENT NO. SD-1625-5*	SHEET NO. 1 OF 2	
1 PLACE ± 0.35 ± ---		ANGULAR ±1/2°		DRAFT WHERE APPLICABLE MUST REMAIN WITHIN DIMENSIONS		SEE CHART		THIS DRAWING CONTAINS INFORMATION THAT IS PROPRIETARY TO MOLEX INCORPORATED AND SHOULD NOT BE USED WITHOUT WRITTEN PERMISSION
0 PLACE ± --- ± ---		SIZE C						

13 12 11 10 9 8 7 6 5 4 3 2 1

PLUG		RECEPTACLE	
PART NO.	ENG. NO.	PART NO.	ENG. NO.
03-06-2054	1625-5P	03-06-1055	1625-5R
03-06-2055	1625-5P1	03-06-1056	1625-5R1
03-06-7054	1625-5PBK	03-06-6055	1625-5RBK
03-06-7055	1625-5P1BK	NOT TOOLED	1625-5R2

LEGEND:

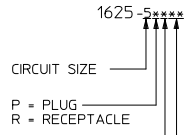

BLANK = WITH STANDARD EARS  
 1 = WITHOUT EARS  
 2 = WITH PREBENT EARS

COLOR:  
 BLANK = NATURAL COLOR  
 AM = AMBER BK = BLACK BU = BLUE  
 BN = BROWN GY = GRAY GN = GREEN  
 OR = ORANGE RD = RED YW = YELLOW

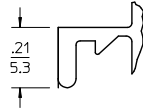
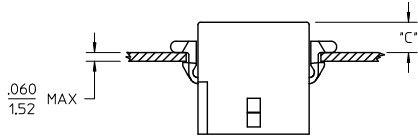

DETAIL A  
 .062/(1.57) STANDARD MOUNTING EAR  
 (SCALE 4:1)

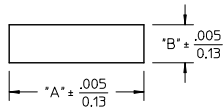

RECOMMENDED PANEL OPENING

HOUSING	DIM. "A"	DIM. "B"	"C" PREBENT EAR	"C" STANDARD EAR
PLUG	1.044/(26.52)	.318/(8.08)	.19/(4.8)	.18/(4.6)
RECEPT.	.940/(23.88)	.265/(6.73)	.21/(5.3)	.20/(5.1)



DETAIL B  
 .062/(1.57) PREBENT MOUNTING EAR  
 (SCALE 4:1)

NOTES:

1. MATERIAL: NYLON 6/6, UL94V-2. COLOR: SEE LEGEND.
2. FINISH: NONE.
3. MOLEX PRODUCT SPEC PS-02-06 APPLIES.
4. PACKAGING SPECIFICATION: PK-1625-003.
5. ACCEPTS MOLEX .062 SERIES TERMINALS.
6. PARTS CONFORM TO CLASS B REQUIREMENTS OF COSMETIC SPECIFICATION PS-45499-002.

SEE SHEET 1 EC NO: UCP2015-0466 DRAWN BY: JDFOX 2014/08/06 CHECKED BY: CHKORAKIPER 2014/08/06 APPROVED BY: F1 2014/08/14	QUALITY SYMBOLS 	GENERAL TOLERANCES (UNLESS SPECIFIED)		DIMENSION STYLE IN/MM		SCALE 2:1	DESIGN UNITS INCH	THIRD ANGLE PROJECTION																			
		<table border="1"> <tr> <th></th> <th>mm</th> <th>INCH</th> </tr> <tr> <td>4 PLACES</td> <td>±.005</td> <td>±.0004</td> </tr> <tr> <td>3 PLACES</td> <td>±.008</td> <td>±.0005</td> </tr> <tr> <td>2 PLACES</td> <td>±0.25</td> <td>±.01</td> </tr> <tr> <td>1 PLACE</td> <td>±0.35</td> <td>±.015</td> </tr> <tr> <td>0 PLACE</td> <td>±.000</td> <td>±.000</td> </tr> </table>			mm	INCH	4 PLACES	±.005	±.0004	3 PLACES	±.008	±.0005	2 PLACES	±0.25	±.01	1 PLACE	±0.35	±.015	0 PLACE	±.000	±.000	DRAWN BY: JDFOX DATE: 2014/08/06 CHECKED BY: MKIPPER DATE: 2014/08/06 APPROVED BY: FSMITH DATE: 2014/08/14		TITLE	.062/(1.57) HOUSINGS PLUG & RECEPTACLE 5 CIRCUIT .145/(3.68)		
			mm	INCH																							
		4 PLACES	±.005	±.0004																							
3 PLACES	±.008	±.0005																									
2 PLACES	±0.25	±.01																									
1 PLACE	±0.35	±.015																									
0 PLACE	±.000	±.000																									
ANGULAR ±1/2° DRAFT WHERE APPLICABLE MUST REMAIN WITHIN DIMENSIONS		MATERIAL NO. SEE CHART SIZE C		DOCUMENT NO.	SD-1625-5*																						
THIS DRAWING CONTAINS INFORMATION THAT IS PROPRIETARY TO MOLEX INCORPORATED AND SHOULD NOT BE USED WITHOUT WRITTEN PERMISSION																											

1b\_frame\_C\_P\_AM\_T Rev. G 2012/01/11 12 11 10 9 8 7 6 5 4 3 2 1