

Excellent Integrated System Limited

Stocking Distributor

Click to view price, real time Inventory, Delivery & Lifecycle Information:

[Molex Connector Corporation](#)
[0039291168](#)

For any questions, you can email us directly:

sales@integrated-circuit.com

NOTES:

- MATERIAL:
HOUSING MATERIAL: SEE CHART
TERMINAL MATERIAL: BRASS ALOY
- FINISH: SEE CHART
- PRODUCT SPECIFICATION: PS-5556-001
- PACKAGING SPECIFICATION: SEE CHART
BULK PACKED PER PK-5569-NA8 OR PK-5569-002
TRAY PACKED PER PK-5569-004, 39295083 IS TRAY PACKED
- MATES WITH 5557 SERIES MINIFIT JR RECEPTACLE
- DISCOLORATION IN THE BANDOLIER CARRIER AREA OF THE PIN IS INHERENT TO THE PLATING PROCESS AND IS DUE TO THE MASKING EFFECT OF THE CARRIER. THIS DISCOLORATION IS IN A NON-FUNCTIONAL AREA OF THE PIN AND WILL NOT AFFECT THE PERFORMANCE OF THE HEADER ASSEMBLY.
- PARTS ARE NOT DESIGNED FOR CURRENT SHARING.
- CONNECTORS ARE NOT TO BE MATED OR UNMATED WHILE CIRCUITS ARE LIVE.
- PART CONFORMS TO CLASS 'B' REQUIREMENTS OF COSMETIC SPECIFICATION PS-45499-002.
- FORMING MARKS ON PINS ARE ACCEPTABLE.

ENG. NO.	HEADER MATERIAL	FINISH OF PIN
5569-NA1	NYLON 66, UL94V-2, COLOR: NATURAL	
-NA1-210	NYLON 66, UL94V-0, COLOR: NATURAL	MATTE TIN 2.54 μ m MIN. OVER NICKEL 1.27 μ m MIN.
-NA1-400	NYLON 66, UL94V-0, COLOR: BLACK	
-NA1	NYLON 66, UL94V-2, COLOR: NATURAL	
-NA1-210	NYLON 66, UL94V-0, COLOR: NATURAL	GOLD 0.76 μ m MIN. AND TIN OVER 2.54 μ m MIN. OVER NICKEL 1.27 μ m MIN.
-NA1G-400	NYLON 66, UL94V-0, COLOR: BLACK	
-NA1G2	NYLON 66, UL94V-2, COLOR: NATURAL	
-NA1G2-210	NYLON 66, UL94V-0, COLOR: NATURAL	GOLD 0.38 μ m MIN. AND TIN OVER 2.54 μ m MIN. OVER NICKEL 1.27 μ m MIN.
-NA1G3	NYLON 66, UL94V-2, COLOR: NATURAL	
5569-NA1G3-210	NYLON 66, UL94V-0, COLOR: NATURAL	GOLD 1.27 μ m MIN. AND TIN OVER 2.54 μ m MIN. OVER NICKEL 1.27 μ m MIN.

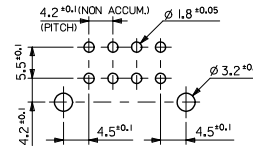
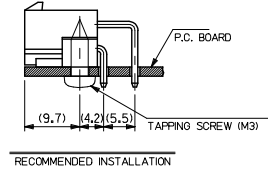
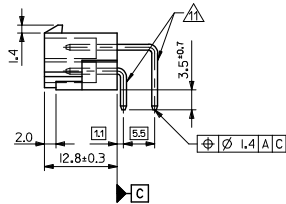
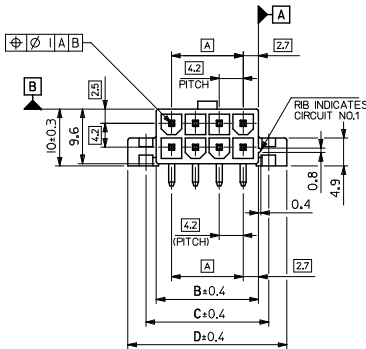
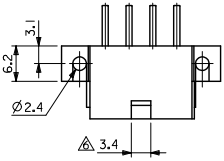

RECOMMENDED PCB HOLE LAYOUT VIEWED FROM COMPONENT SIDE 1.78 MAX. THICK P.C. BOARD

61.6	55.2	51.6	46.2	24
57.4	51	47.4	42	22
53.2	46.8	43.2	37.8	20
49	42.6	39	33.6	18
44.8	38.4	34.8	29.4	16
40.6	34.2	30.6	25.2	14
36.4	30	26.4	21	12
32.2	25.8	22.2	16.8	10
28	21.6	18	12.6	8
23.8	17.4	13.8	8.4	6
19.6	13.2	9.6	4.2	4
15.4	9	5.4	—	2
D	C	B	A	NO. OF CIRCUITS

ADD -400 P/NS EC NO: UCP2016-0308 DRAWN: JDOX 2015/07/24 CHKD: JBEI 2015/07/24 APPROV: SMTH 2015/07/30	QUALITY SYMBOLS ▽=0 ▽=0 ▽=0	GENERAL TOLERANCES (UNLESS SPECIFIED)	DIMENSION STYLE	SCALE	DESIGN UNITS	THIRD ANGLE PROJECTION
		mm INCH	MM ONLY	2:1	METRIC	THIRD ANGLE PROJECTION
M1	REV	4 PLACES ± --- ± ---	DRAWN BY H. HIRAMOTO	DATE '90/04/23	MINI FIT JR RIGHT ANGLE HEADER ASSY WITH FLANGES	
		3 PLACES ± --- ± ---	CHECKED BY M. FUKUSHIMA	DATE '91/07/04		
		2 PLACES ± 0.2 ± ---	APPROVED BY M. ENOMOTO	DATE '91/07/04		
		1 PLACE ± 0.2 ± ---	MATERIAL NO.	DOCUMENT NO.		
		0 PLACE ± --- ± ---	SEE CHART		SD-5569-002	1 OF 2
		ANGULAR ± 3°	THIS DRAWING CONTAINS INFORMATION THAT IS PROPRIETARY TO MOLEX INCORPORATED AND SHOULD NOT BE USED WITHOUT WRITTEN PERMISSION			

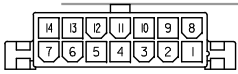

14 CKTS.

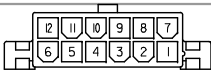

12 CKTS.

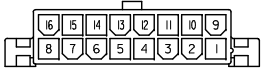

16 CKTS.

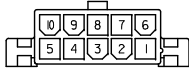

10 CKTS.

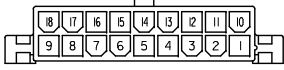

18 CKTS.

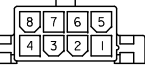

8 CKTS.

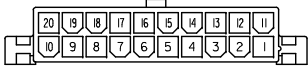

20 CKTS.

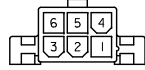

6 CKTS.

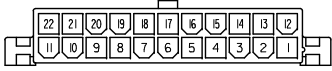

22 CKTS.

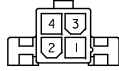

4 CKTS.

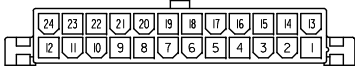

24 CKTS.

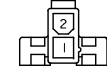

2 CKTS.

CIRCUIT SIZE LAYOUT (SCALE 2:1)

BULK PACKED				
EDP NO.	ENG. NO.	EDP NO.	ENG. NO.	CIRCUIT SIZE
39-29-4249	5569-24AG1-210	39-29-1247	5569-24A1-210	24
-4229	-22AG1-210	-1227	-22A1-210	22
-4189	-18AG1-210	-1187	-18A1-210	18
-4169	-16AG1-210	-1167	-16A1-210	16
-4149	-14AG1-210	-1147	-14A1-210	14
-4129	-12AG1-210	-1127	-12A1-210	12
-4109	-10AG1-210	-1107	-10A1-210	10
-4089	-08AG1-210	-1087	-08A1-210	8
-4069	-06AG1-210	-1067	-06A1-210	6
-4049	-04AG1-210	-1047	-04A1-210	4
39-29-4029	5569-02AG1-210	39-29-1027	5569-02A1-210	2
5569-NAG1-210				
39-29-5243	5569-24AG1	39-29-1248	5569-24A1	24
-5223	-22AG1	-1228	-22A1	22
-5203	-20AG1	-1208	-20A1	20
-5183	-18AG1	-1188	-18A1	18
-5163	-16AG1	-1168	-16A1	16
-5143	-14AG1	-1148	-14A1	14
-5123	-12AG1	-1128	-12A1	12
-5103	-10AG1	-1108	-10A1	10
-5083	-08AG1	-1088	-08A1	8
-5063	-06AG1	-1068	-06A1	6
-5043	-04AG1	-1048	-04A1	4
39-29-5023	5569-02AG1	39-29-1028	5569-02A1	2
5569-NAG1				
5569-NA1				

TRAY PACKED				
EDP NO.	ENG. NO.	EDP NO.	ENG. NO.	CIRCUIT SIZE
46999-0791	5569-24A1G-400	46999-0779	5569-24A1-400	24
-0790	-22A1G-400	-0778	-22A1-400	22
-0789	-20A1G-400	-0777	-20A1-400	20
-0788	-18A1G-400	-0776	-18A1-400	18
-0787	-16A1G-400	-0775	-16A1-400	16
-0786	-14A1G-400	-0774	-14A1-400	14
-0785	-12A1G-400	-0773	-12A1-400	12
-0784	-10A1G-400	-0772	-10A1-400	10
-0783	-08A1G-400	-0771	-08A1-400	8
-0782	-06A1G-400	-0770	-06A1-400	6
-0781	-04A1G-400	-0769	-04A1-400	4
46999-0780	5569-02A1G-400	46999-0768	5569-02A1-400	2
5569-NA1G-400				
5569-NA1-400				
5569-NA1GCS3				
5569-NA1GCS2-210				