

Excellent Integrated System Limited

Stocking Distributor

Click to view price, real time Inventory, Delivery & Lifecycle Information:

[Panasonic - BSG](#)
[P-120SCRJ/FTF3](#)

For any questions, you can email us directly:

sales@integrated-circuit.com

NICKEL CADMIUM BATTERIES: INDIVIDUAL DATA SHEET

P-120SCJS 4/5SC size (KR23/34) Type: R

Dimensions (with tube) (mm)

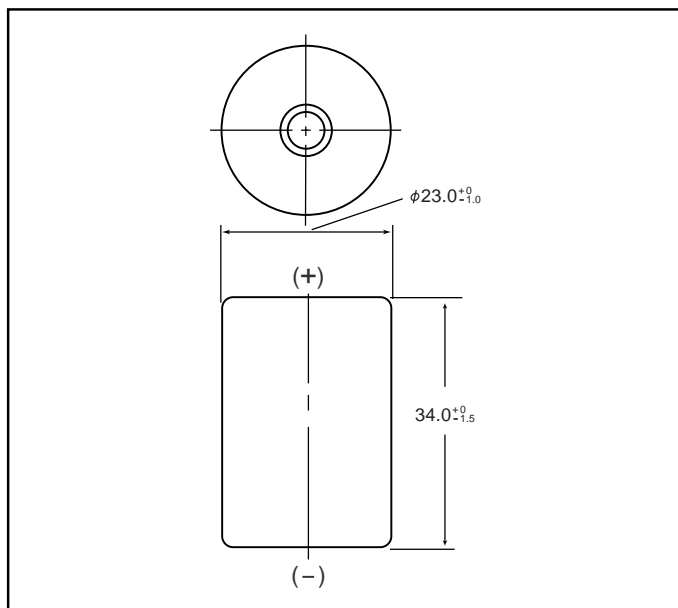

Specifications

	mm	inch
Diameter	23.0 +0/-1.0	0.89 +0/-0.02
Height	34.0 +0/-1.5	1.34 +0/-0.06
Approximate Weight	Grams	Ounces
	37g	1.31

Nominal Voltage		1.2V	
Discharge Capacity*	Average**	1300mAh	
	Rated (Min.)	1200mAh	
Approx. Internal impedance at 1000Hz at charged state		6mΩ	
Charge	Standard	120mA (0.1It) x 16 hrs.	
	Rapid***	1200mA (1It) x 1.5 hrs.	
Ambient Temperature	Charge	Standard	°C
			°F
	Rapid		°C
			°F
	Discharge		°C
	Storage	< 2 years	°C
		< 6 months	°C
		< 1 month	°C
		< 1 week	°C

* 0.2It discharge capacity after charging at 0.1It for 16 hours.

** For reference only.

*** Refer to "Charge Methods for Ni-Cd Batteries"

Battery performance and cycle life are strongly affected by how they are used. In order to maximize battery safety, please consult Panasonic when determining charge / discharge specs, warning label contents and unit design.

Note: [It] was previously expressed as [C]. [It] is an IEC standard expression for the amount of charge or discharge current and is expressed as:

It(A) = Cn (Ah)/1h.

- [It] is the reference test current in amperes
- [Cn] is the rated capacity of the cell or battery in Ampere-hours.
n = the time base [hours] for which the rated capacity is declared

Typical Charge Characteristics

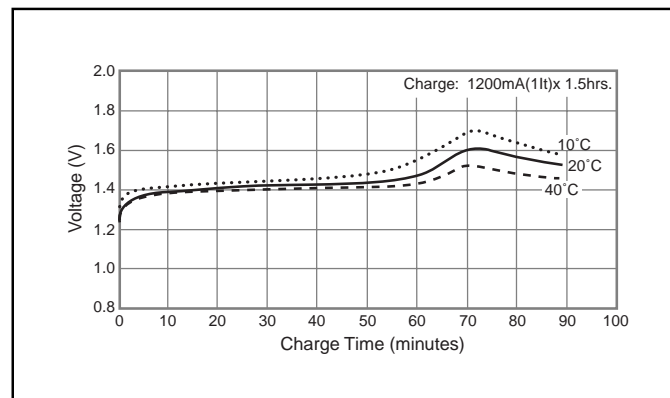

Typical Discharge Characteristics

