

Excellent Integrated System Limited

Stocking Distributor

Click to view price, real time Inventory, Delivery & Lifecycle Information:

[Pomona Electronics](#)
[3265](#)

For any questions, you can email us directly:

sales@integrated-circuit.com



Model 3265 & 3266
Standard Banana Plug with
#6-32 or #8-32 Screw **CE**

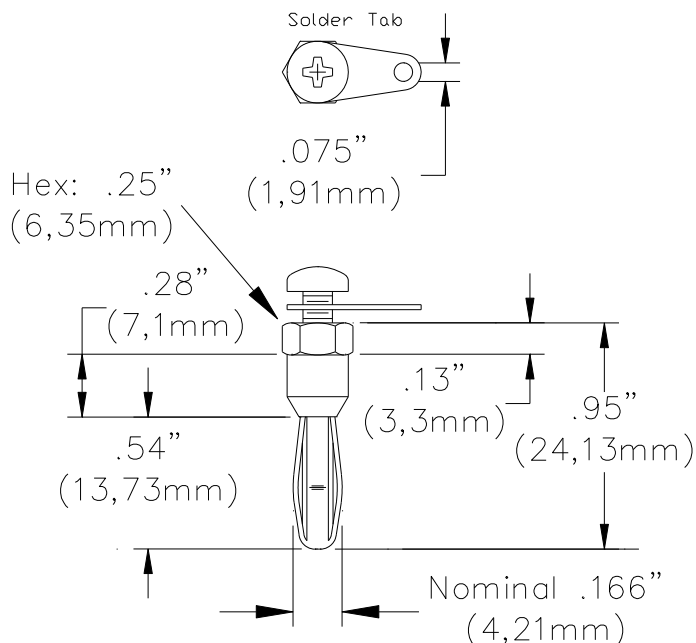

FEATURES:

- ✓ Fits standard banana jack

MATERIALS:

- Banana Plug Body: Brass, Alloy 360, 1/2 Hard
- Spring: Beryllium Copper, Berylco 25, Cond. H.T.
- Finish: Nickel plated per QQ-N-290, Class 2, 200/300 microinches
- Screw: Model 3265 - 6-32 x .25" (6,35mm) Pan head, Phillips, steel, nickel plated
Model 3266 - 8-32 x .25" (6,35mm) Pan head, Phillips, steel, nickel plated.
- Solder Lug: Copper per QQ-C-576
- Finish: Electro tin plated

RATINGS:

- Voltage: Hands free testing in controlled voltage environments: 500 Vrms Max. For CE compliance: not intended for hand-held use at voltages above 33 Vrms/70 Vdc.
- Current: 15 Amps

ORDERING INFORMATION:

- Model with 6-32 screw: 3265
- Model with 8-32 screw: 3266
- Sold in package of 10

All dimensions are in inches. Tolerances (except noted): .xx = ±.02" (.51 mm), .xxx = ±.005" (.127 mm).
All specifications are to the latest revisions. Specifications are subject to change without notice.
Registered trademarks are the property of their respective companies.