



**Distributor of Pomona Electronics: Excellent Integrated System Limited**

Datasheet of 5688/POM - PROBE TIP .080" BRASS 10/PKG

Contact us: [sales@integrated-circuit.com](mailto:sales@integrated-circuit.com) Website: [www.integrated-circuit.com](http://www.integrated-circuit.com)

---

## **Excellent Integrated System Limited**

Stocking Distributor

Click to view price, real time Inventory, Delivery & Lifecycle Information:

[Pomona Electronics](#)  
[5688/POM](#)

For any questions, you can email us directly:

[sales@integrated-circuit.com](mailto:sales@integrated-circuit.com)

Pomona®

**Model 5688  
 Probe Tip, Brass Plated  
 Replacement**

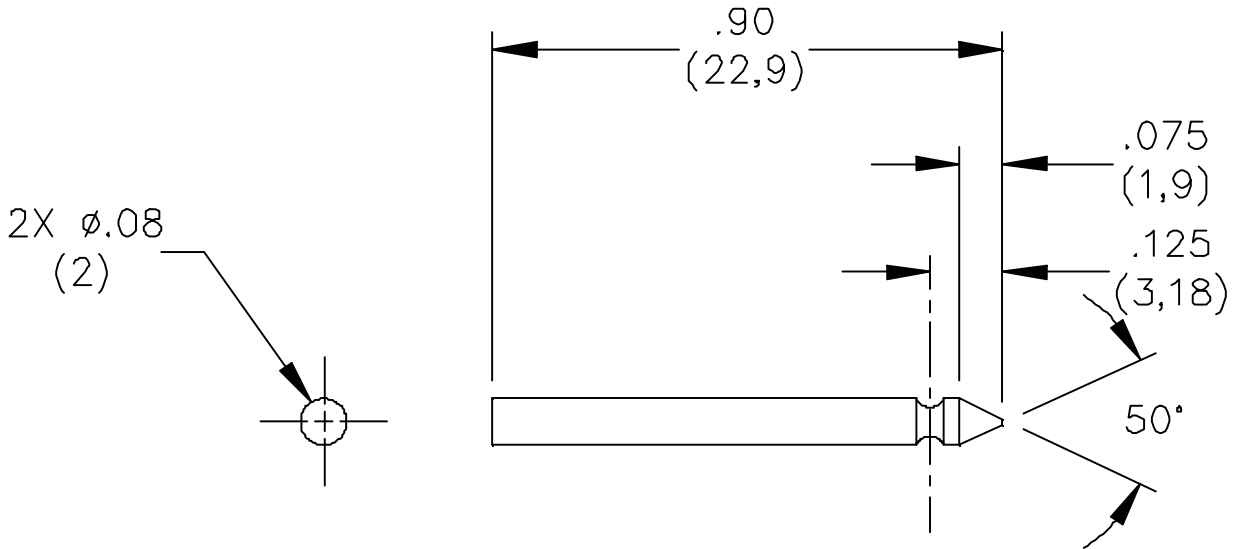

**FEATURES:**

- Used on Model Numbers 5676, 5677A
- Grooved tip to help maintain positive contact on test points
- Plugs into pin tip test jacks; example Pomona Model #3542

**MATERIALS:**

Body: Nickel Plated Brass

**ORDERING INFORMATION: Model 5688**

Parts are packaged 10 per bag

All dimensions are in inches. Tolerances (except noted): .xx = ±.02" (.51 mm), .xxx = ± .005" (.127 mm).  
 All specifications are to the latest revisions. Specifications are subject to change without notice.  
 Registered trademarks are the property of their respective companies.

Made in USA