



Distributor of Pomona Electronics: Excellent Integrated System Limited

Datasheet of 6371 - PROBE TEMP 12IN EXTENDED LENGTH

Contact us: sales@integrated-circuit.com Website: www.integrated-circuit.com

Excellent Integrated System Limited

Stocking Distributor

Click to view price, real time Inventory, Delivery & Lifecycle Information:

[Pomona Electronics](#)
[6371](#)

For any questions, you can email us directly:

sales@integrated-circuit.com

Pomona[®]

**Model 6371, 6543
 Extended Length Temperature
 Probe**

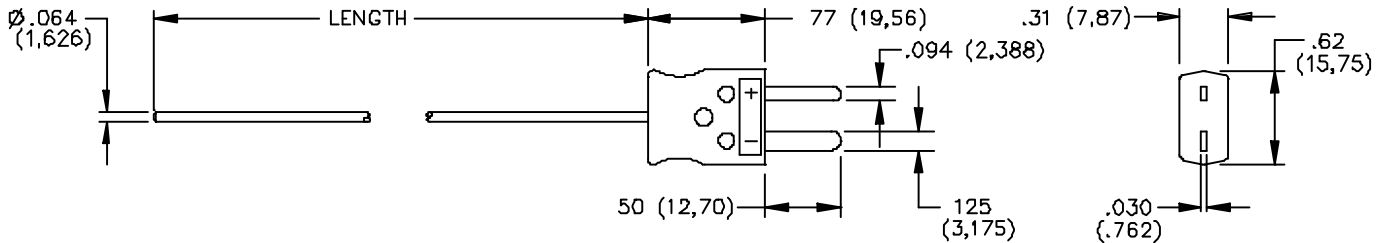

Model Number	Length	Calibration	Color
6371	12"	K	Yellow
6543	12"	J	Black

FEATURES:

- Small diameter for application where space is not available
- Use with extension cable 6379 & 6539
- Extended temperature measurement range

MATERIALS:

Connector Plug: Hytrel 4776. (See table for colors).

RATINGS:

Temperature Range: -40 to 2000°F. (-40 to 1093°C.)

Accuracy: $\pm 4^\circ\text{F}$. ($\pm 2.2^\circ\text{C}$.) or 0.75% whichever is greater.

Probe Length: 12 inches, probe diameter .064 inches.

ORDERING INFORMATION: Model 6371, 6543

NOTE: For use in low voltage environments. Do not exceed 30VAC/60VDC.

All dimensions are in inches. Tolerances (except noted): .xx = $\pm .02$ " (.51 mm), .xxx = $\pm .005$ " (.127 mm).
 All specifications are to the latest revisions. Specifications are subject to change without notice.
 Registered trademarks are the property of their respective companies. Made in USA