

Excellent Integrated System Limited

Stocking Distributor

Click to view price, real time Inventory, Delivery & Lifecycle Information:

[Pomona Electronics](#)
[6536](#)

For any questions, you can email us directly:

sales@integrated-circuit.com

Pomona®

Model 6378, 6536, 6537, 6538 Temperature Probe With Thermocouple Bead Tip

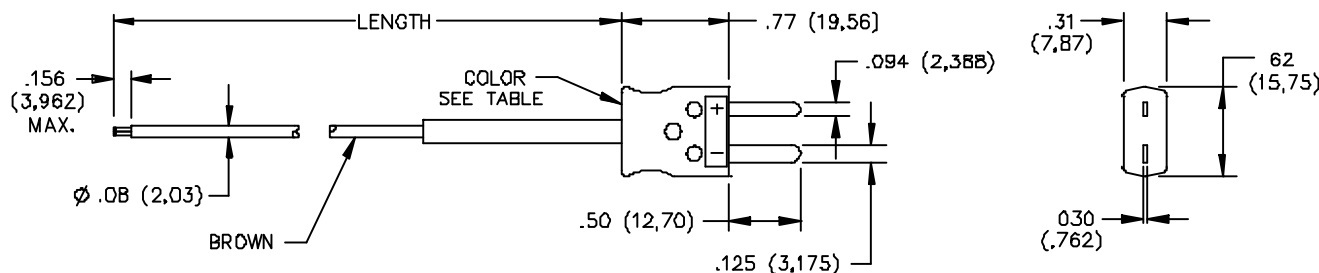

Model Number	Length	Calibration	Color
6378	48"	K	Yellow
6536	48"	J	Black
6537	48"	T	Blue
6538	48"	E	Violet

FEATURES:

- Compatible with all temperature measuring instruments that accept Thermocouples and have a miniature connector input.
- The bead junction provides the best possible response time.
- For measurement of air or surface temperature (not recommended for liquids).
- Available in "J", "K", "E", & "T" calibrations.

MATERIALS:

Thermocouple: See Table

Cable: Perfluoroalkyl, AWG 24.

Sheath: Stainless Steel, 309.

Connector Plug: Hytrel 4776. (See Table for Color)

RATINGS:

Temperature Range: -40 to 500°F. (-40 to 260°C.)

ORDERING INFORMATION: Model 6378, 6536, 6537, 6538

Note: For use in low voltage environments. Do not exceed 30VAC/60VDC.

All dimensions are in inches. Tolerances (except noted): .xx = ±.02" (.51 mm), .xxx = ±.005" (.127 mm).

All specifications are to the latest revisions. Specifications are subject to change without notice.

Registered trademarks are the property of their respective companies. Made in USA

Sales: 800-490-2361 Fax: 888-403-3360
 Technical Assistance: 800-241-2060

PomonaACCESS 90745 (800) 444-6785 or (425) 446-6010
 More drawings available at www.pomonaelectronics.com