

Excellent Integrated System Limited

Stocking Distributor

Click to view price, real time Inventory, Delivery & Lifecycle Information:

[FCI](#)
[86551009TLF](#)

For any questions, you can email us directly:
sales@integrated-circuit.com

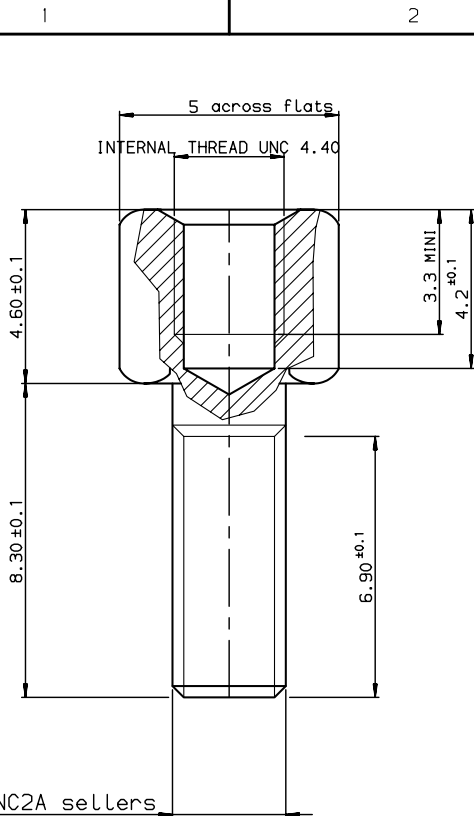

TECHNICAL CHARACTERISTICS :
 Female screw Locks: brass
 Packaging : per 1000 pieces .

86551009TLF	NOTE 1
LEAD FREE PART NUMBER	RoHS NOTE

NOTE 1 . RoHS INFORMATIONS

- The "LF" product meets European union Directives and other country regulations as described in 65-22-008.
- The product is not intended to be exposed to a manufacturing solder process.
- Plating: Sn pure bright over Copper.
- Packaging spec: see 65-14-920.

4.40NC2A sellers

Copyright FCI

www.fciconnect.com				surface ISO 1302	tolerance std ISO 406 ISO 1101	projection 	mm
TOLERANCES UNLESS OTHERWISE SPECIFIED				ANGULAR	LINEAR	size A3	Scale 10
Dr	GOISNARD	2006/01/12	0.X	±0.1	ECN	L509-0006	
Eng	PESSON	2006/01/12	0.XX	±0.1	Product family	D-SUB	Spec ref -
Chr	LEGARE	2006/01/12	0.XXX	±0.1			
Appr	LEGARE	2006/01/12					
rev	ecm no	dr	date				
A	L505-0123	LGO	2006/01/12				
B	L506-0055	LGO	2006/06/24				
C	L509-0006	PCR	2009/01/08				
-	-	-	-				
-	-	-	-				
-	-	-	-				
-	-	-	-				
				FEMALE SCREW LOCKS D SUB ACCESSORIES		C01-8655-1659 Rev. C	catalog no - CUSTOMER sheet 1 of 1

REV F - 2006-04-17